

U.S. Department
of Transportation

Alaskan Region Airports Division

222 W. 7th Avenue, Box 14
Anchorage, Alaska 99513-7587
Tel. (907) 271-5438
Fax (907) 271-2851

**Federal Aviation
Administration**

July, 10, 2015

Wolfgang Junge, P.E.
Design Section Chief
Central Region Department of Transportation and
Public Facilities, State of Alaska
P.O. Box 196900
Anchorage, AK 99519-6900

Dear Mr. Junge:

**Akutan Airport, Akutan, Alaska
Revised Airport Layout Plan (9/2014)**

We have completed our review of the Akutan Airport Layout Plan (ALP) Sheets 1, 2, 3, and 9, dated July 2015 and find it acceptable for documenting non-aeronautical use of the access road, and the location of the structures on the airport apron. Please add the enclosed signed sheet(s) to the existing ALP drawing set approved on May 16, 2012, adding to the electronic copy as well.

This ALP approval is conditioned on acknowledgement that any future development on airport property requiring Federal environmental approval must receive such written approval from FAA prior to the subject development. This ALP approval is also conditioned on acceptance of the plan under local land use laws. We encourage appropriate agencies to adopt land use and height restrictive zoning based on the plan.

Approval of the plan does not indicate that the United States will participate in the cost of any development proposed. AIP funding requires evidence of eligibility and justification at the time a funding request is ripe for consideration. When construction of any proposed structure or development indicated on the plan is undertaken, such construction requires normal 45-day advance notification to FAA for review in accordance with applicable Federal Aviation Regulations (i.e., Parts 77, 157, 152, etc.). More notice is generally beneficial to ensure that all statutory, regulatory, technical and operational issues can be addressed in a timely manner.

Please attach this letter to the enclosed ALP and retain it in your files for future use

Sincerely,



Pat Oien, P.E.
Lead Planner, Airports Division

Date Plotted: 4/29/2012
 Layout Name: SHEET 1
 File Name: \\Vandenberg\PROJECTS\2010\101032 Akutan Airport DB\Drawings\Airport Layout Plan (ALP)\Akutan-ALP-Sheet_01.dwg
 Designed By: DTK
 Drawn By: BK
 Checked By: DTK

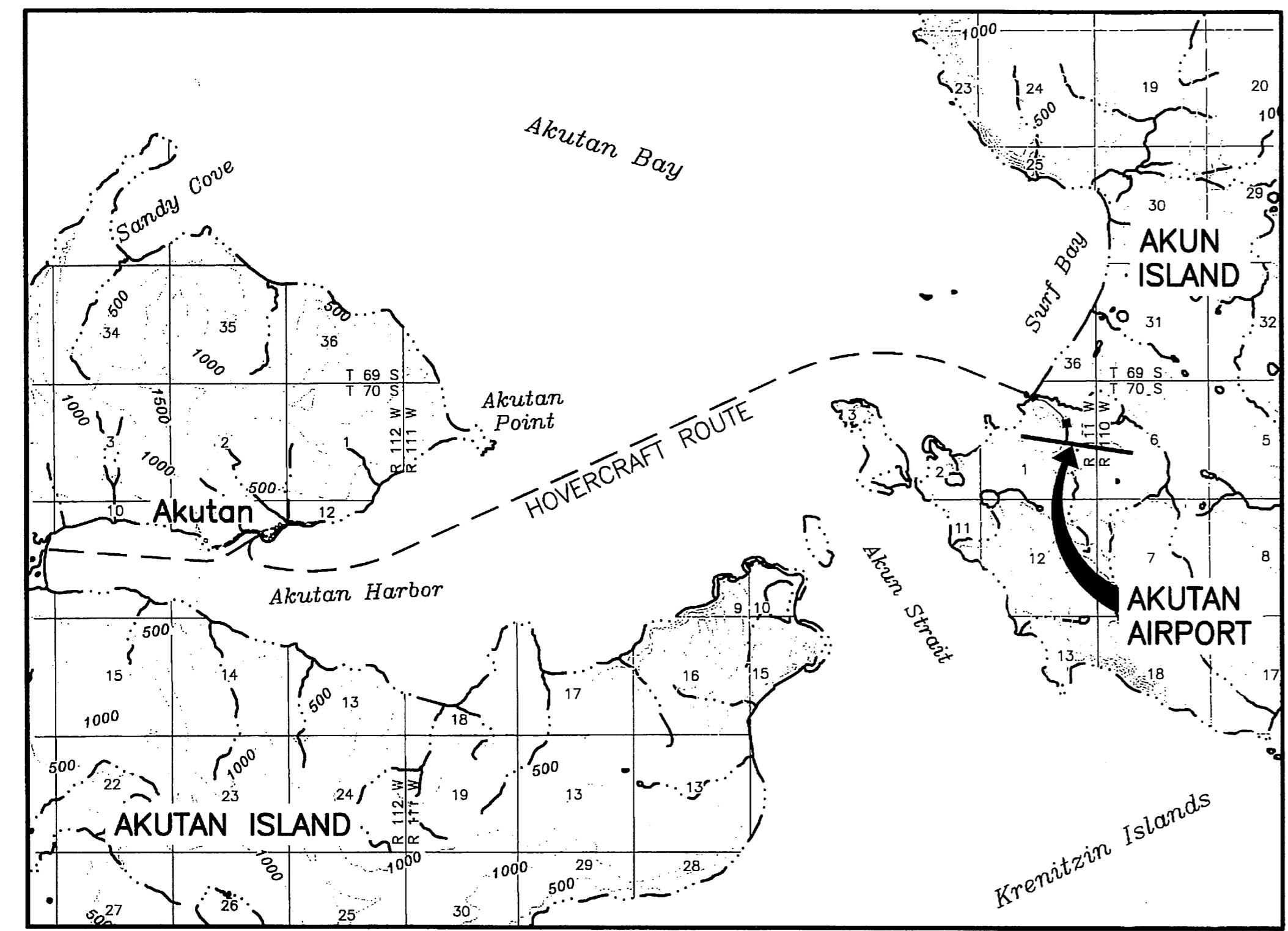
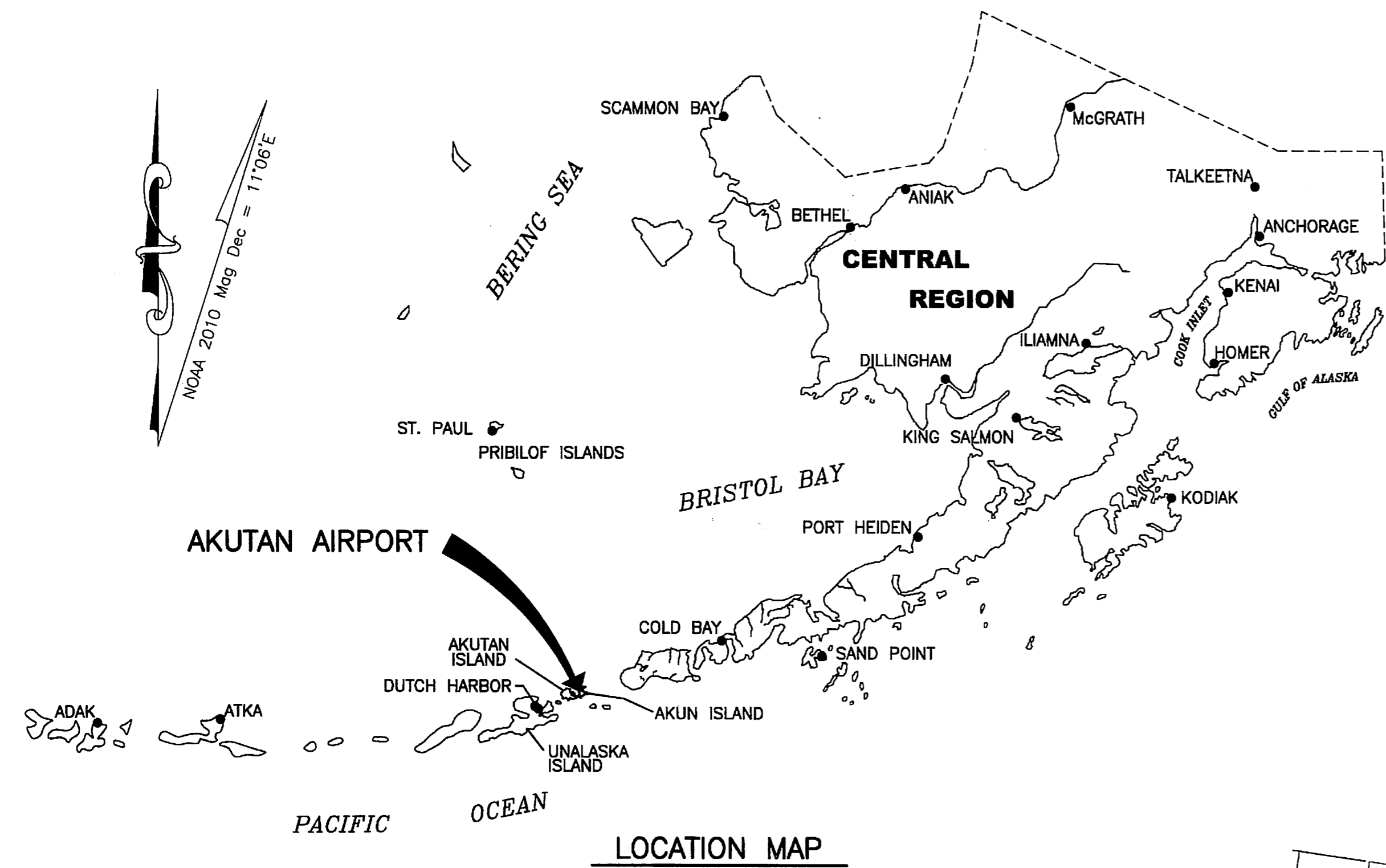

LEGEND		
ITEM	EXISTING	ULTIMATE
AIRPORT REFERENCE POINT (A.R.P.)		
ANTENNA		
BLUFF		
BUILDINGS		
BUILDING RESTRICTION LINE		
FENCE		
PAPI		
PROPERTY LINE		
REIL		
ROADWAYS		
ROTATING BEACON		
SHORELINE, WATERWAY		
SURVEY MONUMENT		
THRESHOLD MARKERS/LIGHTS		
TOPOGRAPHIC CONTOURS		
TREELINE		
VASI		
WIND CONE		
WIND CONE AND SEGMENTED CIRCLE		
HATCH REPRESENTING LAKE		

AIRPORT DATA TABLE		
ITEM	EXISTING	ULTIMATE
ICAO IDENTIFIER	PAUT	PAUT
NATIONAL AIRPORT IDENTIFIER	7AK	7AK
FAA SITE NUMBER	50022.1A	50022.1A
AIRPORT ELEVATION NAVD88	129.3'	129.3'
AIRPORT REFERENCE CODE	B-II	B-II
MEAN MAX. TEMPERATURE, HOTTEST MONTH	60°F JULY	60°F JULY
AIRPORT AND TERMINAL NAVIGATION AIDS	ROTATING BEACON LOC & DME	ROTATING BEACON LOC & DME
TAXIWAY LIGHTING/MARKING	MITL	MITL
OBSTRUCTION SURVEY SOURCE & TYPE	NON VERTICALLY GRADED	NON VERTICALLY GRADED
MAGNETIC DECLINATION, YEAR, RATE OF CHANGE	11°06'E, OCT 1, 2010; 0°10'W/YR	11°06'E, OCT 1, 2010; 0°10'W/YR

NOTES:
 1. ALL ELEVATIONS PROVIDED IN THIS AIRPORT LAYOUT PLAN ARE BASED ON A NAVD88 DATUM.
 2. HORIZONTAL GEOGRAPHIC COORDINATES ARE BASED ON NAD 83.
 3. CAUTION SHOULD BE USED WHEN COMPARING THE AIRPORT LAYOUT PLAN AND THE CONSTRUCTION DOCUMENTS PREPARED BY THE ADOT FOR THE AKUTAN AIRPORT. THE AIRPORT LAYOUT PLAN ELEVATIONS ARE BASED ON A NAVD88 DATUM WHILE THE CONSTRUCTION DOCUMENT ELEVATIONS ARE BASED ON THE MLLW DATUM.

GEOGRAPHIC COORDINATES TABLE						
ITEM	EXISTING LATITUDE	EXISTING LONGITUDE	EXISTING LATITUDE	EXISTING LONGITUDE	ULTIMATE LATITUDE	ULTIMATE LONGITUDE
ARP			N54°08'40.60"	W165°36'14.78"	N54°08'40.60"	W165°36'14.78"
THRESHOLD RW 9			N54°08'43.96"	W165°36'52.13"	N54°08'43.96"	W165°36'52.13"
THRESHOLD RW 27			N54°08'37.24"	W165°35'37.44"	N54°08'37.24"	W165°35'37.44"

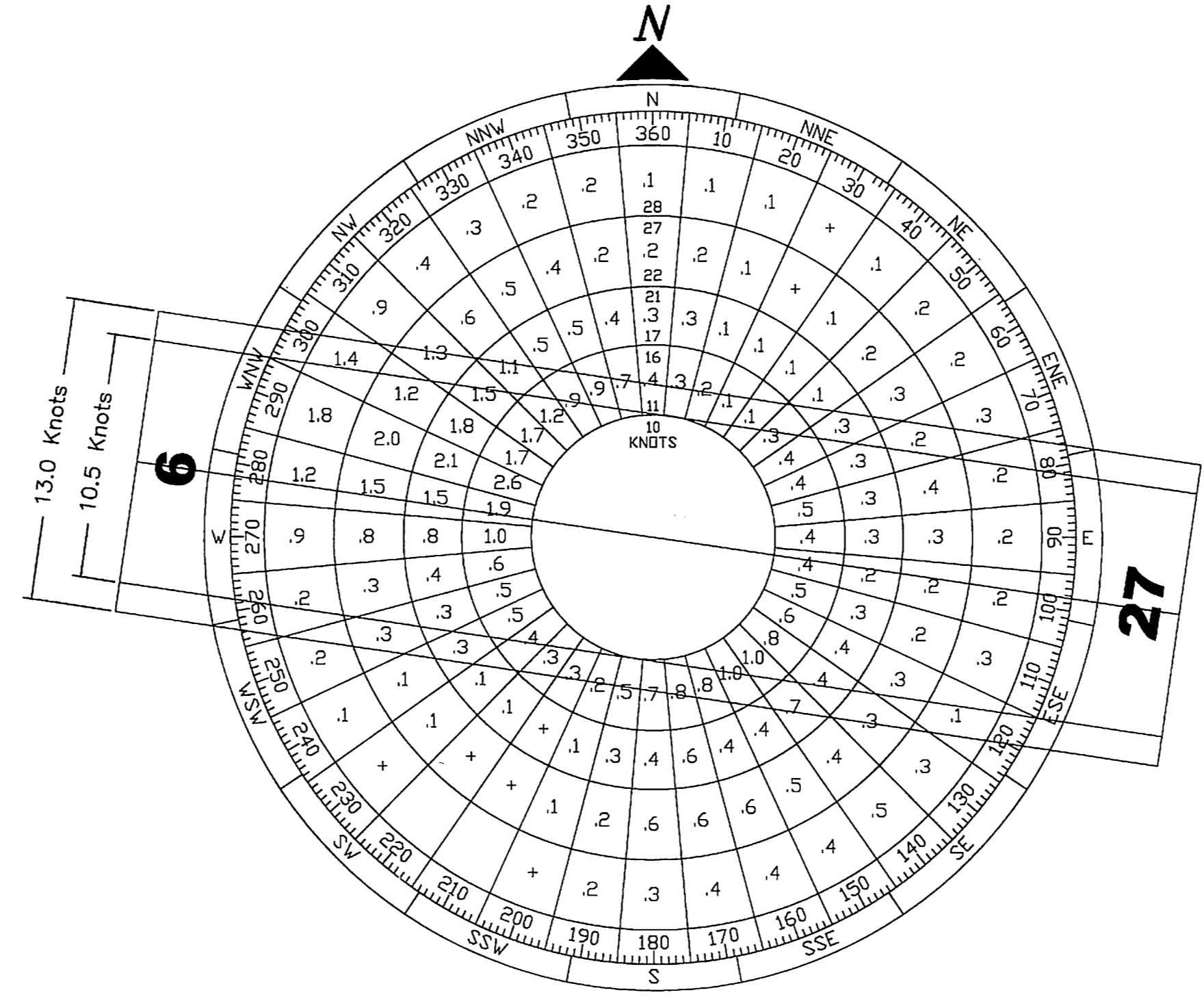

WIND DATA TABLE		
RUNWAY	10.5 kt	13 kt
9/27	69.2%	78.1%

SOURCE: VAISALA MAWS301 AUTOMATIC WEATHER STATION
 INSTALLED AND MAINTAINED BY HDR ALASKA, INC
 PERIOD: 6/3/2005 THRU 8/10/2007
 EXCEPT FOR THE PERIOD 8/10/2005 THRU
 9/28/2005 WHEN COWS KNOCKED THE TOWER DOWN

RUNWAY 9/27 DATA TABLE		
ITEM	EXISTING	ULTIMATE
RUNWAY TYPE	UTILITY OR OTHER THAN UTILITY	OTHER THAN UTILITY
FAR PART 77 APPROACH CATEGORY (V, NPI, P)	NPI / V	NPI / NPI
APPROACH SURFACES	34:1 / 20:1	34:1 / 34:1
VISIBILITY MINIMUM	<1 MILE / >1 MILE	<3/4 MILE / <3/4 MILE
RUNWAY SURFACE	ASPHALT	ASPHALT
PAVEMENT STRENGTH SW,DW,DTW,DDTW x1000lbs	SW 120 DW 250	SW 120 DW 250
AIRCRAFT APPROACH CATEGORY	B	B
AIRPLANE DESIGN GROUP	II	II
TRUE BEARING	S81°17'28.13"E	S81°17'28.13"E
EFFECTIVE GRADE	0.71%	0.71%
TOUCHDOWN ZONE ELEVATION NAVD88	117.0' / 129.3'	117.0' / 129.3'
RUNWAY DIMENSIONS	4500' X 75'	4500' X 100'
RUNWAY SAFETY AREA (RSA) DIMENSIONS	5100' X 150'	5700' X 300'
LENGTH BEYOND R/W END	300	600
RUNWAY PROTECTION ZONE (RPZ) DIMENSIONS RWY 9	1700'x1000'x1510'	2500'x1000'x1750'
RUNWAY PROTECTION ZONE (RPZ) DIMENSIONS RWY 27	1000'x500'x700'	2500'x1000'x1750'
RUNWAY OBJECT FREE AREA (OFA) DIMENSIONS	5100' X 500'	5700' X 800'
LENGTH BEYOND R/W END OR STOPWAY	300	600
RUNWAY OBSTACLE FREE ZONE (OFZ) DIMENSIONS	4900' X 400'	4900' X 400'
RUNWAY LIGHTING	MIRL	MIRL
RUNWAY MARKING TYPE	NPI	PI
RUNWAY VISUAL APPROACH AIDS	PAPI/PAPI	MALSF,PAPI,REILS/ PAPI,REILS

THERE ARE NO OBJECT FREE AREA PENETRATIONS
 THERE ARE NO OFZ OBJECT PENETRATIONS

DRAWING INDEX	
SHT No.	TITLE
1	COVER AND DATA
2	EXISTING LAYOUT
3	ULTIMATE LAYOUT
4	EXISTING INNER PORTION OF THE RUNWAY 9 APPROACH SURFACE
5	EXISTING INNER PORTION OF THE RUNWAY 27 APPROACH SURFACE
6	ULTIMATE INNER PORTION OF THE RUNWAY 9 APPROACH SURFACE
7	ULTIMATE INNER PORTION OF THE RUNWAY 27 APPROACH SURFACE
8	AIRPORT AIRSPACE 14 CFR, PART 77
9	AIRPORT PROPERTY MAP

MODIFICATION TO STANDARDS/ NON STANDARD CONDITIONS			
DESCRIPTION	STANDARD	EXISTING	ULTIMATE
NONE			

APPROVED:
 KENNETH M. MORTON, P.E. PRECONSTRUCTION ENGINEER
 DATE: 5/4/2012
 RECOMMENDED:
 HARVEY M. DOUTHETT, P.E. DESIGN SECTION CHIEF
 DATE: 5/3/2012
 AIRPORT LAYOUT PLAN CONDITIONAL APPROVAL SUBJECT TO
 ALP APPROVAL LETTER DATED 5/16/12
 FAA AIRSPACE REVIEW NUMBER: 2011-AAL-14-NEA
 DATE: 5/16/12
 FAA, AIRPORTS DIVISION ALASKAN REGION, AAL-621

STATE OF ALASKA
 DEPARTMENT OF TRANSPORTATION
 AND PUBLIC FACILITIES
 CENTRAL REGION
 AKUTAN AIRPORT
 AKUTAN, ALASKA
 AIRPORT LAYOUT PLAN
 COVER AND DATA
 DATE: 04/27/12
 SHEET: 1 OF 9

Date Plotted: 7/9/2015
 Layout Name: SHEET 2
 File Name: W:\Projects\Akutan\ALP\2015 Update\2015 Drawings\ACAD-Akutan-ALP-Sheet_02R.dwg
 Designed By: DTK
 Drawn By: PK
 Checked By: DTK

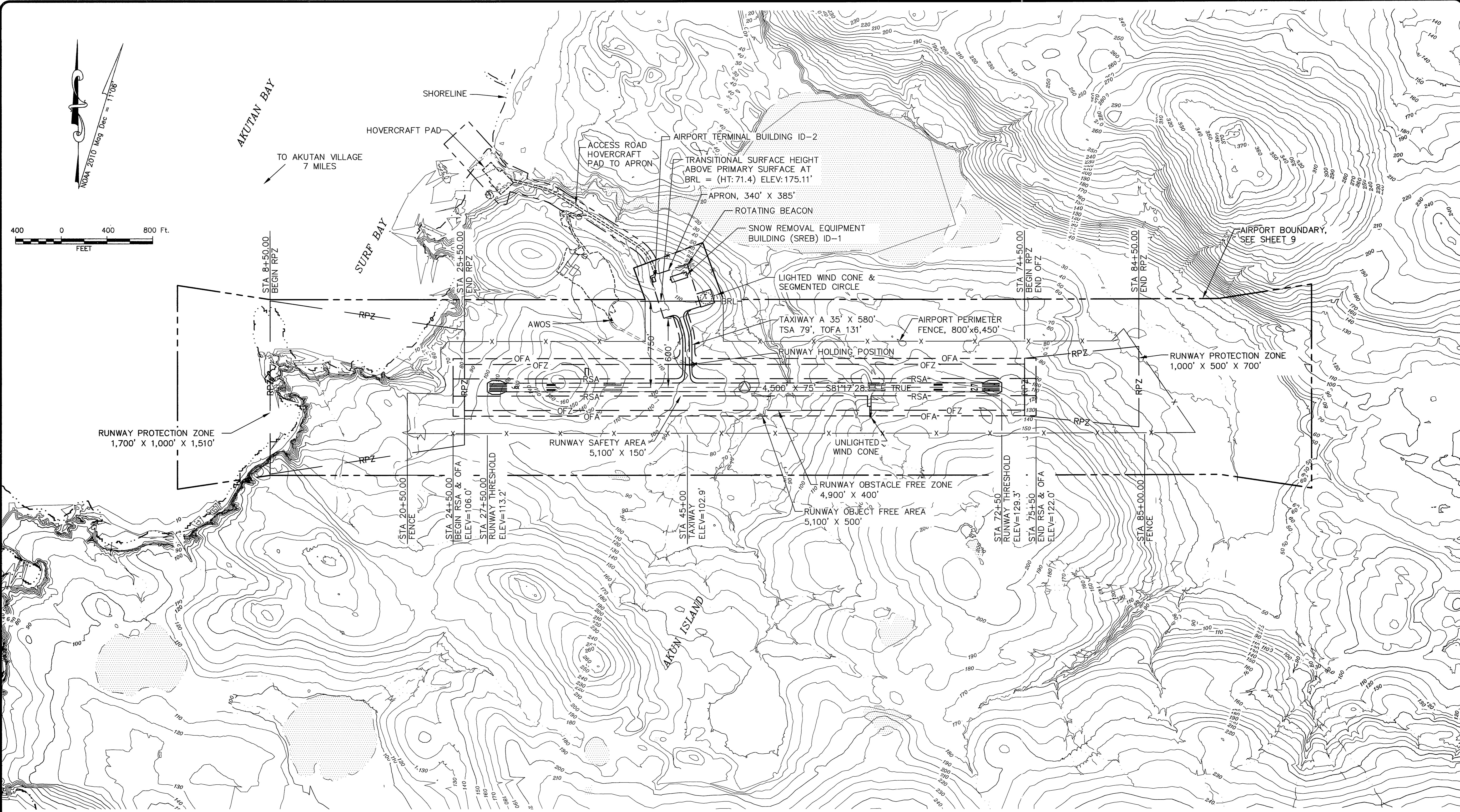

RUNWAY PROTECTION ZONE
1,700' X 1,000' X 1,510'

RUNWAY PROTECTION ZONE
1,000' X 500' X 700'

BUILDING DATA TABLE				
ID #	DESCRIPTION	STATION / OFFSET	TOP ELEV (NAVD88)	OBSTRUCTION MARKING
1	SREB	43+16 913' L	127.0'	LIGHT
2	AIRPORT TERMINAL	42+02 916'L (EST)	110' (EST)	NONE

- NOTES:
1. CONTOUR INTERVAL 10 Ft.
 2. NO OFZ OBJECT PENETRATIONS.
 3. SEE AIRPORT BOUNDARY DIMENSIONS ON SHEET 9.

BY	DATE	REVISION
	07/2015	UPDATE ACCESS ROAD LAND USE AND ADD AIRPORT TERMINAL
	10/2014	AS-BUILT PER AKSAS 51196

STATE OF ALASKA
DEPARTMENT OF TRANSPORTATION
AND PUBLIC FACILITIES
CENTRAL REGION

AKUTAN AIRPORT
 AKUTAN, ALASKA
 AIRPORT LAYOUT PLAN
 EXISTING LAYOUT

DATE:	04/27/12
SHEET:	2
OF	9

Date Plotted: 7/9/2015
 Layout Name: SHEET_3
 File Name: W:\Projects\Akutan\ALP\2015 Update\ACAD-Akutan-ALP-Sheet_03R.dwg
 Designed By: DTK
 Drawn By: PK
 Checked By: DTK

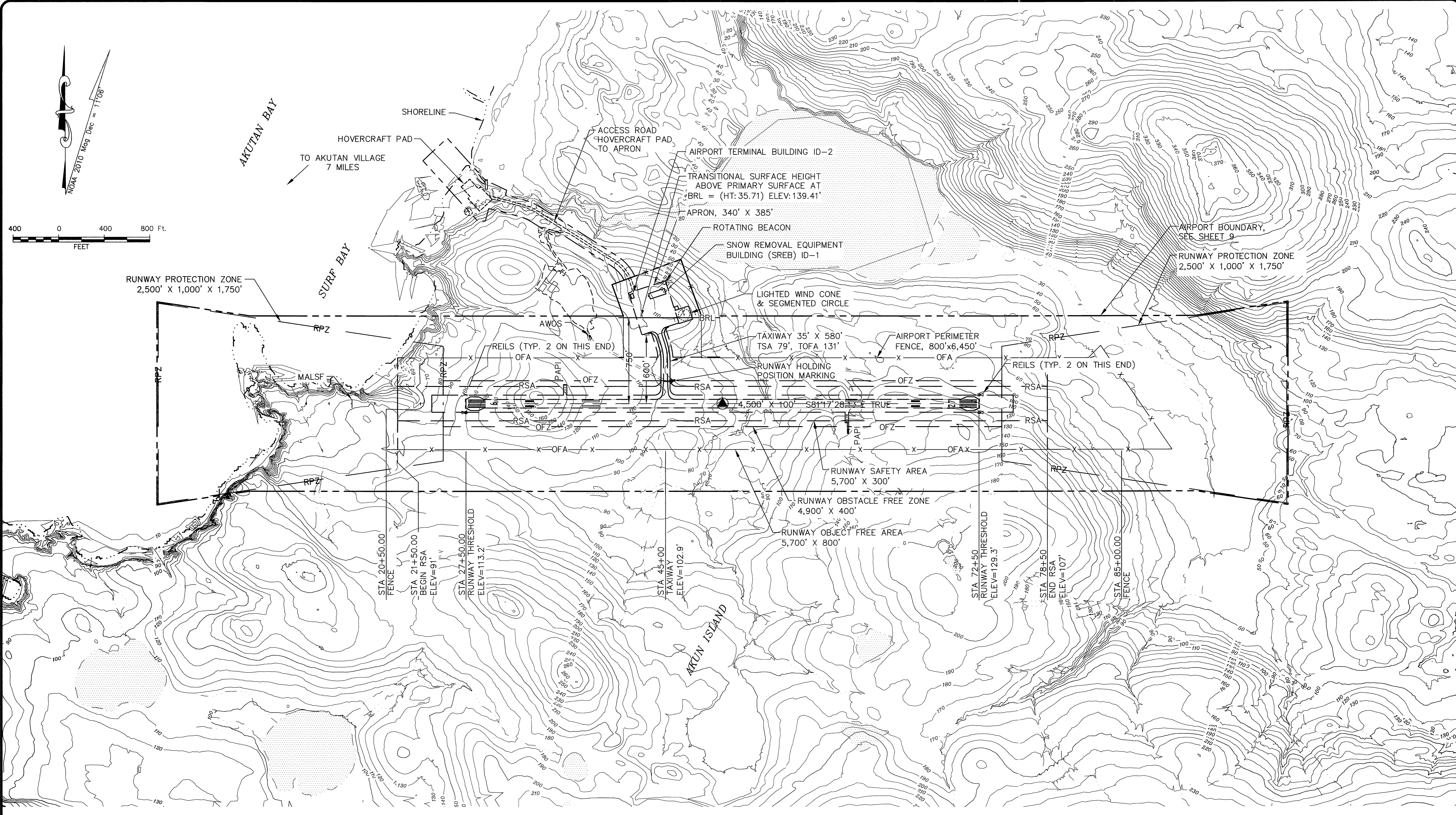

BUILDING DATA TABLE				
ID #	DESCRIPTION	STATION / OFFSET	TOP ELEV (NAVD88)	OBSTRUCTION MARKING
1	SREB	43+16 913' L	127.0'	
2	AIRPORT TERMINAL	42+02 916'L (EST)	110' (EST)	NONE

- NOTES:
1. CONTOUR INTERVAL 10 FT.
 2. NO OFZ OBJECT PENETRATIONS.
 3. SEE AIRPORT BOUNDARY DIMENSIONS ON SHEET 9.

BY	DATE	REVISION
	07/2015	UPDATE ACCESS ROAD LAND USE AND ADD AIRPORT TERMINAL
	10/2014	AS-BUILT PER AKSAS 51196

STATE OF ALASKA
DEPARTMENT OF TRANSPORTATION
AND PUBLIC FACILITIES
CENTRAL REGION

AKUTAN AIRPORT
 AKUTAN, ALASKA
 AIRPORT LAYOUT PLAN
 ULTIMATE LAYOUT

DATE:	04/27/12
SHEET:	3
OF	9

Date Plotted: 11/23/2014
 Layout Name: SHEET 4
 File Name: W:\Projects\Akutan\ALP\2014 Drawings\ACAD-Akutan-ALP-Sheet_04.dwg
 Designed By: DTK
 Drawn By: PK
 Checked By: DTK

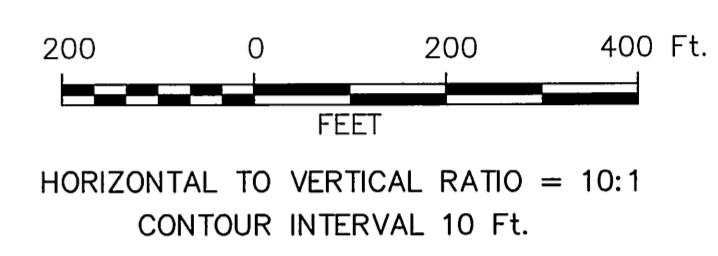
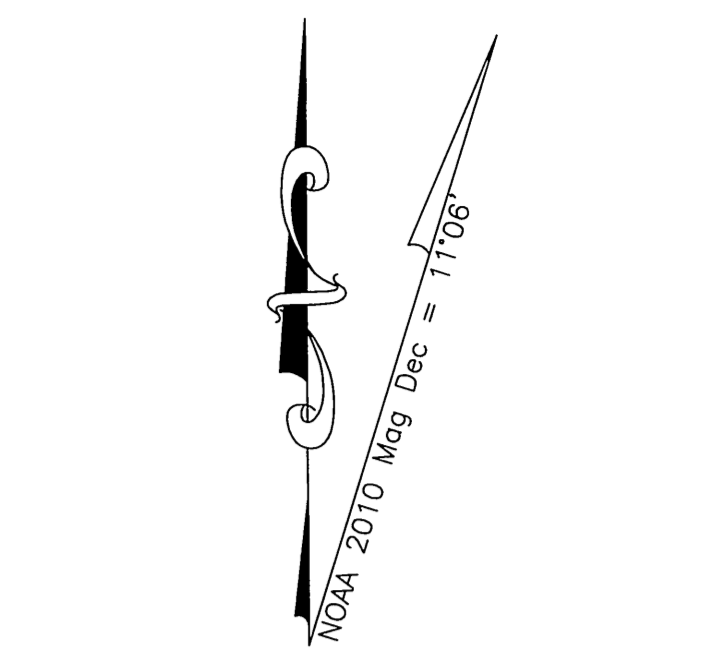
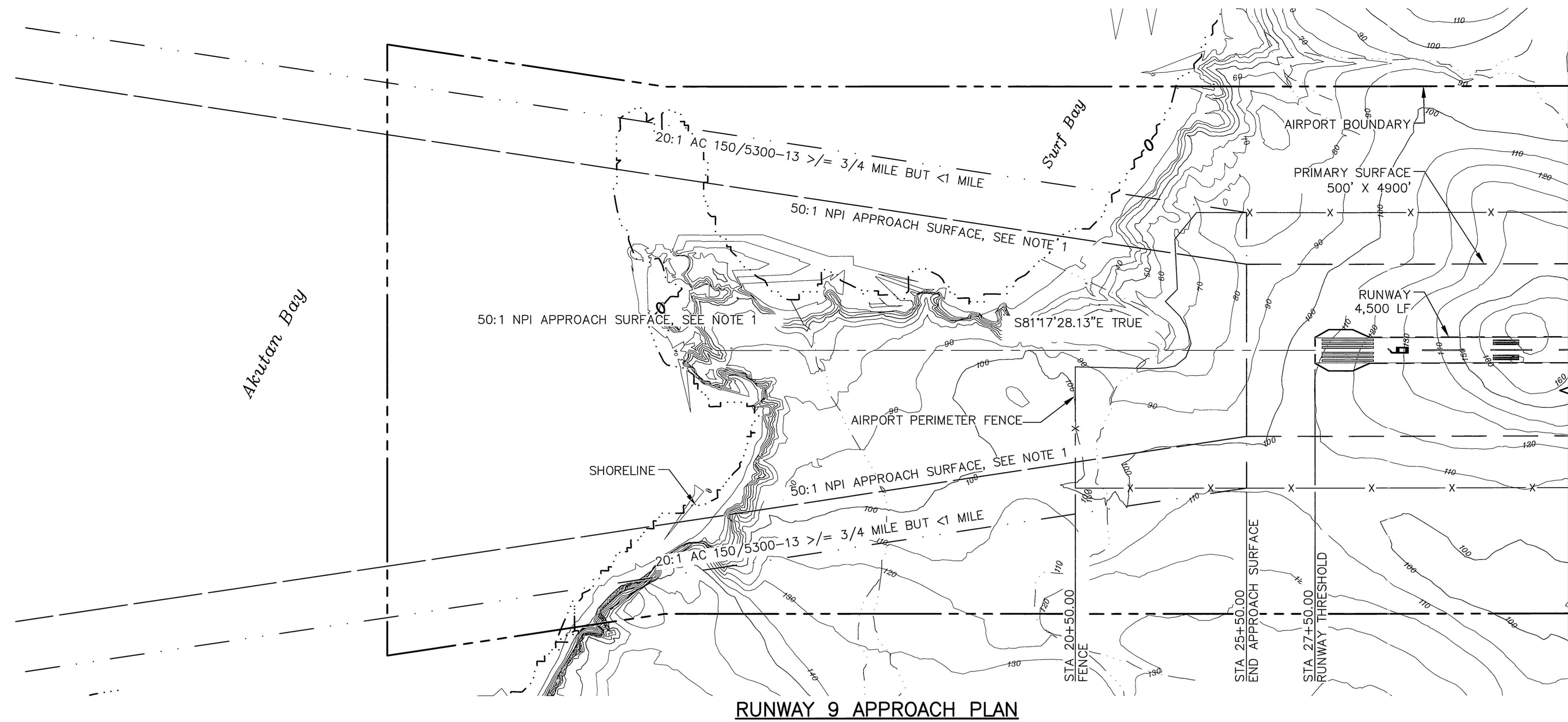

- NOTES:
1. THERE ARE NO CONTROLLING OBSTRUCTIONS OF RUNWAY 9, THEREFORE THE CONTROLLING OBSTRUCTION CLEARANCE SLOPE IS ESTABLISHED AT 50:1 PER FAA AC 150/5200-35, SECTION 4, D.E.N. 57
 2. THERE ARE NO OBJECT PENETRATIONS IN THE RUNWAY APPROACH END SITING SURFACES OF RUNWAY 9 AS DEFINED IN FAA AC 150/5300-13 CHG 15 APPENDIX 2 TABLE A2-1, LINE 8.

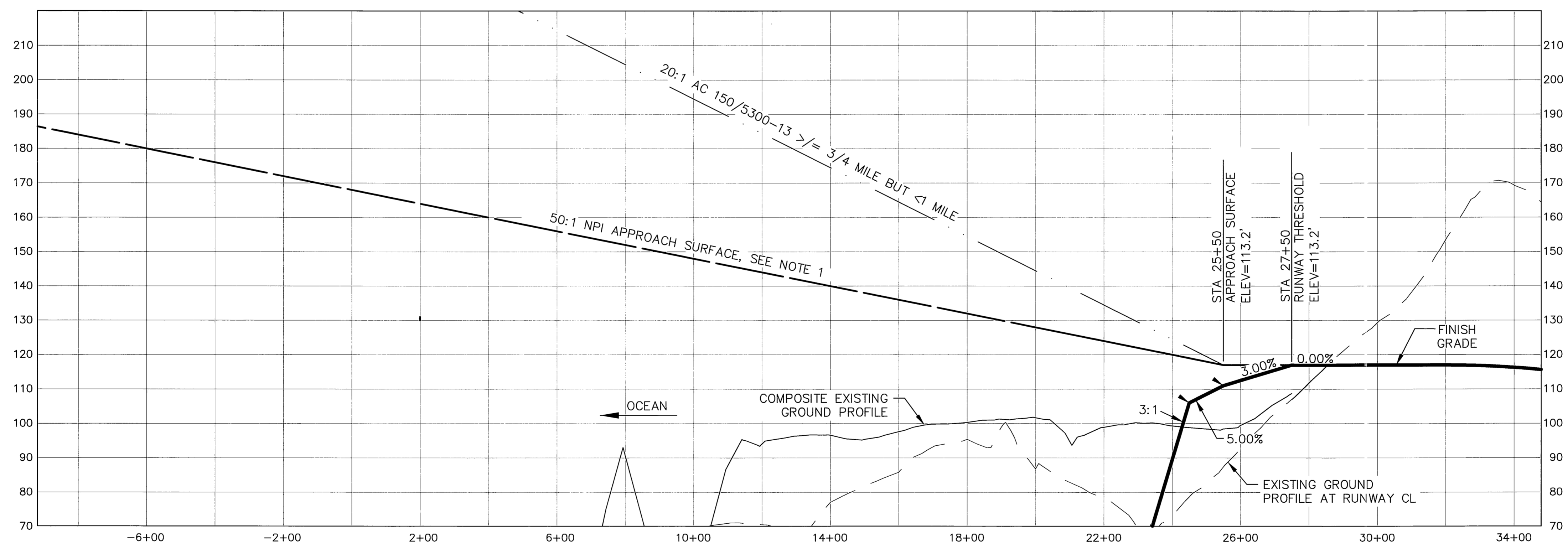

RUNWAY 9 APPROACH PROFILE

PART 77 SURFACE OBSTRUCTION TABLE (INNER PORTION RW 9)								
ID#	DESCRIPTION	STATION/OFFSET	ELEVATION NAVD88	SURFACE PENETRATED	SURFACE ELEVATION	AMOUNT PENETRATION	DISPOSITION	STAGE TO CORRECT
	NONE							

NOTE: REFER TO THE AIRPORT AIRSPACE DRAWING FOR PENETRATIONS OF THE OUTER APPROACH SURFACES

BY	DATE	REVISION
	10/2014	AS-BUILT PER AKSAS 51196

**STATE OF ALASKA
DEPARTMENT OF TRANSPORTATION
AND PUBLIC FACILITIES
CENTRAL REGION**

AKUTAN AIRPORT
AKUTAN, ALASKA
AIRPORT LAYOUT PLAN

EXISTING INNER PORTION OF THE
RUNWAY 9 APPROACH SURFACE

DATE:	04/27/12
SHEET:	4 OF 9

Date Plotted: 11/15/2014
 Layout Name: SHEET 5
 File Name: W:\Projects\Akutan\ALP\2014 Drawings\ACAD-Akutan-ALP-Sheet_05.dwg
 Designed By: DTK
 Drawn By: PK
 Checked By: DTK

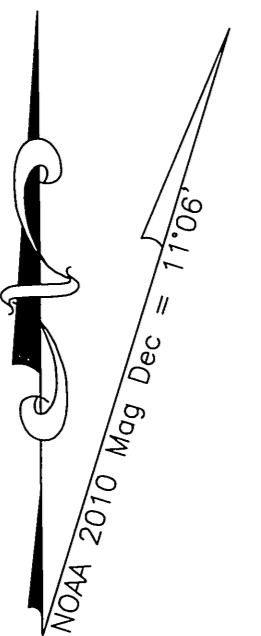

200 0 200 400 Ft.
 FEET
 HORIZONTAL TO VERTICAL RATIO = 10:1
 CONTOUR INTERVAL 10 Ft.

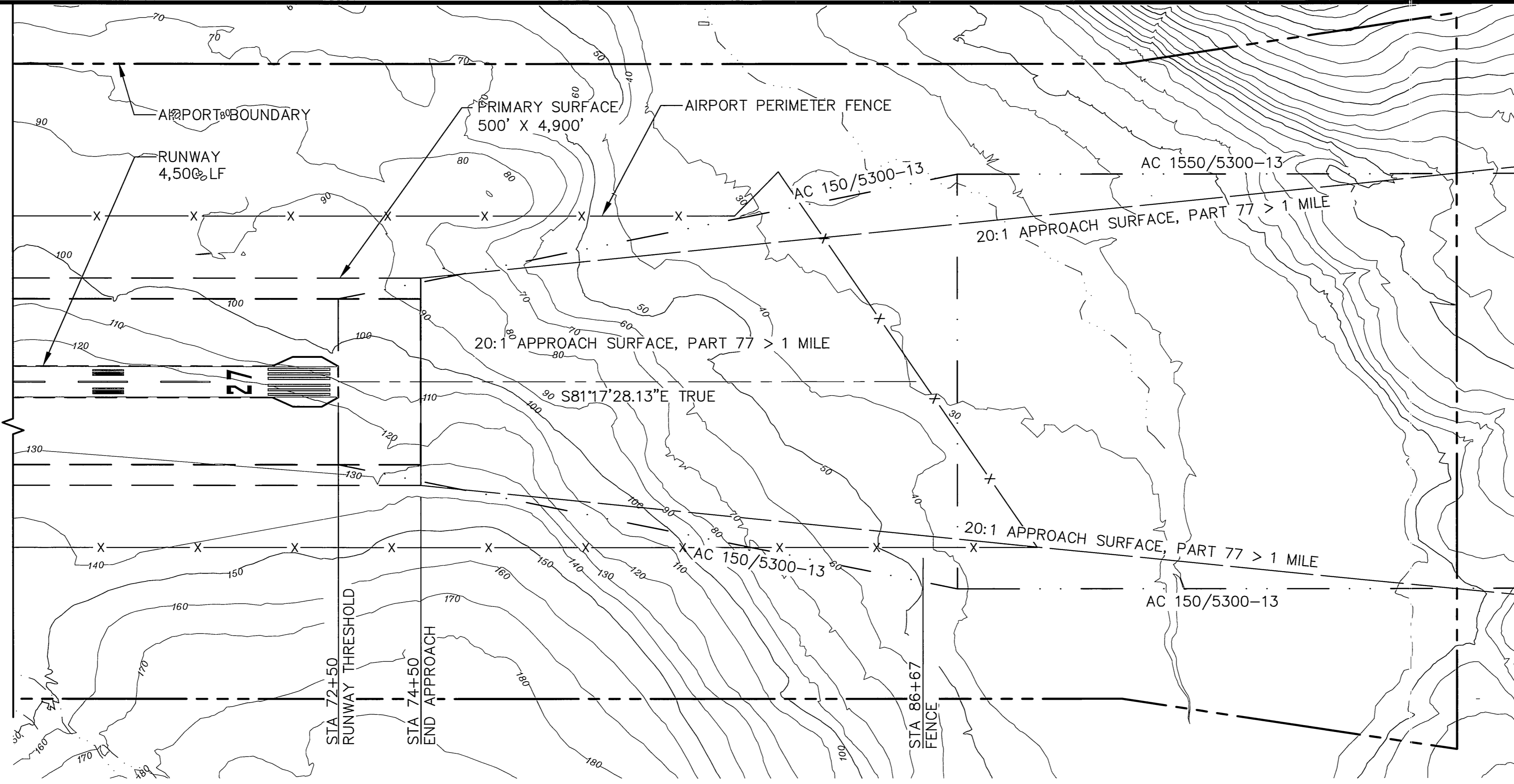

RUNWAY 27 APPROACH PLAN

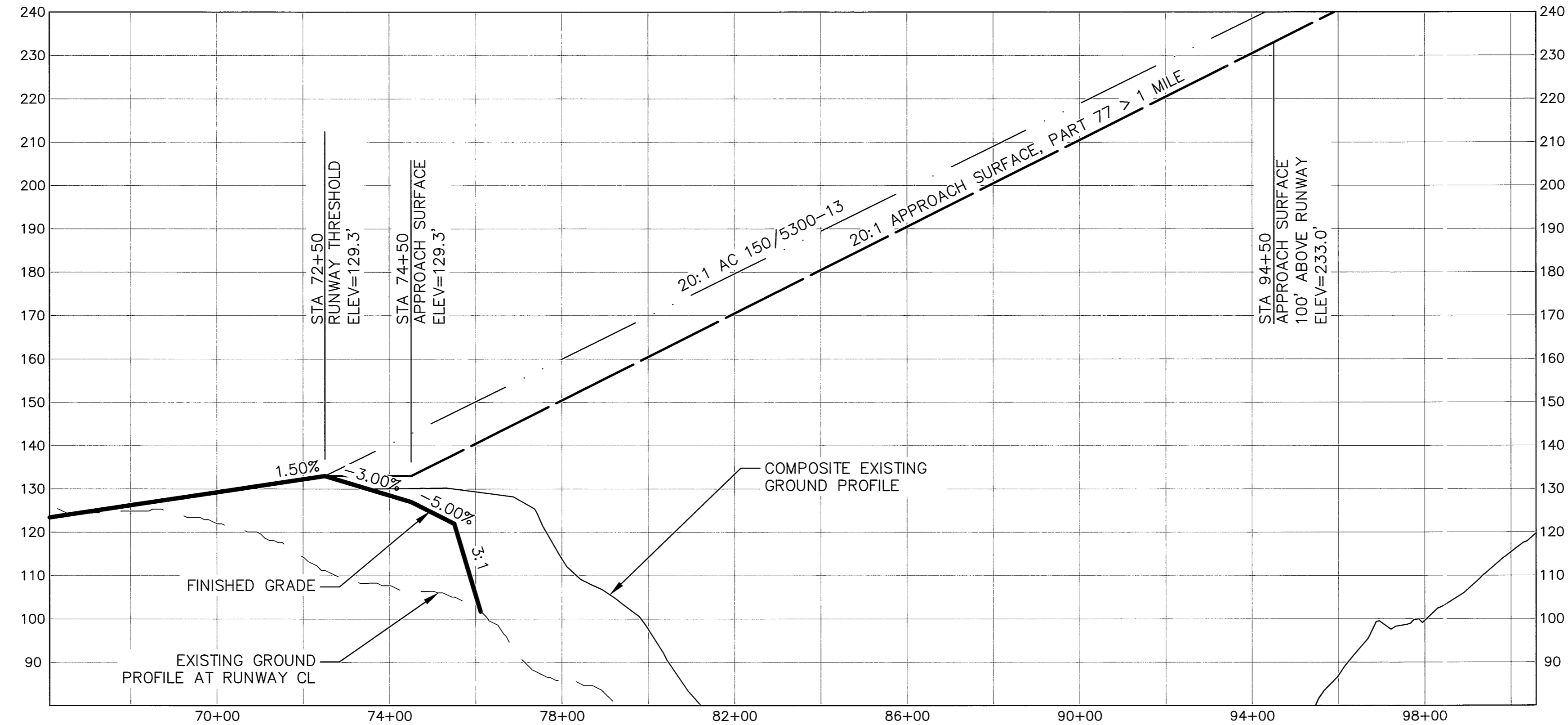

RUNWAY 27 APPROACH PROFILE

PART 77 SURFACE OBSTRUCTION TABLE (INNER PORTION RW 27)								
ID#	DESCRIPTION	STATION/OFFSET	ELEVATION NAVD88	SURFACE PENETRATED	SURFACE ELEVATION	AMOUNT PENETRATION	DISPOSITION	STAGE TO CORRECT
	NONE							

NOTE: REFER TO THE AIRPORT AIRSPACE DRAWING FOR PENETRATIONS OF THE OUTER APPROACH SURFACES

BY	DATE	REVISION
	10/2014	AS-BUILT PER AKSAS 51196

NOTES:

- AFTER NEAR TERM DEVELOPMENT, THE CONTROLLING OBSTRUCTION CLEARANCE SLOPE FOR RUNWAY 27 IS ESTABLISHED AT 20:1 PER FAA AC 150/5200-35, SECTION 4, D.E.N. 57
- AFTER NEAR TERM DEVELOPMENT, THERE WILL BE NO OBJECT PENETRATIONS IN THE RUNWAY APPROACH END SITING SURFACES OF RUNWAY 27 AS DEFINED IN FAA AC 150/5300-13 CHG 15 APPENDIX 2 TABLE A2-1, LINE 3.

STATE OF ALASKA
DEPARTMENT OF TRANSPORTATION
AND PUBLIC FACILITIES
CENTRAL REGION

AKUTAN AIRPORT
 AKUTAN, ALASKA
 AIRPORT LAYOUT PLAN

EXISTING INNER PORTION OF THE
 RUNWAY 27 APPROACH SURFACE

DATE: 04/27/12
 SHEET: 5 OF 9

Date Plotted: 11/3/2014
 Layout Name: SHEET 6
 File Name: W:\Projects\Akutan\ALP\2014 Drawings\ACAD-Akutan-ALP-Sheet_06.dwg

Designed By: DTK
 Drawn By: PK
 Checked By: DTK

Akutan Bay

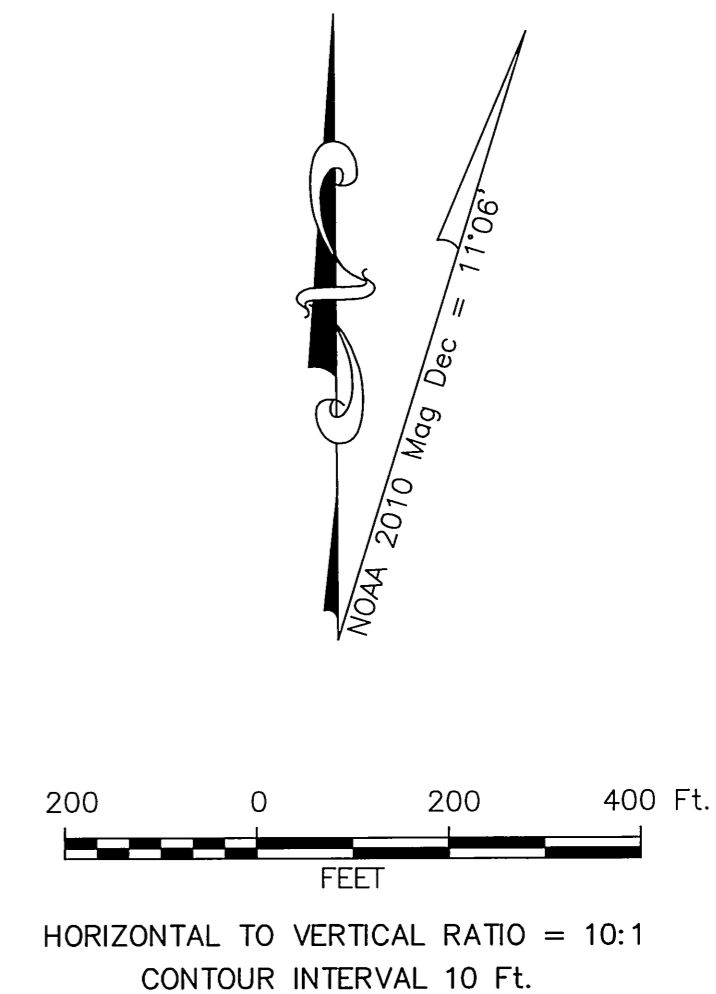
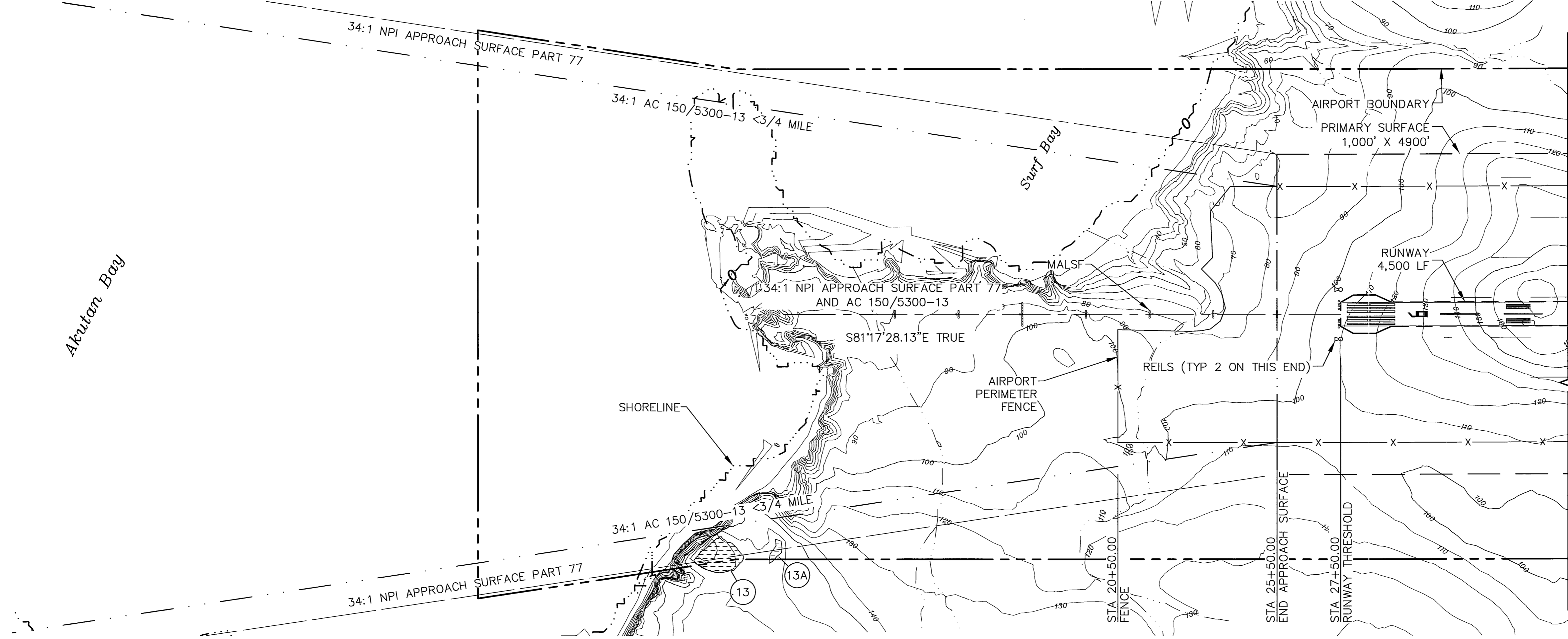

RUNWAY 9 APPROACH PLAN

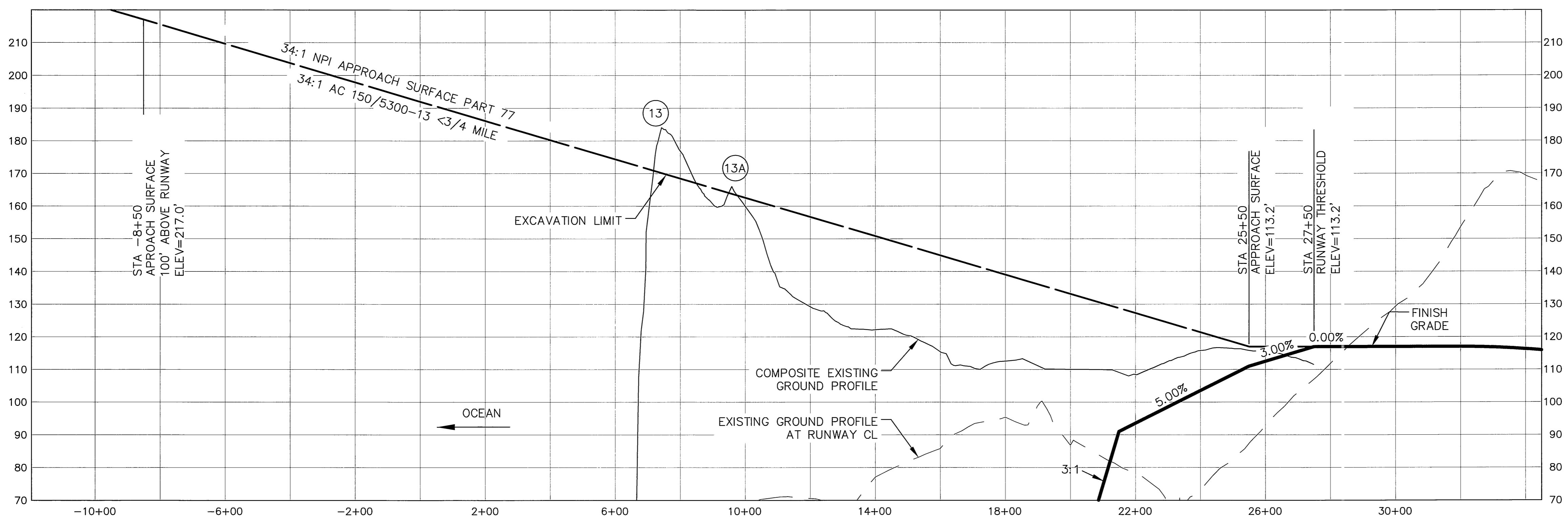

RUNWAY 9 APPROACH PROFILE

PART 77 SURFACE OBSTRUCTION TABLE (INNER PORTION RW 9)

ID#	DESCRIPTION	STATION/OFFSET	ELEVATION NAVD88	SURFACE PENETRATED	SURFACE ELEVATION	AMOUNT PENETRATION	DISPOSITION	STAGE TO CORRECT
13	GROUND	7+59/700'R	184	APPROACH	170	14	REMOVE	ULTIMATE
13A	GROUND	9+58/680'R	166	APPROACH	163	3	REMOVE	ULTIMATE

NOTE: REFER TO THE AIRPORT AIRSPACE DRAWING FOR PENETRATIONS OF THE OUTER APPROACH SURFACES

- NOTES:
- AFTER ULTIMATE DEVELOPMENT THE CONTROLLING OBSTRUCTION CLEARANCES SLOPE FOR RUNWAY 9 IS ESTABLISHED AT 34:1 PER FAA AC 150/5200-35, SECTION 4, D.E.N. 57
 - AFTER ULTIMATE DEVELOPMENT THERE WILL BE NO OBJECT PENETRATIONS IN THE RUNWAY APPROACH END SITING SURFACES OF RUNWAY 9 AS DEFINED IN FAA AC 150/5300-13 CHG 15 APPENDIX 2 TABLE A2-1, LINE 9.

**STATE OF ALASKA
 DEPARTMENT OF TRANSPORTATION
 AND PUBLIC FACILITIES
 CENTRAL REGION**

AKUTAN AIRPORT
 AKUTAN, ALASKA
 AIRPORT LAYOUT PLAN

ULTIMATE INNER PORTION OF THE
 RUNWAY 9 APPROACH SURFACE

DATE: 04/27/12
 SHEET: 6 OF 9

BY	DATE	REVISION

Date Plotted: 11/13/2014
 Layout Name: SHEET 7
 File Name: W:\Projects\Akutan\ALP\2014 Drawings\ACAD-Akutan-ALP-Sheet_07.dwg
 Designed By: DTK
 Drawn By: PK
 Checked By: DTK

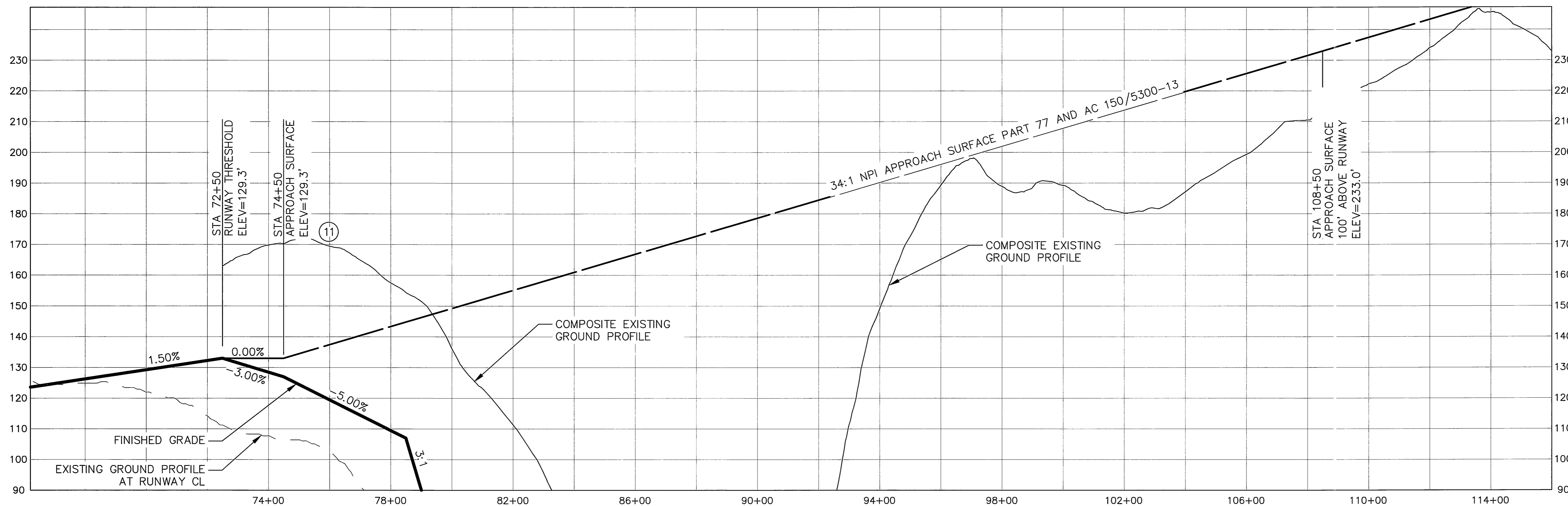
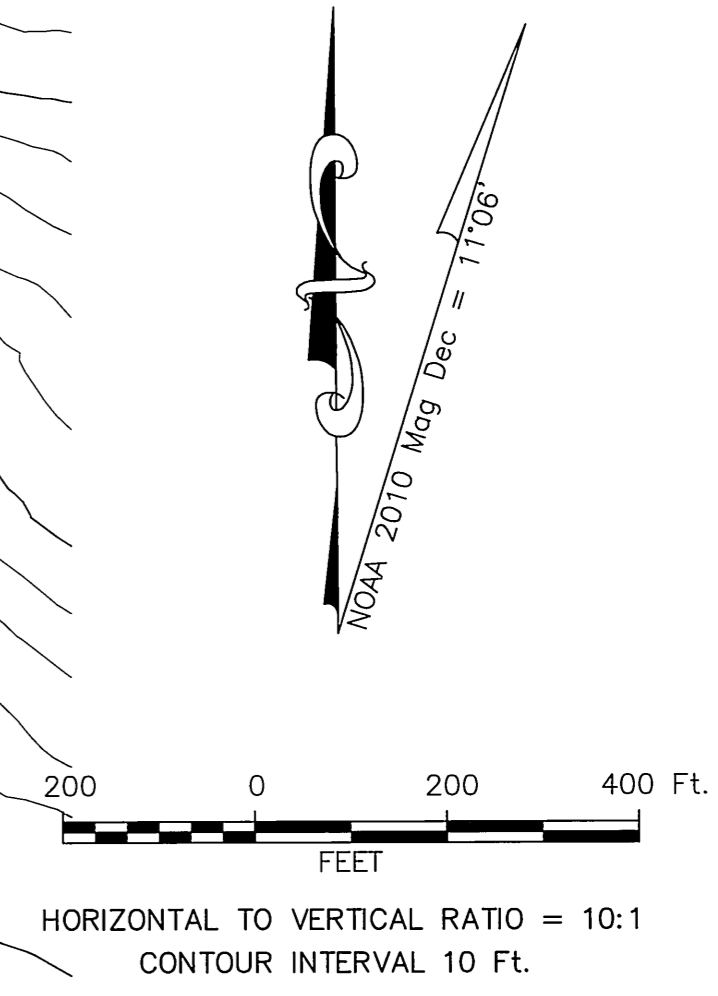
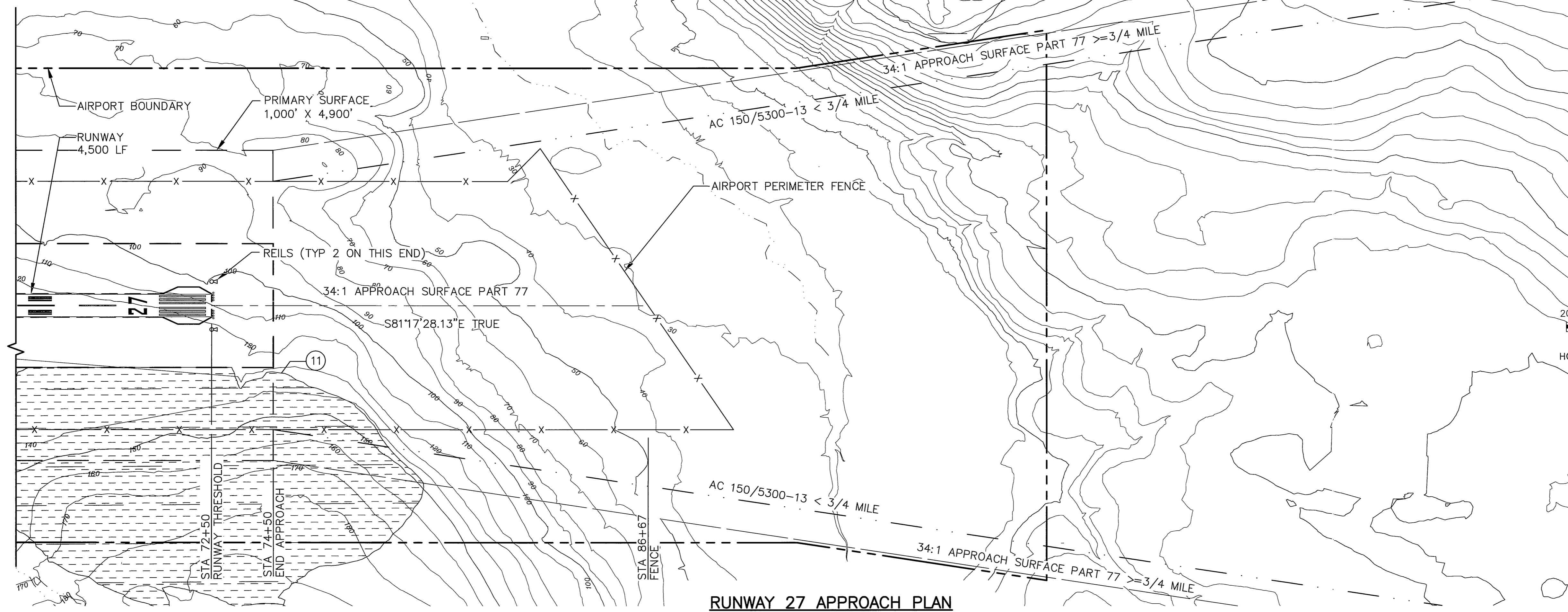

- NOTES:
1. THERE ARE CONTROLLING OBSTRUCTIONS OF RUNWAY 27 AT STATIONS 99+00 AND 113+50, THEREFORE THE CONTROLLING CLEARANCE SLOPE IS ESTABLISHED AT 34:1 PER FAA AC 150/5200-35, SECTION 4, D.E.N. 57
 2. THERE ARE NO OBJECT PENETRATIONS IN THE RUNWAY APPROACH END SITING SURFACES OF RUNWAY 27 AS DEFINED IN FAA AC 150/5300-13 CHG 15 APPENDIX 2 TABLE A2-1, LINE 9.

PART 77 SURFACE OBSTRUCTION TABLE (INNER PORTION RW 27)

ID#	DESCRIPTION	STATION/OFFSET	ELEVATION NAVD88	SURFACE PENETRATED	SURFACE ELEVATION	AMOUNT PENETRATION	DISPOSTION	STAGE TO CORRECT
11	GROUND	76+00/470'R	169	APPROACH	140	33	REMOVE	ULTIMATE

NOTE:
REFER TO THE AIRPORT AIRSPACE DRAWING FOR PENETRATIONS OF THE OUTER APPROACH SURFACES

BY	DATE	REVISION

STATE OF ALASKA
DEPARTMENT OF TRANSPORTATION
AND PUBLIC FACILITIES
CENTRAL REGION

AKUTAN AIRPORT
 AKUTAN, ALASKA
 AIRPORT LAYOUT PLAN

ULTIMATE INNER PORTION OF THE
 RUNWAY 27 APPROACH SURFACE

DATE: 04/27/12
 SHEET: 7 OF 9

Date Plotted: 11/15/2014
 Layout Name: Sheet 8
 File Name: W:\Projects\Akutan\ALP\2014 Drawings\ACAD-Akutan-ALP-Sheet_08.dwg
 Designed By: DTK
 Drawn By: PK
 Checked By: DTK

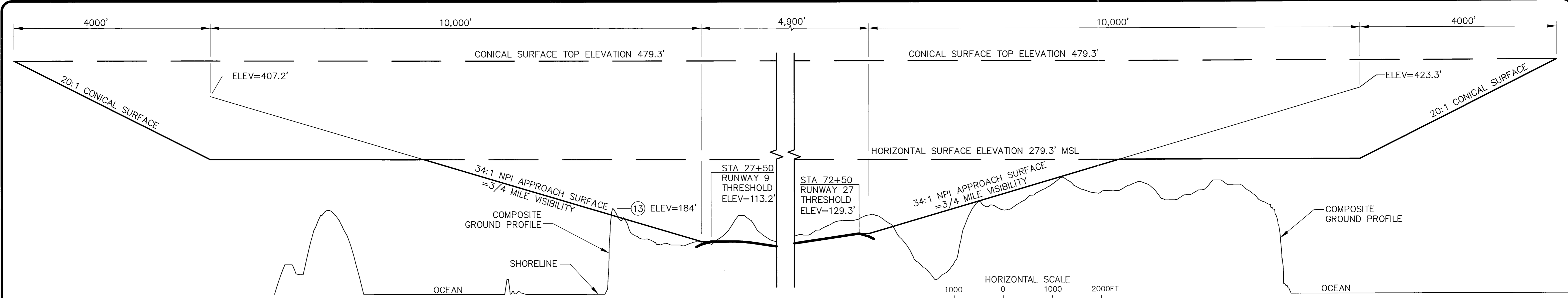

RUNWAY 9-27 PROFILE

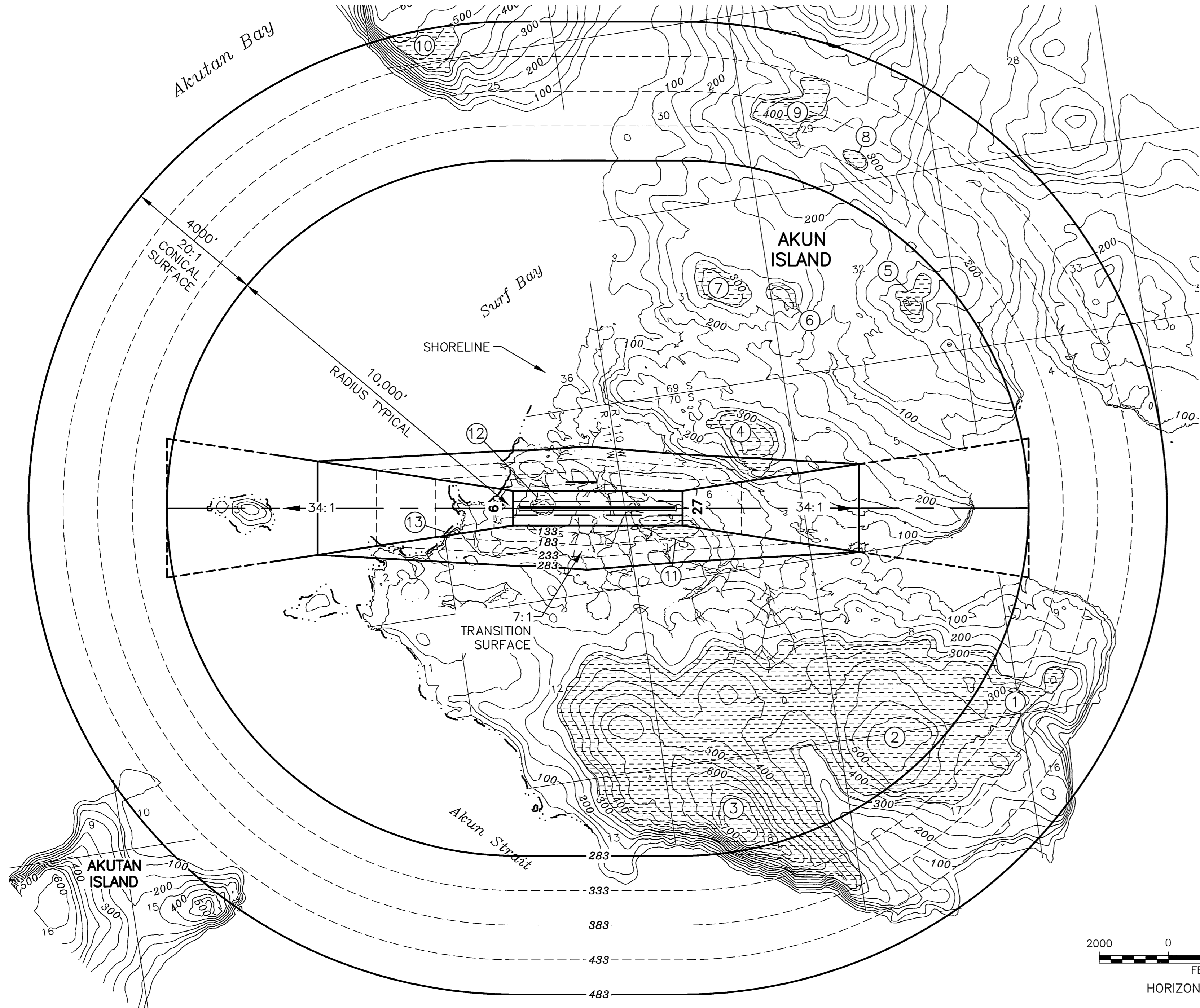
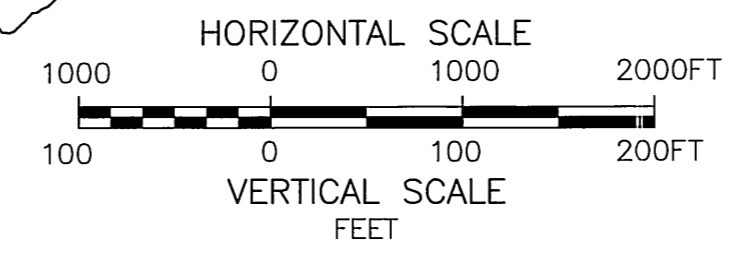

ID #		STATION OFFSET	ELEVATION NAVD 88	SURFACE PENETRATION	SURFACE ELEVATION	AMOUNT (ft) PENETRATION	DISPOSITION	STAGE TO CORRECT
1	HIGHEST TERRAIN POINT	132+40, 5,087R	450	HORIZONTAL	335	167	REMAIN *	ULTIMATE
2	HIGHEST TERRAIN POINT	135+30, 6,654R	590	HORIZONTAL	283	307	REMAIN	---
3	HIGHEST TERRAIN POINT	91+60, 9,267R	800	HORIZONTAL	283	517	REMAIN	---
4	HIGHEST TERRAIN POINT	93+60, 2,096R	390	HORIZ/TRANS	283	107	REMOVE	---
5	HIGHEST TERRAIN POINT	142+50, 5,618R	310	HORIZONTAL	283	27	REMAIN	---
6	HIGHEST TERRAIN POINT	102+60, 6,260R	310	HORIZONTAL	283	27	REMAIN	---
7	HIGHEST TERRAIN POINT	86+30, 6,314R	340	HORIZONTAL	283	57	REMAIN	---
8	HIGHEST TERRAIN POINT	126+00, 9,935R	360	CONICAL	344	16	REMAIN	---
9	HIGHEST TERRAIN POINT	109+60, 11,500L	450	CONICAL	385	65	REMAIN	---
10	HIGHEST TERRAIN POINT	-5+50, 13,750L	560	CONICAL	481	79	REMAIN	---
11	HIGHEST TERRAIN POINT	74+50, 500R	165	APPROACH/TRANS	133	32	REMOVE	ULTIMATE
12	HIGHEST TERRAIN POINT	36+50, 100L	170	PRIMARY/TRANS	116	54	REMOVE	ULTIMATE
13	HIGHEST TERRAIN POINT	7+80, 750L	184	APPROACH	171	13	REMOVE	ULTIMATE

*TERRAIN PENETRATION TO THE APPROACH AND TRANSITION SURFACES TO BE REMOVED.
 TERRAIN PENETRATION TO THE HORIZONTAL AND CONICAL SURFACES TO REMAIN.

NOTES:

- ELEVATIONS ARE IN FEET
- AIRPORT ELEVATION IS 129.3' NAVD 88
- DRAWING BASED ON U.S.G.S. UNIMAK A-5
- REFER TO THE INNER PORTION OF THE APPROACH SURFACE PLAN VIEW FOR CLOSE IN DETAILS, SHEETS 4-7
- ULTIMATE PRIMARY SURFACE IS 1,000' WIDE
- NO SEWAGE LAGOONS OR LANDFILLS HAVE BEEN IDENTIFIED WITHIN 10,000' OF THE AIRPORT
- THERE ARE NO KNOWN HEIGHT RESTRICTIONS
- APPROACH SURFACES ARE 34:1 BEGINNING 200 FEET BEFORE EACH THRESHOLD

BY	DATE	REVISION

**STATE OF ALASKA
 DEPARTMENT OF TRANSPORTATION
 AND PUBLIC FACILITIES
 CENTRAL REGION**

AKUTAN AIRPORT
 AKUTAN, ALASKA
 AIRPORT LAYOUT PLAN

AIRPORT AIRSPACE
 14 CFR, PART 77

DATE: 04/27/12
 SHEET: 8 OF 9

Date Plotted: 7/8/2015
 Layout Name: SHEET 9
 File Name: W:\Projects\Akutan\ALP\2015 Update\2015 Drawings\ACAD-Akutan-ALP-Sheet_09a.dwg
 Designed By: DTK
 Drawn By: PK
 Checked By: DTK

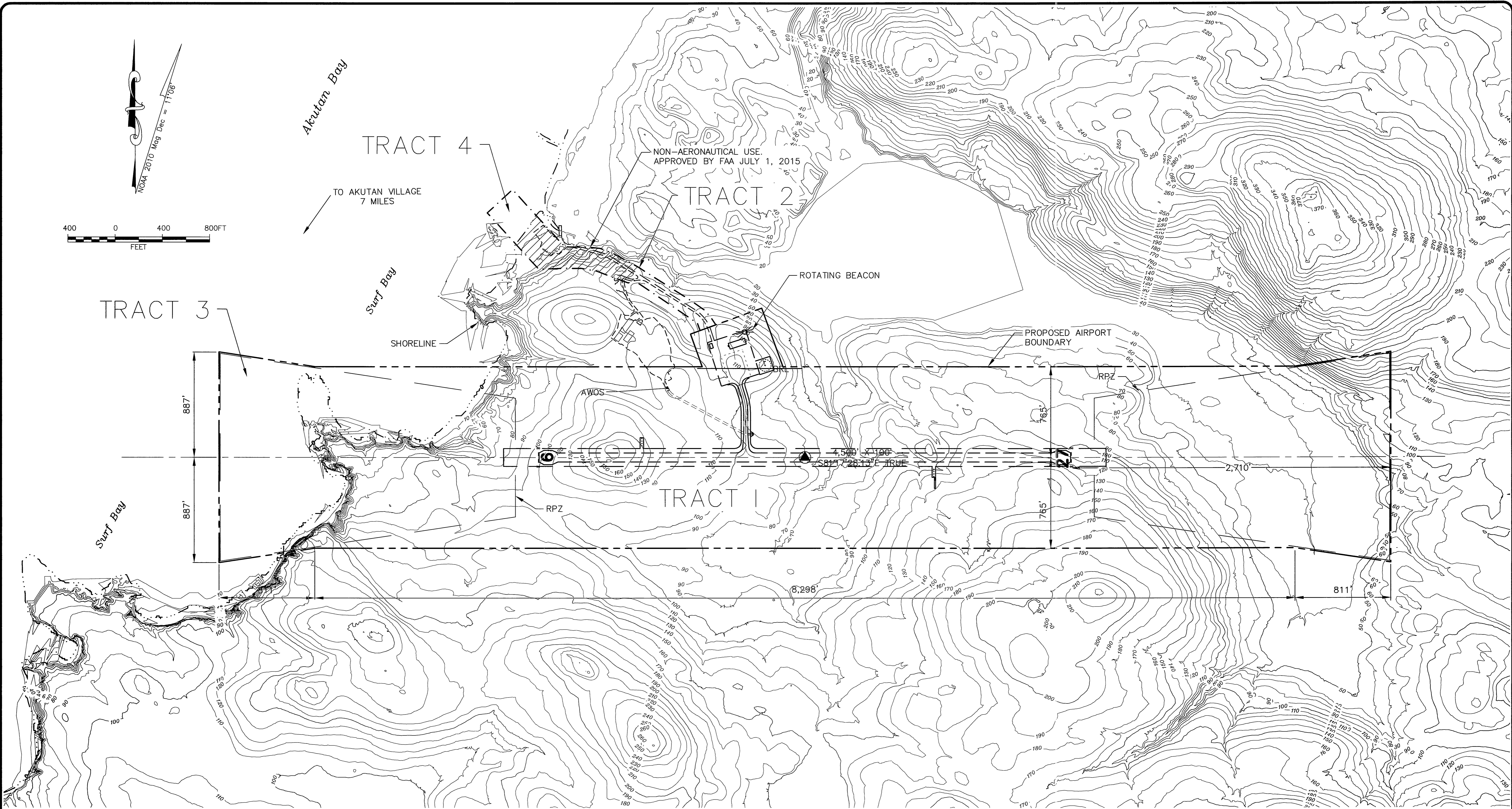

ID #	INTEREST	GRANTOR	GRANTEE	PARCEL SIZE	DATE ACQUIRED	RECORDED DOC NO.	ACQUIRED AIP NO.
1	FEE SIMPLE	AKUTAN CORP.	SOA DOT&PF	313.335 ac	2011	2011-000443-0	3-02-0005-002-2010
2	FEE SIMPLE	AKUTAN CORP.	SOA DOT&PF	6.563 ac	2011	2011-000443-0	3-02-0005-002-2010
3	ILMA	DNR	SOA DOT&PF			ADL# 230568	
4	ILMA	DNR	SOA DOT&PF			ADL# 230568	

BY	DATE	REVISION
	07/2015	UPDATE ACCESS ROAD LAND USE AND ADD AIRPORT TERMINAL
	10/2014	AS-BUILT PER AKSAS 51196

STATE OF ALASKA
DEPARTMENT OF TRANSPORTATION
AND PUBLIC FACILITIES
CENTRAL REGION

AKUTAN AIRPORT
 AKUTAN, ALASKA
 AIRPORT LAYOUT PLAN
 AIRPORT PROPERTY MAP

DATE:	04/27/12
SHEET:	9
	OF
	9