

12/8/2015 10:58 AM

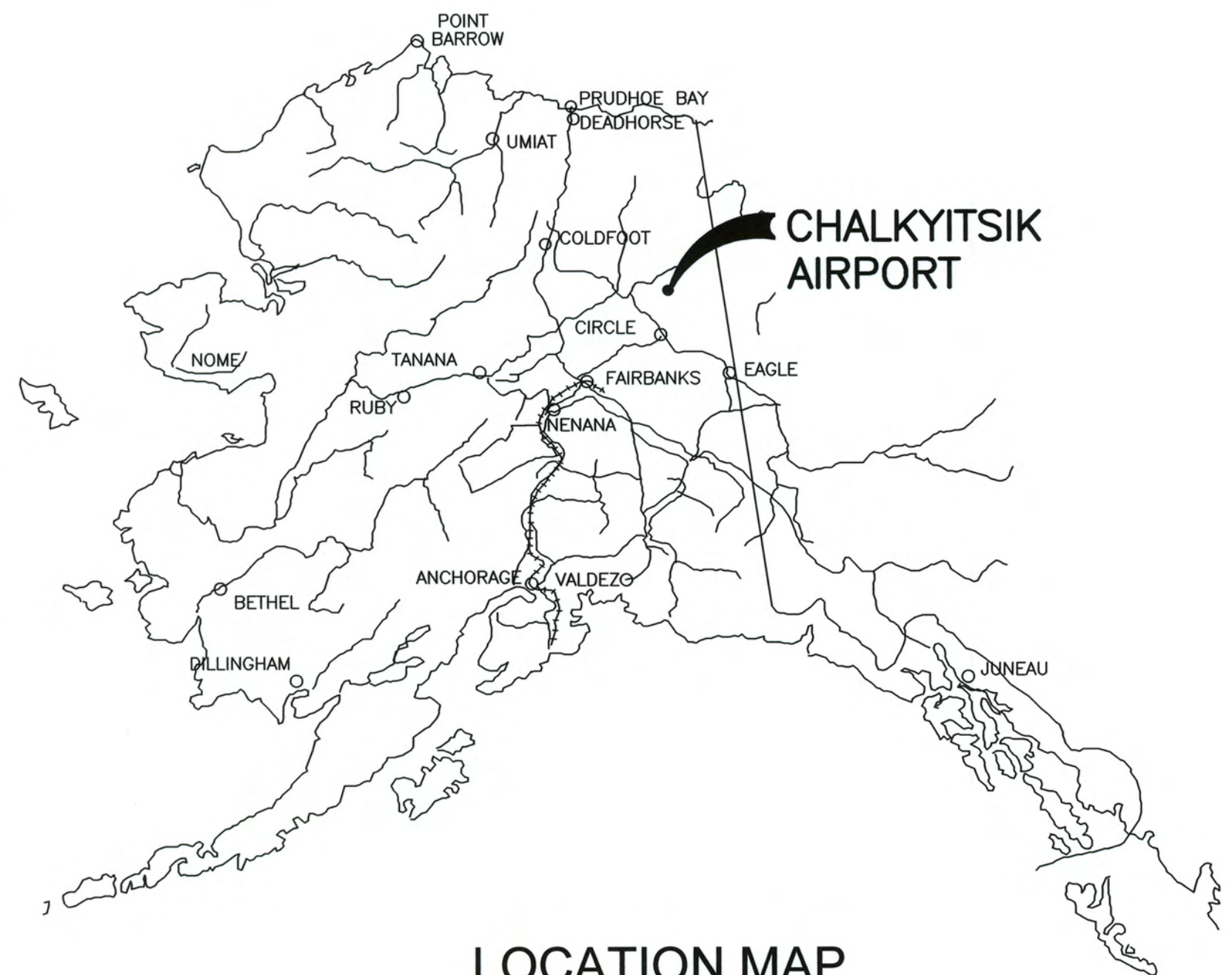

LOCATION MAP

CHALKYITSIK, ALASKA AIRPORT LAYOUT PLAN CHALKYITSIK AIRPORT

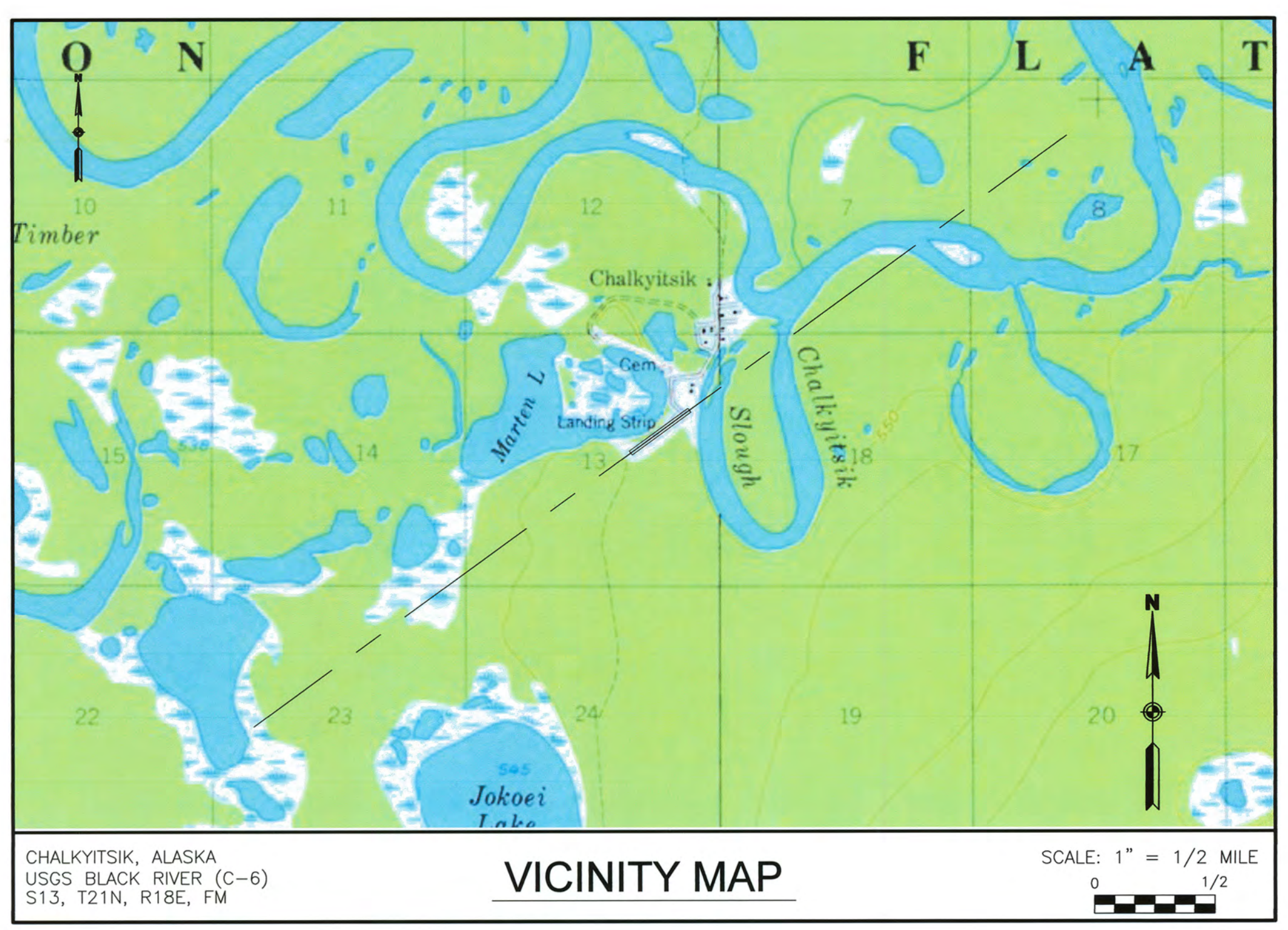

VICINITY MAP

LEGEND		
ITEM	EXISTING	ULTIMATE
ANTENNA		
AIRPORT REFERENCE POINT		
BUILDING		
BUILDING RESTRICTION LINE		
BUSH		
TREE		
CENTER LINE		
CONTOUR		
FUEL TANK		
FENCE		
LIGHTING		
PART 77 APPROACH SURFACE		
PROPERTY LINE		
ROADWAY (GRAVEL)		
ROTATING BEACON		
RUNWAY (GRAVEL)		
RUNWAY OBJECT FREE AREA		
RUNWAY OBSTACLE FREE ZONE		
RUNWAY SAFETY AREA		
RUNWAY SHOULDER		
RUNWAY PROTECTION ZONE		
SATELLITE DISH		
SURVEY MONUMENT		
TAXIWAY (GRAVEL)		
THRESHOLD SITING SURFACE		
WATERBODY		
WIND CONE		

SHEET INDEX	
SHEET NO.	DESCRIPTION
1	COVER
2	AIRPORT DATA
3	EXISTING/ULTIMATE AIRPORT LAYOUT PLAN
4	EXISTING/ULTIMATE INNER PORTION OF APPROACH SURFACE
5	AIRPORT AIRSPACE (FAR PART 77)

U:\204700168\Chalkyitsik Airport\Dwgs\C\Sheets\1309900CIK_ALP01-ALP01

DESIGN MMM
DRAWN RWW
CHECKED JGL

STATE OF ALASKA
DEPARTMENT OF TRANSPORTATION AND PUBLIC FACILITIES
NORTHERN REGION-AVIATION

APPROVED: Albert M.L. Beck DATE 12/2/15
ALBERT M.L. BECK, P.E. DESIGN GROUP CHIEF

AIRPORT LAYOUT PLAN CONDITIONAL APPROVAL SUBJECT TO
ALP APPROVAL LETTER DATED 1/6/1998
FAA AIRSPACE REVIEW NUMBER: N/A

P.J. Zettler AS-BUILT ALP DATE 2/18/16
FAA, AIRPORTS DIVISION ALASKAN REGION, AAL- 62-1

BY	DATE	REVISIONS
DAF	12/2/15	AS-BUILT

CHALKYITSIK AIRPORT
CHALKYITSIK, ALASKA
COVER

SHEET
1 OF
5

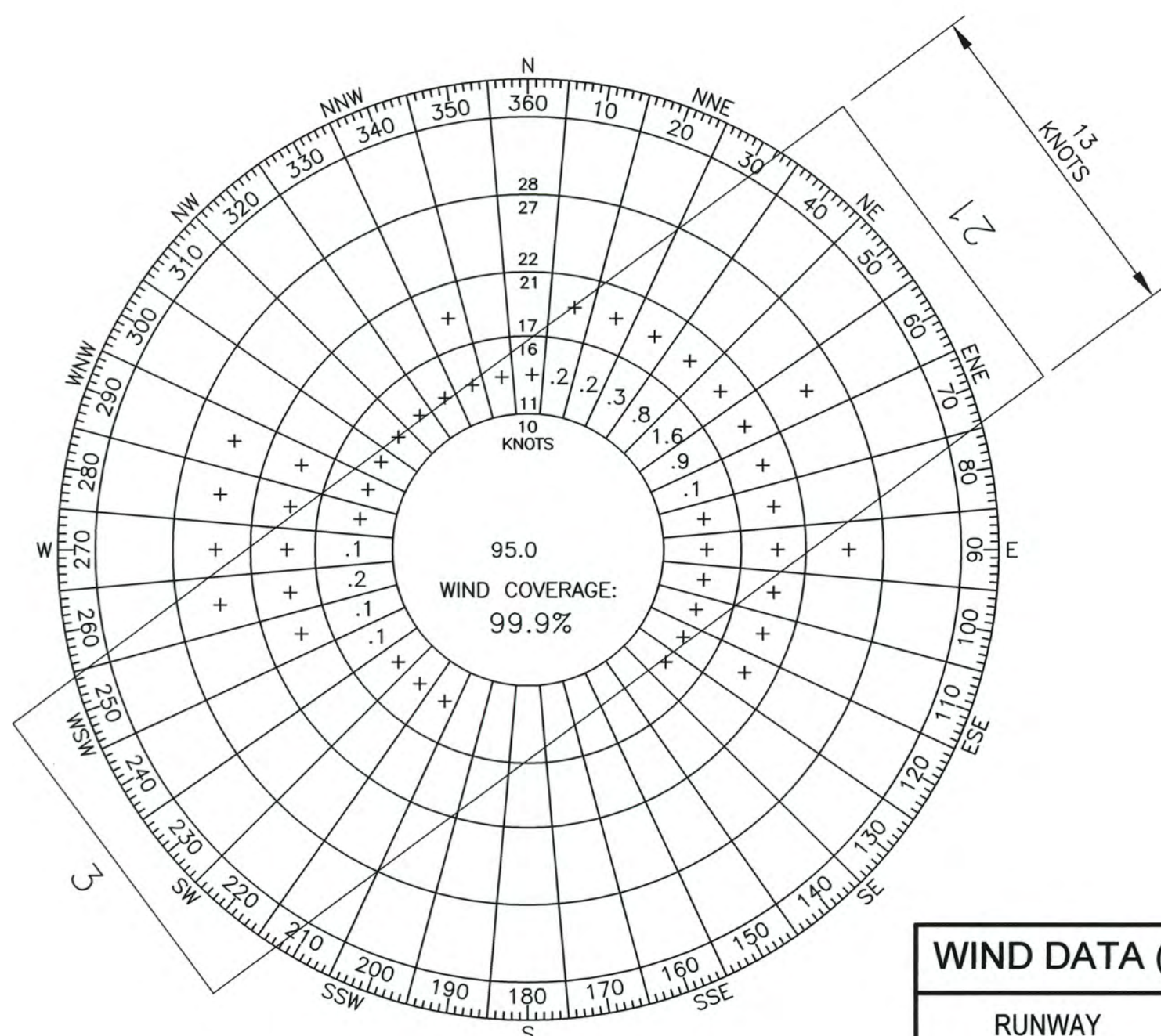

WIND DATA (ALL WEATHER)	
RUNWAY	13 kt (B-II)
3/21	99.9%

ALL-WEATHER

SOURCE: NCDC ISH/ISD
STATION NAME: FORT YUKON
PERIOD: 2005-2014

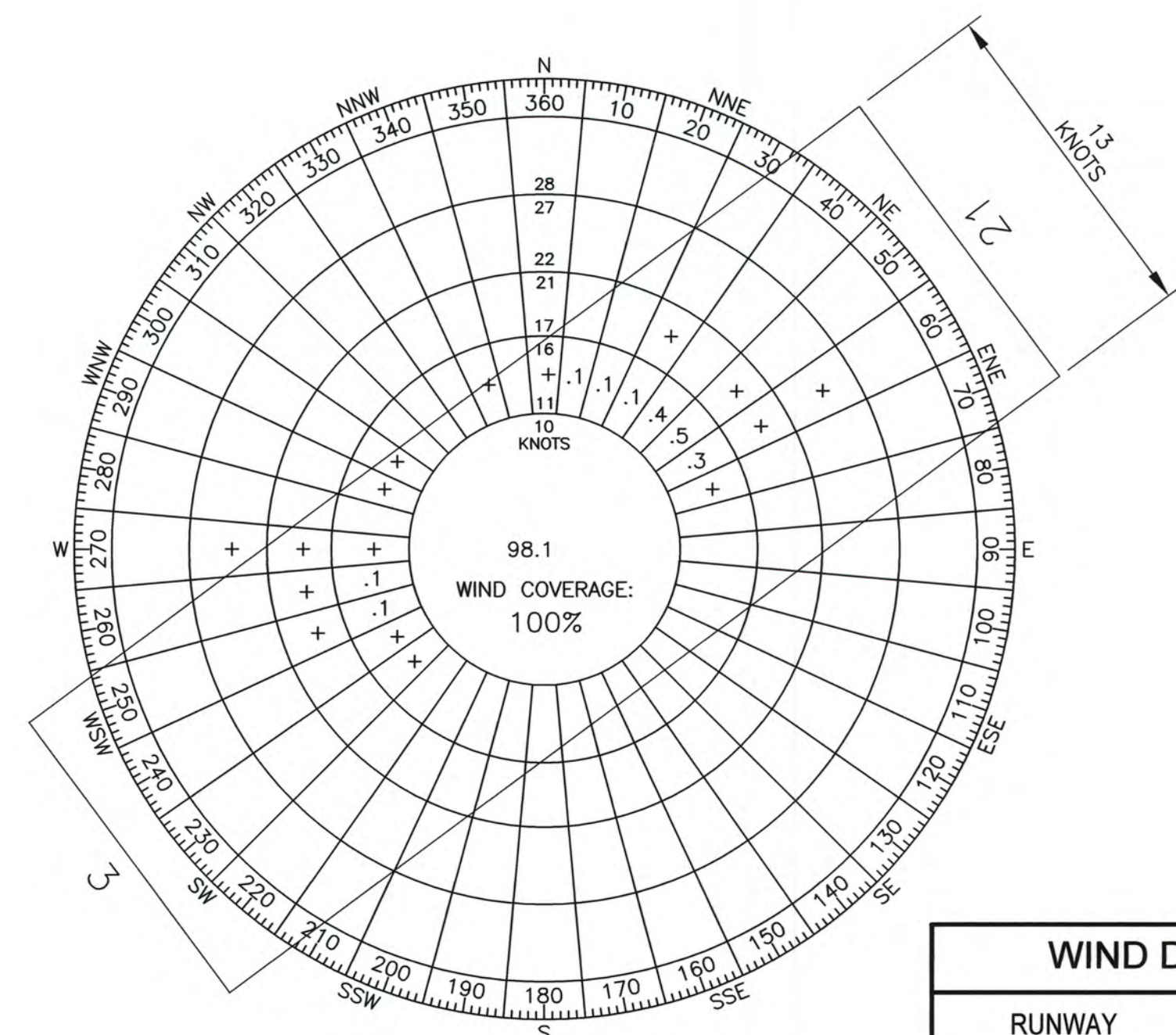

WIND DATA (IMC)	
RUNWAY	13 kt (B-II)
3/21	100%

INSTRUMENT METEOROLOGICAL CONDITION

SOURCE: NCDC ISH/ISD
STATION NAME: FORT YUKON
PERIOD: 2005-2014

AIRPORT DATA		
ITEM	EXISTING	ULTIMATE
ICAO IDENTIFIER	PACI	SAME
NATIONAL AIRPORT IDENTIFIER	CIK	SAME
FAA SITE NUMBER	50092.*A	SAME
AIRPORT REFERENCE CODE (ARC)	B-II	SAME
NPIAS SERVICE LEVEL (P, CS, R, GA)	GA	SAME
AASP CLASSIFICATION	COMMUNITY OFF-ROAD	SAME
AIRPORT ELEVATION (NAVD88)	548.5'	SAME
MEAN MAX. TEMPERATURE, HOTTEST MONTH	74.8°F, JULY	SAME
OBSTRUCTION SURVEY SOURCE & TYPE	AOC (SEE NOTES)	SAME
MAGNETIC DECLINATION, YEAR, RATE OF CHANGE	20°12'06"E, 2015 0°29'W / YEAR	SAME
AIRPORT AND TERMINAL NAVIGATION AIDS	LIGHTED WINDCONE, ROTATING BEACON	SAME

RUNWAY 3/21 DATA		
ITEM	EXISTING	ULTIMATE
FAR PART 77 APPROACH CATEGORY (UTILITY, OTHER THAN UTILITY)	UTILITY	SAME
FAR PART 77 APPROACH TYPE (V, C, NPA, PA)	NPA	SAME
AERONAUTICAL SURVEY TYPE	VERTICALLY GUIDED	SAME
RUNWAY DESIGN CODE (RDC)	B-II-5000	SAME
RUNWAY REFERENCE CODE (RRC)	B-II-5000	SAME
DESIGN AIRCRAFT	BCH-200	SAME
FAR PART 77 APPROACH SLOPE	20:1	SAME
THRESHOLD SITING SURFACE SLOPE	20:1	SAME
VISIBILITY MINIMUM	≥1 SM	SAME
RUNWAY SURFACE	GRAVEL	SAME
PAVEMENT STRENGTH (SW, DW, DTW x1000lbs)	N/A	SAME
TRUE MEAN BEARING	N 53°25'48" E	SAME
MAXIMUM ELEVATION ABOVE MSL	548.5'	SAME
EFFECTIVE GRADE	0.5%	SAME
RUNWAY TOUCHDOWN ZONE ELEVATIONS (NAVD 88)	RW 3: 542.2'	SAME
	RW 21: 548.5'	SAME
DISPLACED THRESHOLD RW 21 ELEV. (NAVD 88)	545.35'	SAME
RUNWAY DIMENSIONS	75' x 4000'	SAME
RUNWAY SAFETY AREA (RSA) DIMENSIONS	150' x 4600'	SAME
RSA LENGTH BEYOND RW ENDS	300'	SAME
RUNWAY PROTECTION ZONE (RPZ) DIMENSIONS	250' x 450' x 1000'	SAME
RUNWAY OBJECT FREE AREA (OFA) DIMENSIONS	500' x 4600'	SAME
ROFA LENGTH BEYOND RW ENDS	300'	SAME
RUNWAY OBSTACLE FREE ZONE (OFZ) DIMENSIONS	250' x 4400'	SAME
PRECISION OBSTACLE FREE ZONE (POFZ) DIMENSIONS	N/A	SAME
RUNWAY LIGHTING TYPE	MIRL	SAME
RUNWAY MARKING TYPE (P, NP, NONE)	NONE	SAME
RUNWAY VISUAL APPROACH AIDS	NONE	SAME
RUNWAY LANDING AIDS	RNAV/GPS	SAME

MODIFICATION TO STANDARDS					
DESCRIPTION	STANDARD	EXISTING	ULTIMATE	AIRSPACE #	APPROVAL DATE
NONE					

DECLARED DISTANCES					
	RUNWAY	TORA	TODA	ASDA	LDA
EXISTING	3	4000'	4000'	4000'	4000'
	21	4000'	4000'	4000'	3500'
ULTIMATE	3	SAME	SAME	SAME	SAME
	21	SAME	SAME	SAME	SAME

NON-STANDARD CONDITIONS			
ITEM	STANDARD	EXISTING	ULTIMATE
RUNWAY CENTERLINE TO APRON OFFSET	250'	135'	SAME
RW 21 DISPLACED THRESHOLD LIGHTS	ALIGNED	22' OFFSET	SAME
STRUCTURES WITHIN BRL	NONE	SREB	SAME
SEWAGE LAGOON SEPARATION	5000'	400'	SAME
SEWAGE LAGOON SEPARATION	5000'	2500'	SAME
LANDFILL SEPARATION	5000'	2900'	SAME

- NOTES**
- THIS ALP DRAWING SET IS UPDATED BASED ON AN AIRPORT OBSTRUCTION CHART SURVEY (AOC) COMPLETED BY USKH INC. IN 2011 IN ACCORDANCE WITH FAA AC 150/5300-18B. THIS ALP WAS UPDATED IN ACCORDANCE WITH FAA AC 150/5300-13A AND 150/5070-6B IN JANUARY 2014.
 - VERTICAL DATUM IS NAVD 1988 USING GEOID12A AND REFERENCING PACS "CIK A"
 - HORIZONTAL DATUM IS NAD83 (2011). DRAWING COORDINATES ARE ALASKA STATE PLANE ZONE 2, U.S. SURVEY FEET, UNLESS NOTED OTHERWISE.
 - WIND ROSE WAS GENERATED USING DATA MEASURED AT FORT YUKON, ALASKA. WIND PATTERNS THEREFORE MAY VARY FROM THOSE AT CHALKYITSIK AIRPORT.

PACS & SACS							
DESIGNATION	LATITUDE	LONGITUDE	ELLIPSOID HEIGHT	NORTHING	EASTING	ELEVATION	DESCRIPTION
CIK A	66°38'43.37"N	143°44'08.89"W	562.02	4625378.66	1388444.83	544.39	PACS
CIK B	66°38'54.75"N	143°43'50.95"W	565.40	4626513.91	1389200.24	547.74	SACS
CIK C	66°38'39.61"N	143°44'42.78"W	557.92	4625034.29	1387068.12	540.29	SACS

GEOGRAPHIC COORDINATES (NAD 83) & ELEVATIONS (NAVD 88)						
ITEM	EXISTING LATITUDE	EXISTING LONGITUDE	EXISTING ELEVATION	ULTIMATE LATITUDE	ULTIMATE LONGITUDE	ULTIMATE ELEVATION
AIRPORT REFERENCE POINT	66°38'42.09"N	143°44'23.62"W	N/A	SAME	SAME	SAME
RUNWAY 3 END	66°38'30.37"N	143°45'03.46"W	528.70'	SAME	SAME	SAME
RUNWAY 21 END	66°38'53.80"N	143°43'43.77"W	548.50'	SAME	SAME	SAME
RUNWAY 21 DISPLACED THRESHOLD	66°38'50.87"N	143°43'53.74"W	545.35'	SAME	SAME	SAME

TAXIWAY DATA		
ITEM	EXISTING	ULTIMATE
TAXIWAY DESIGN GROUP	2	SAME
TAXIWAY DIMENSIONS	35' x 95'	SAME
TAXIWAY SHOULDER WIDTH	10'	SAME
SEPARATION FROM PARALLEL RUNWAY	N/A	SAME
TAXIWAY SAFETY AREA (TSA) WIDTH	79'	SAME
TAXIWAY OBJECT FREE AREA (TOFA) WIDTH	131'	SAME
TAXIWAY LIGHTING	MITL	SAME
TAXIWAY MARKING	NONE	SAME

U:\204700168\Chalkyitsik Airport\Dwgs\C\Sheets\1309900CIK_ALP02-ALP02

DESIGN MMM
DRAWN RWW
CHECKED JGL

STATE OF ALASKA
DEPARTMENT OF TRANSPORTATION AND PUBLIC FACILITIES
NORTHERN REGION-AVIATION

APPROVED: Albert M.L. Beck DATE 12/21/15
ALBERT M.L. BECK, P.E. DESIGN GROUP CHIEF

BY	DATE	REVISIONS	FAA
AS-BUILT	12/21/15		

BY	DATE	REVISIONS	FAA

CHALKYITSIK AIRPORT
CHALKYITSIK, ALASKA
AIRPORT DATA

SHEET
2 OF
5

U:\204700168\Chalkyitsik Airport\Drawings\C\Drawings\13099000\ALP03-ALP03

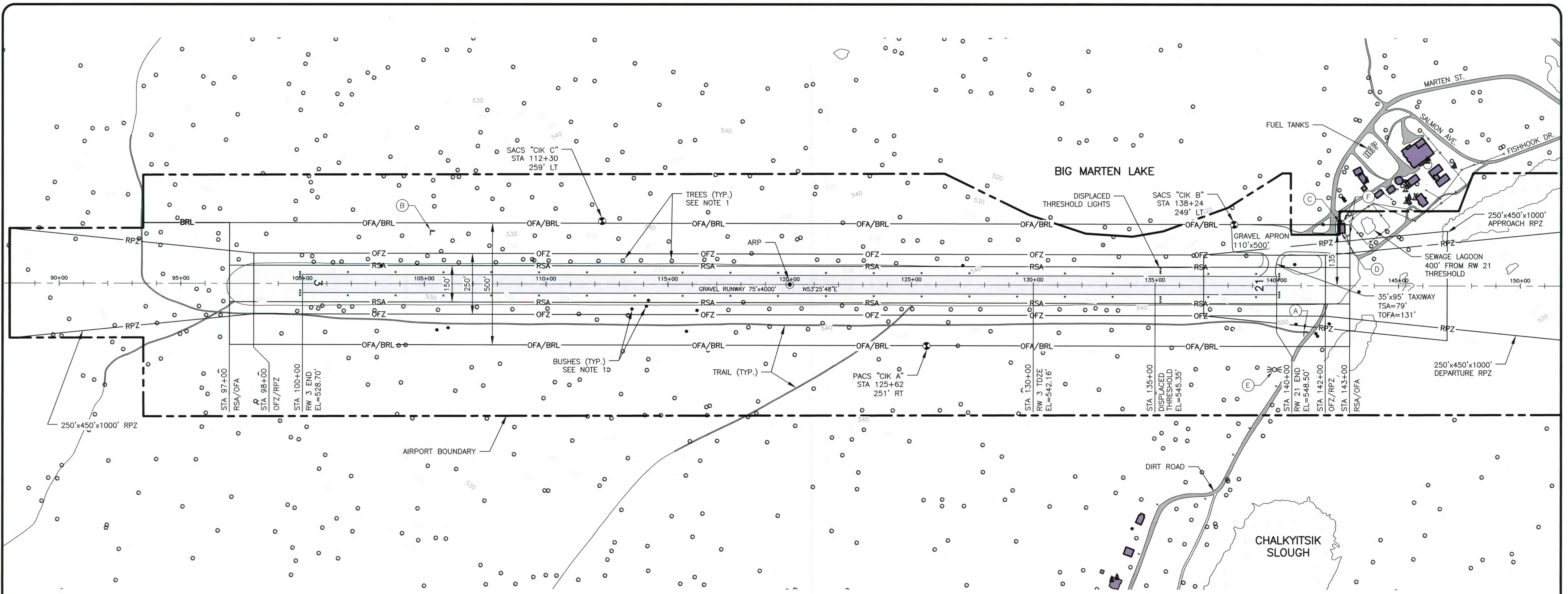

DECLARED DISTANCES				
RUNWAY	TORA	TODA	ASDA	LDA
3	4000'	4000'	4000'	4000'
21	4000'	4000'	4000'	3500'

BUILDINGS/FACILITIES			
BLD/FAC	DESCRIPTION	STATION/OFFSET	TOP ELEV.
(A)	LIGHTED WINDCONE W/OBST. LIGHTING	141+11/208' RT	571.9'
(B)	WINDCONE	105+25/200' LT	546.1'
(C)	ELECTRICAL EQUIPMENT BUILDING	142+64/234' LT	561.0'
(D)	SREB	142+58/264' LT	573.1'
(E)	ROTATING BEACON	139+91/345' RT	591.7'
(F)	FUEL TANKS	142+95/207' LT	565.2'

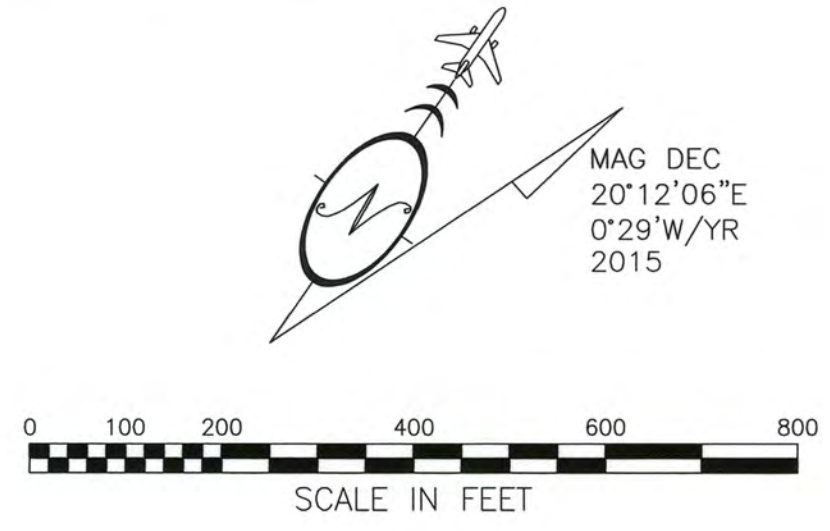

NOTES:
 1. OFZ PENETRATIONS CONSIST OF TREES AND BUSHES ALONG BOTH SIDES OF RW 3/21. PENETRATIONS RANGE FROM 1' TO 17'.

DESIGN MMM
 DRAWN RWW
 CHECKED JGL

STATE OF ALASKA
 DEPARTMENT OF TRANSPORTATION AND PUBLIC FACILITIES
 NORTHERN REGION-AVIATION

APPROVED: Albert M.L. Beck, P.E. DATE 12/21/15
 ALBERT M.L. BECK, P.E. DESIGN GROUP CHIEF

BY	DATE	AS-BUILT	REVISIONS	FAA

BY	DATE	REVISIONS	FAA

CHALKYITSIK AIRPORT
 CHALKYITSIK, ALASKA
 AIRPORT LAYOUT PLAN

SHEET
 3 OF 5

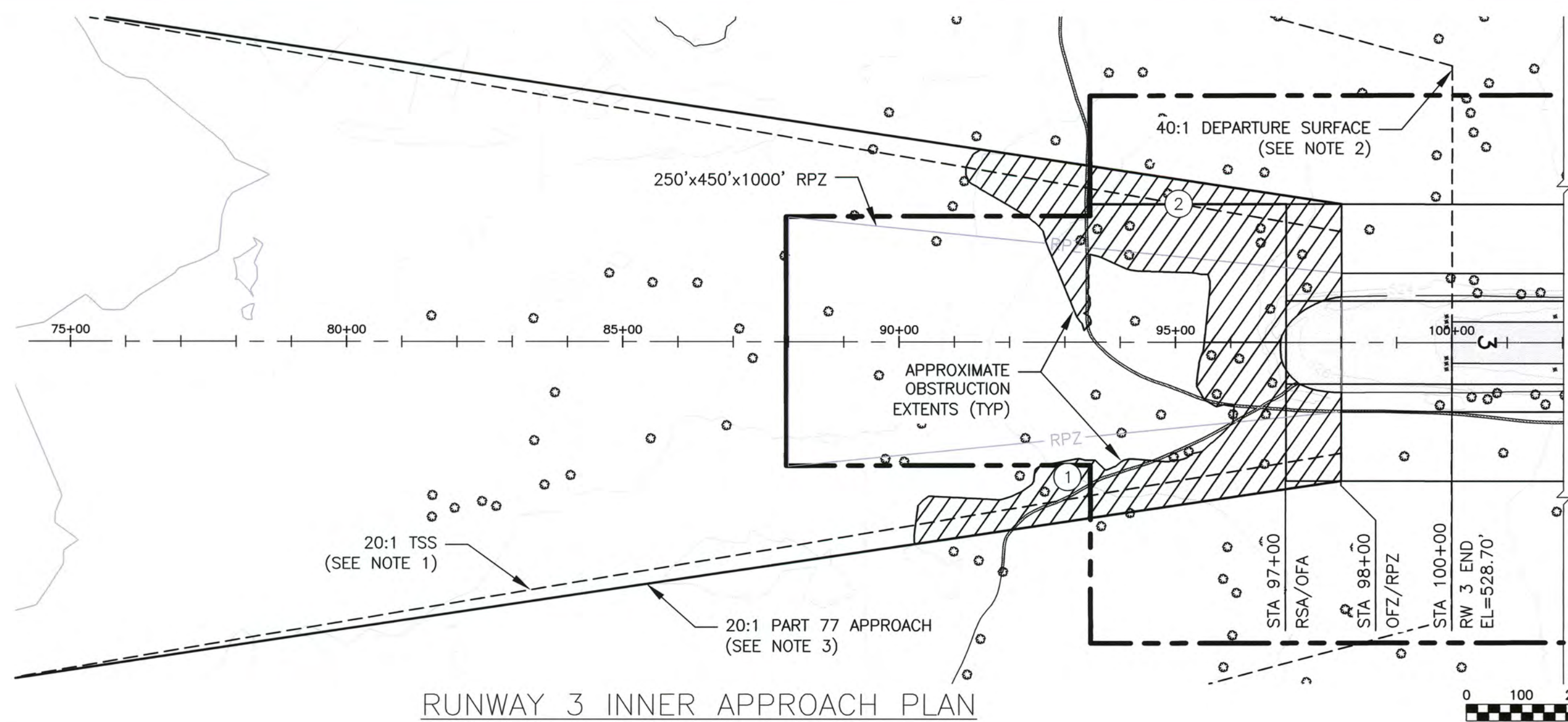

RUNWAY 3 INNER APPROACH PLAN

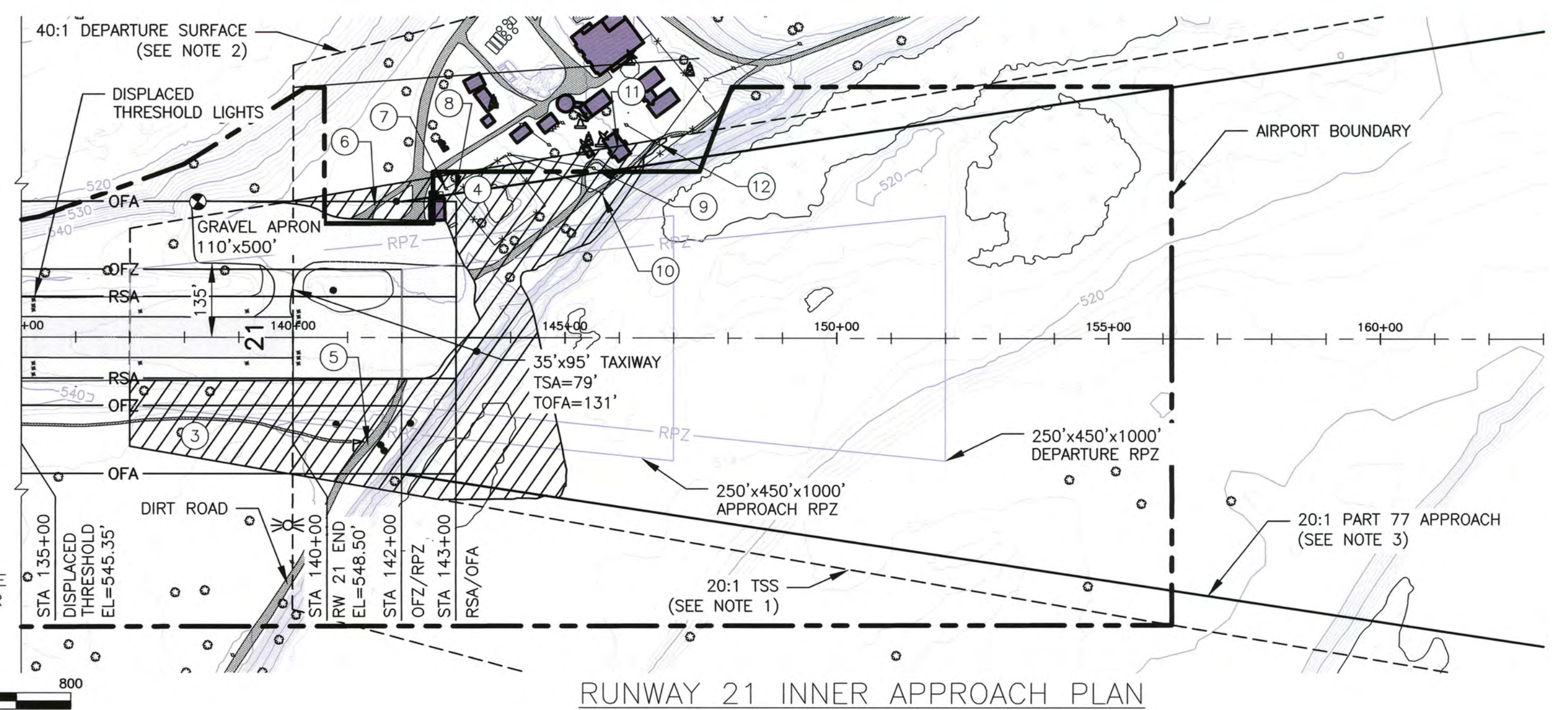

RUNWAY 21 INNER APPROACH PLAN

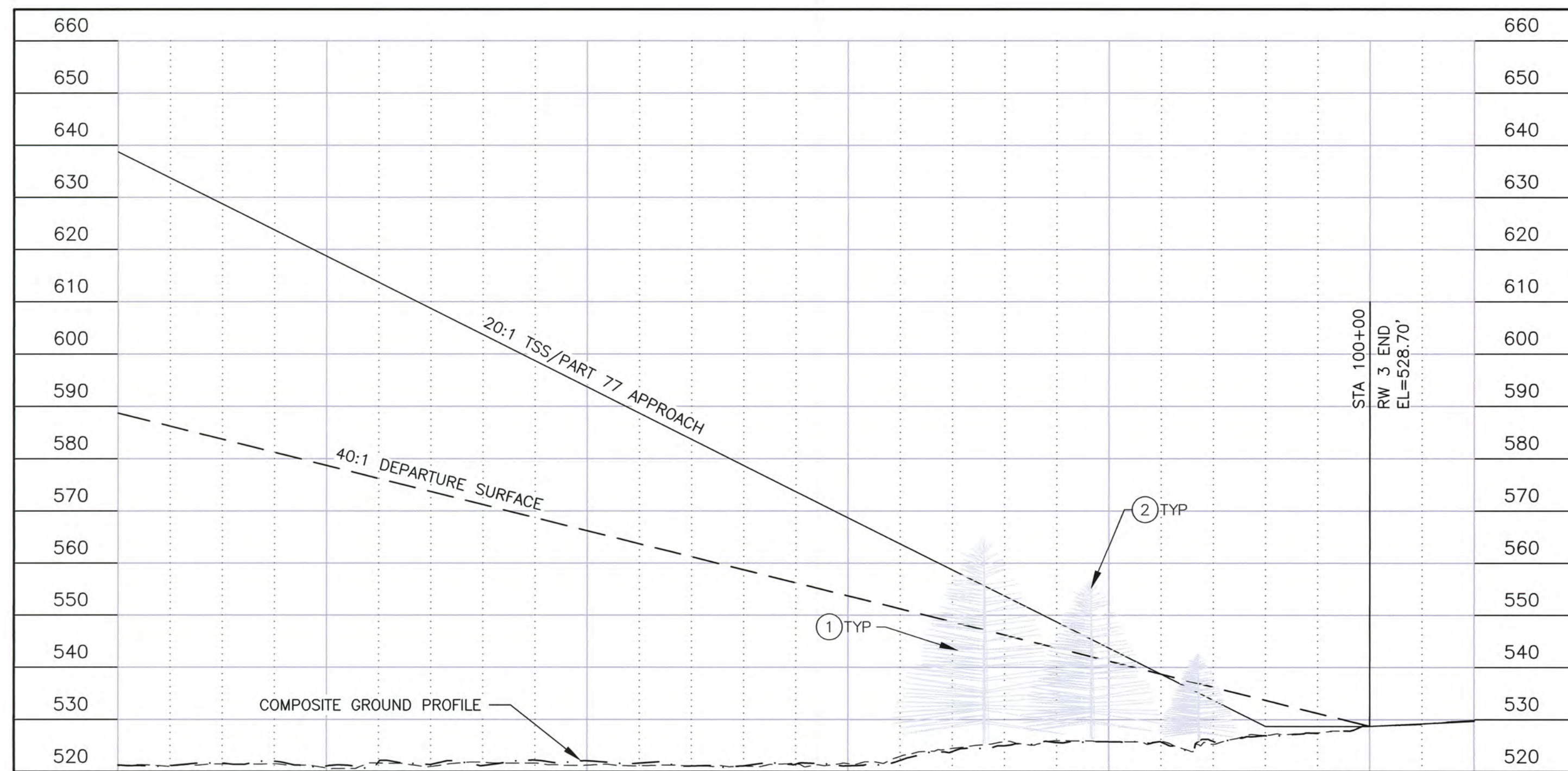
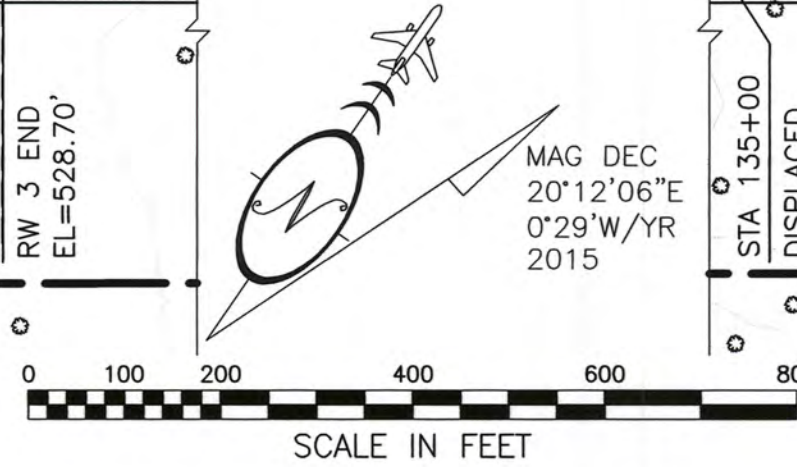

RUNWAY 3 INNER APPROACH PROFILE

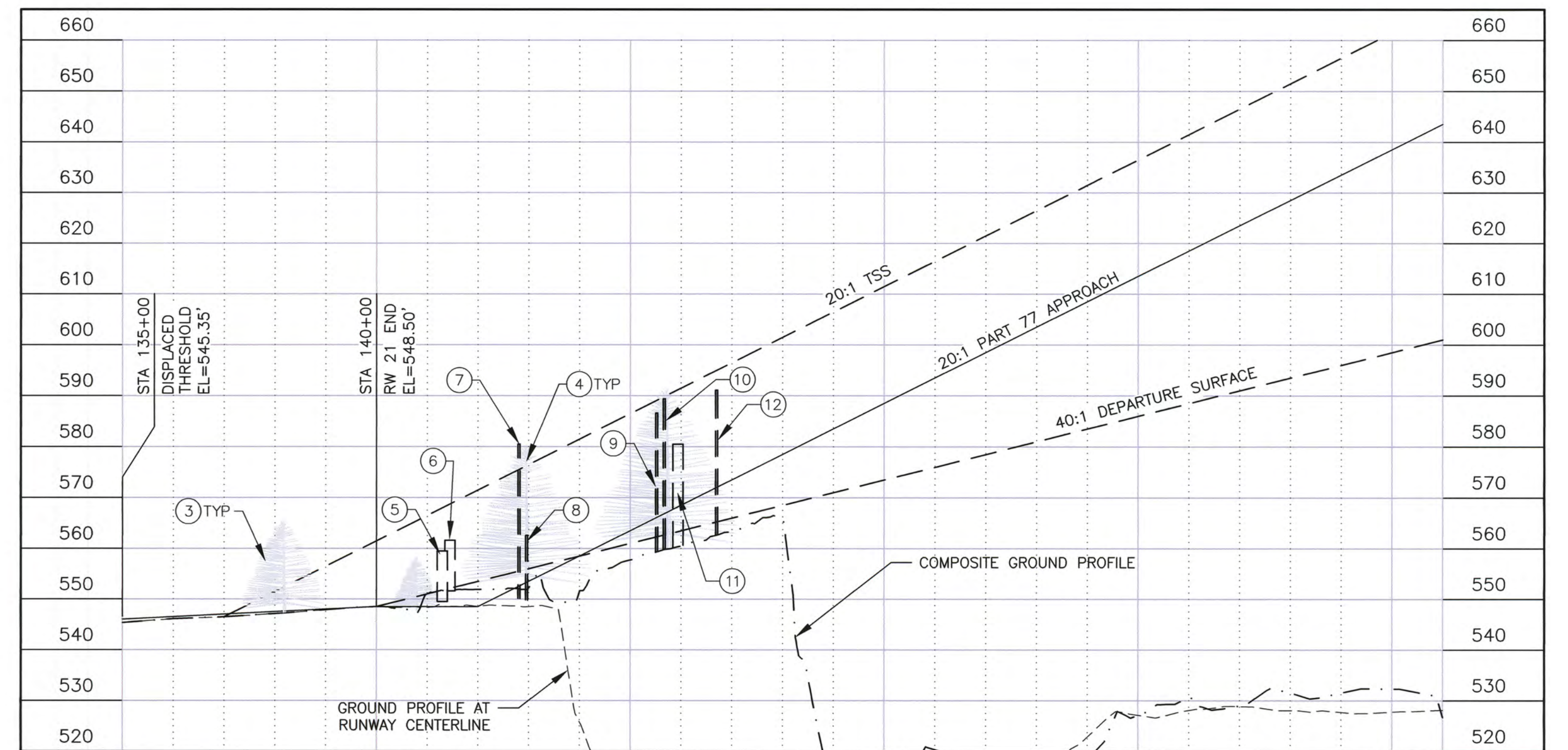

RUNWAY 21 INNER APPROACH PROFILE

OBSTRUCTION TABLE (INNER PORTION R/W 3)							
ID #	DESCRIPTION	STATION/OFFSET	ELEV.	SURFACE ELEV.	SURFACE PENETRATED	SURFACE PENETRATION	DISPOSITION
1	TREES/BUSHES (HP)	92+64/270' RT	562.6'	555.5'	TSS/PART 77	7'	REMOVE
2	TREES/BUSHES (HP)	94+87/270' LT	556.1'	544.4'	TSS/PART 77	12'	REMOVE

GENERAL NOTES:

- TSS DIMENSION = 400'x3800'x10000', SLOPE EXTENDS 10000' AT 20:1
- DEPARTURE SURFACE DIMENSION = 1000'x6466'x10200', SLOPE EXTENDS 10200' AT 40:1
- PART 77 APPROACH SURFACE DIMENSION = 500'x2000'x5000', SLOPE EXTENDS 5000' AT 20:1
- PART 77 ROAD OBSTRUCTION HEIGHTS ARE INCLUDED (10' FOR PRIVATE ROAD & 15' FOR PUBLIC ROAD)
- R/W 3 HAS OBSTACLE FREE ZONE & THRESHOLD SITING SURFACE PENETRATIONS.
- R/W 21 HAS OBSTACLE FREE ZONE & THRESHOLD SITING SURFACE PENETRATIONS.
- HP=HIGH POINT OF TREE/BUSH OBSTRUCTIONS

OBSTRUCTION TABLE (INNER PORTION R/W 21)								
ID #	DESCRIPTION	STATION/OFFSET	ELEV.	SURFACE ELEV.	SURFACE PENETRATED	SURFACE PENETRATION	DISPOSITION	
3	TREES/BUSHES (HP)	138+19/179' RT	565.9'	547.6'	TSS	18'	REMOVE	
4	TREES/BUSHES (HP)	142+98/294' LT	580.3'	557.8'	TSS	23'	REMOVE	
5	ROAD +10'	141+30/208' RT	559.5'	548.5'	DEPARTURE	11'	TO REMAIN	
6	ROAD +10'	141+45/237' LT	561.6'	548.5'	DEPARTURE	13'	TO REMAIN	
7	UTILITY POLE	142+81/274' LT	580.5'	575.6'	TSS	5'	TO REMAIN	
8	FENCE	142+96/263' LT	562.6'	553.3'	DEPARTURE	9'	TO REMAIN	
9	UTILITY POLE	145+52/312' LT	586.6'	567.0'	PART 77	20'	TO REMAIN	
10	UTILITY POLE	145+67/266' LT	589.4	566.9'	PART 77	23'	TO REMAIN	
11	BUILDING/VENT	145+94/349' LT	580.5'	573.5'	PART 77 (TRANS)	7'	TO REMAIN	
12	UTILITY POLE	146+70/258' LT	591.1'	577.3'	PART 77 (TRANS)	14'	TO REMAIN	

U:\204700168\Chalkyitsik Airport\Drawings\13099000\ALP04-ALP04

DESIGN MMM
 DRAWN RWW
 CHECKED JGL

STATE OF ALASKA
 DEPARTMENT OF TRANSPORTATION AND PUBLIC FACILITIES
 NORTHERN REGION-AVIATION

APPROVED: *Albert M.L. Beck* DATE 12/21/15
 ALBERT M.L. BECK, P.E. DESIGN GROUP CHIEF

BY	DATE	REVISIONS	FAA
DAP	12/21/15	AS-BUILT	

BY	DATE	REVISIONS	FAA
----	------	-----------	-----

CHALKYITSIK AIRPORT
 CHALKYITSIK, ALASKA
 EXISTING/ULTIMATE
 INNER PORTION OF APPROACH SURFACE

SHEET
 4 OF
 5

U:\204700168\Chalkyitsik Airport\Drawings\1309900CIK_ALP05-ALP05

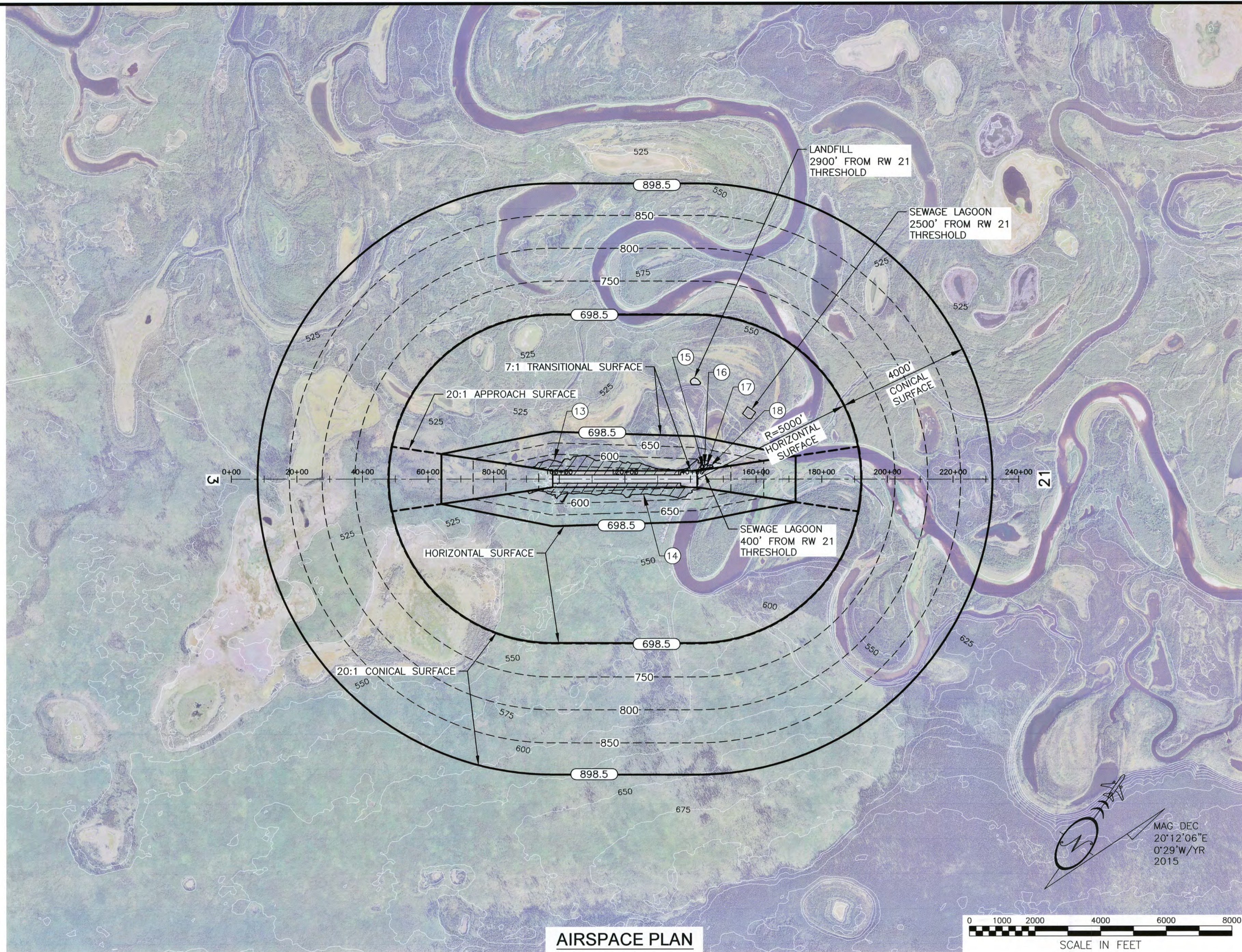

AIRSPACE PLAN

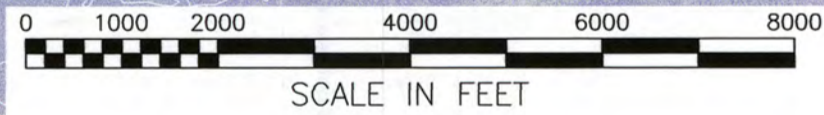

LEGEND

	AIRSPACE ELEVATION (SURFACE DIVIDERS)
	AIRSPACE SURFACE DIVIDERS (NON-CONTROLLING)
	AIRSPACE ELEVATION (50' INCREMENTS)
	EXISTING GROUND ELEVATIONS
	RUNWAY CENTERLINE (EXTENDED)
	AIRSPACE OBSTRUCTION AREA

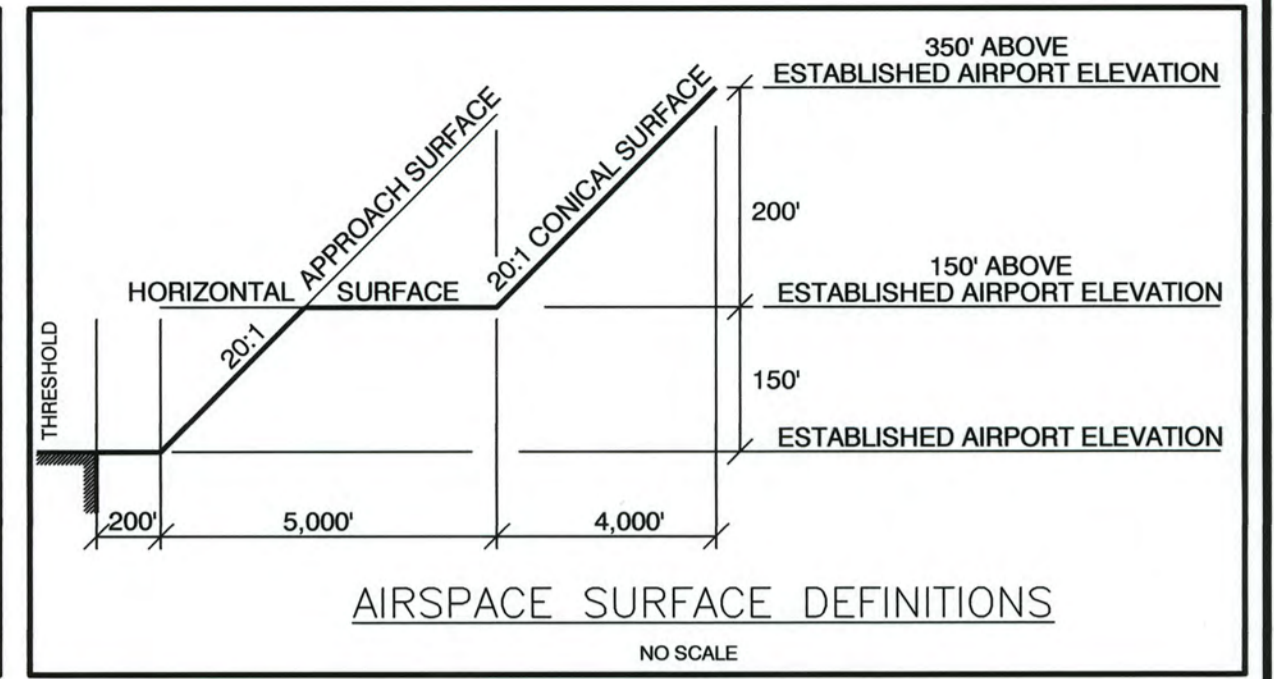

**ULTIMATE RUNWAY FAR PART 77 DIMENSIONS
UTILITY, NPA, >1 S.M.**

DESCRIPTION	DIMENSION
ESTABLISHED AIRPORT ELEVATION	548.5'
RUNWAY END ELEVATION	RW 3: 528.7' \ RW 21: 548.5'
PRIMARY SURFACE	500' x 4400'
HORIZONTAL SURFACE ELEVATION	698.5'
HORIZONTAL SURFACE RADIUS	5000'
APPROACH SURFACE	500' x 2000' x 5000'
APPROACH SURFACE SLOPE	20:1
CONICAL SURFACE WIDTH	4000' @ 20:1
TRANSITIONAL SURFACE SLOPE	7:1

FAR PART 77 SURFACE OBSTRUCTION TABLE

ID #	DESCRIPTION	STATION/OFFSET	ELEV.	SURFACE PENETRATED	SURFACE ELEV.	SURFACE PENETRATION	DISPOSITION
13	TREES/BUSHES	LEFT SIDE, RW 3/21	(VARIES)	TRANSITIONAL	(VARIES)	23'-45'	REMOVE
14	TREES/BUSHES	RIGHT SIDE, RW 3/21	(VARIES)	TRANSITIONAL	(VARIES)	29'-54'	REMOVE
15	UTILITY POLE	143+98/337' LT	589.4'	TRANSITIONAL	566.6'	23'	TO REMAIN
16	UTILITY POLES (2)	144+20/392' LT	582.1'	TRANSITIONAL	575.0'	7'	TO REMAIN
17	UTILITY POLES (4)	144+95/396' LT	590.7'	TRANSITIONAL	577.7'	13'	TO REMAIN
18	UTILITY POLE	146+13/391' LT	583.9'	TRANSITIONAL	580.4'	4'	TO REMAIN

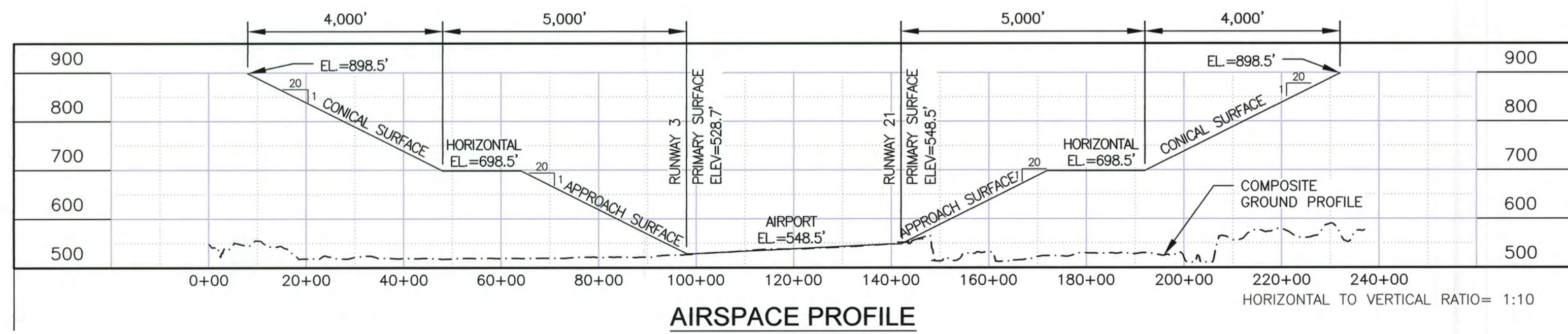

AIRSPACE PROFILE

NOTES:

- REFER TO INNER PORTION OF APPROACH SURFACE (SHEET 4) FOR CLOSE IN OBSTRUCTIONS ANALYZED WITH THE TSS AND PART 77 APPROACH SURFACE.
- THERE ARE NO KNOWN HEIGHT RESTRICTIONS.
- REFER TO THE AIRPORT LAYOUT PLAN (SHEET 3) FOR BUILDING LOCATIONS AND ELEVATIONS.
- GROUND SURFACE INFORMATION WAS PROVIDED BY AN AERIAL MAPPING SUBCONTRACTOR. A CAREFUL COMPARISON WITH SURVEYED DATA WAS MADE TO ENSURE THAT ALL INFORMATION MEETS THE ACCURACY REQUIREMENTS ESTABLISHED IN AC 150/5300-18B.

DESIGN MMM
DRAWN RWW
CHECKED JGL

STATE OF ALASKA
DEPARTMENT OF TRANSPORTATION AND PUBLIC FACILITIES
NORTHERN REGION-AVIATION

APPROVED:
ALBERT M.L. BECK, P.E.

DATE 12/21/15
DESIGN GROUP CHIEF

BY	DATE	REVISIONS	FAA
DWP	12/21/15	AS-BUILT	

BY	DATE	REVISIONS	FAA

CHALKYITSIK AIRPORT
CHALKYITSIK, ALASKA
AIRPORT AIRSPACE
(FAR PART 77)

SHEET
5 OF 5