



U.S. Department
of Transportation
**Federal Aviation
Administration**

Alaskan Region Airports Division

222 W. 7th Avenue, #14
Anchorage, Alaska 99513-7587
Tel. (907) 271-5438 / Fax (907) 271-2851

July 22, 2015

Jessica Wuttke
ADOT&PF Central Region
P.O. Box 196900
Anchorage, AK 99513-7587

Dear Ms. Wuttke:

**Platinum Airport
Platinum, Alaska
As-Built Airport Layout Plan (July/2015)
(Original ALP Airspace #2014-AAL-91-NRA)**

We have completed our review of the Platinum Airport As-Built Airport Layout Plan (ALP) dated July, 2015, and find it acceptable for documenting the existing conditions of the airport.

This ALP approval is conditioned on acknowledgement that any future development on airport property requiring Federal environmental approval must receive such written approval from FAA prior to the subject development. This ALP approval is also conditioned on acceptance of the plan under local land use laws. We encourage appropriate agencies to adopt land use and height restrictive zoning based on the plan.

Approval of the plan does not indicate that the United States will participate in the cost of any development proposed. AIP funding requires evidence of eligibility and justification at the time a funding request is ripe for consideration. When construction of any proposed structure or development indicated on the plan is undertaken, such construction requires normal 45-day advance notification to FAA for review in accordance with applicable Federal Aviation Regulations (i.e., Parts 77, 157, 152, etc.). More notice is generally beneficial to ensure that all statutory, regulatory, technical and operational issues can be addressed in a timely manner.

Please attach this letter to the enclosed ALP and retain it in your files for future use

Sincerely,

Pat Zettler, P.E., Lead Engineer
Airports Division

Date Plotted: 15/15/2014, 9:59 AM
 Drawn By: RWC
 Checked By: JRG
 Layout Name: \\fsprojects\platinum\airport\Layout\Plan\ALP Update 2014\final Drawings\COVER.dwg
 File Name:

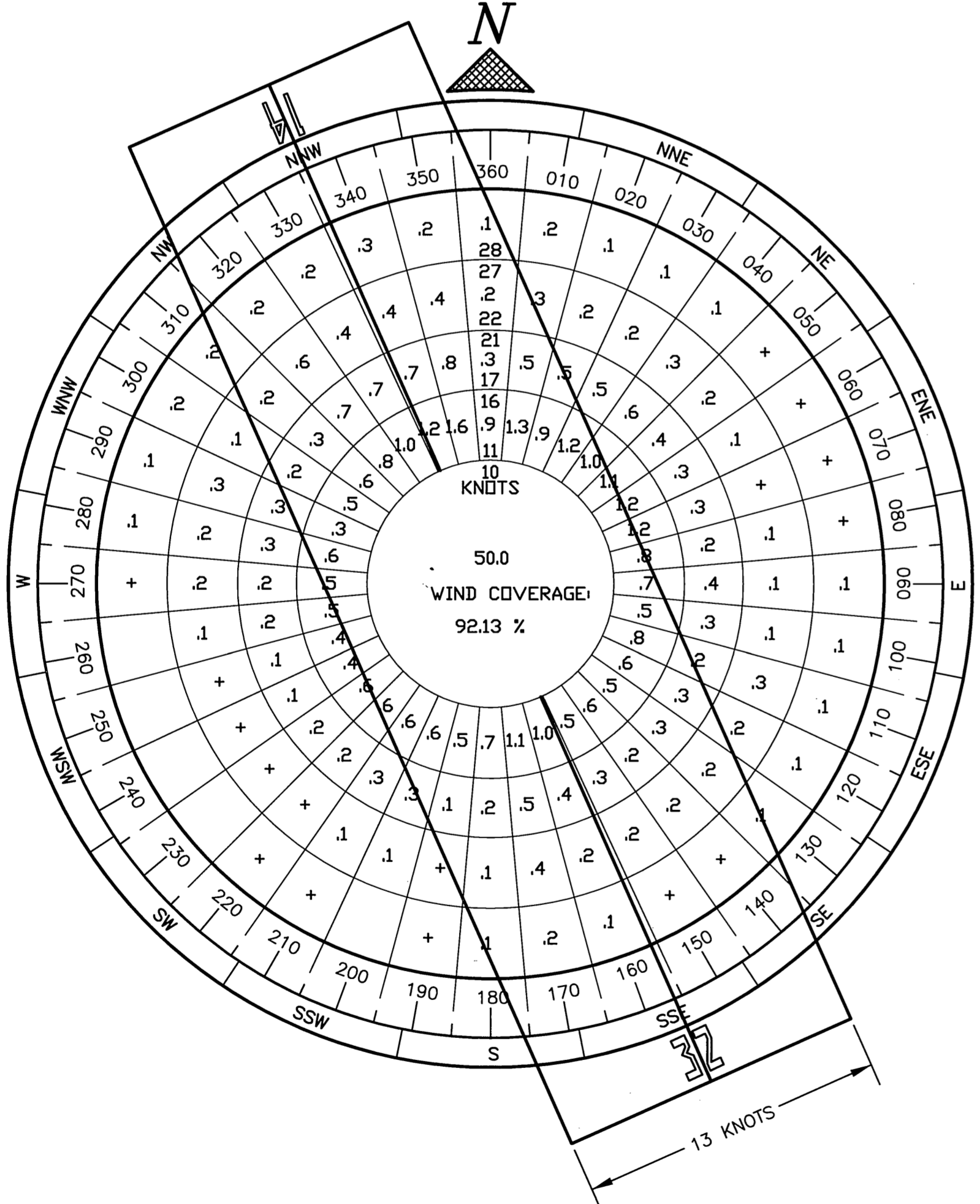
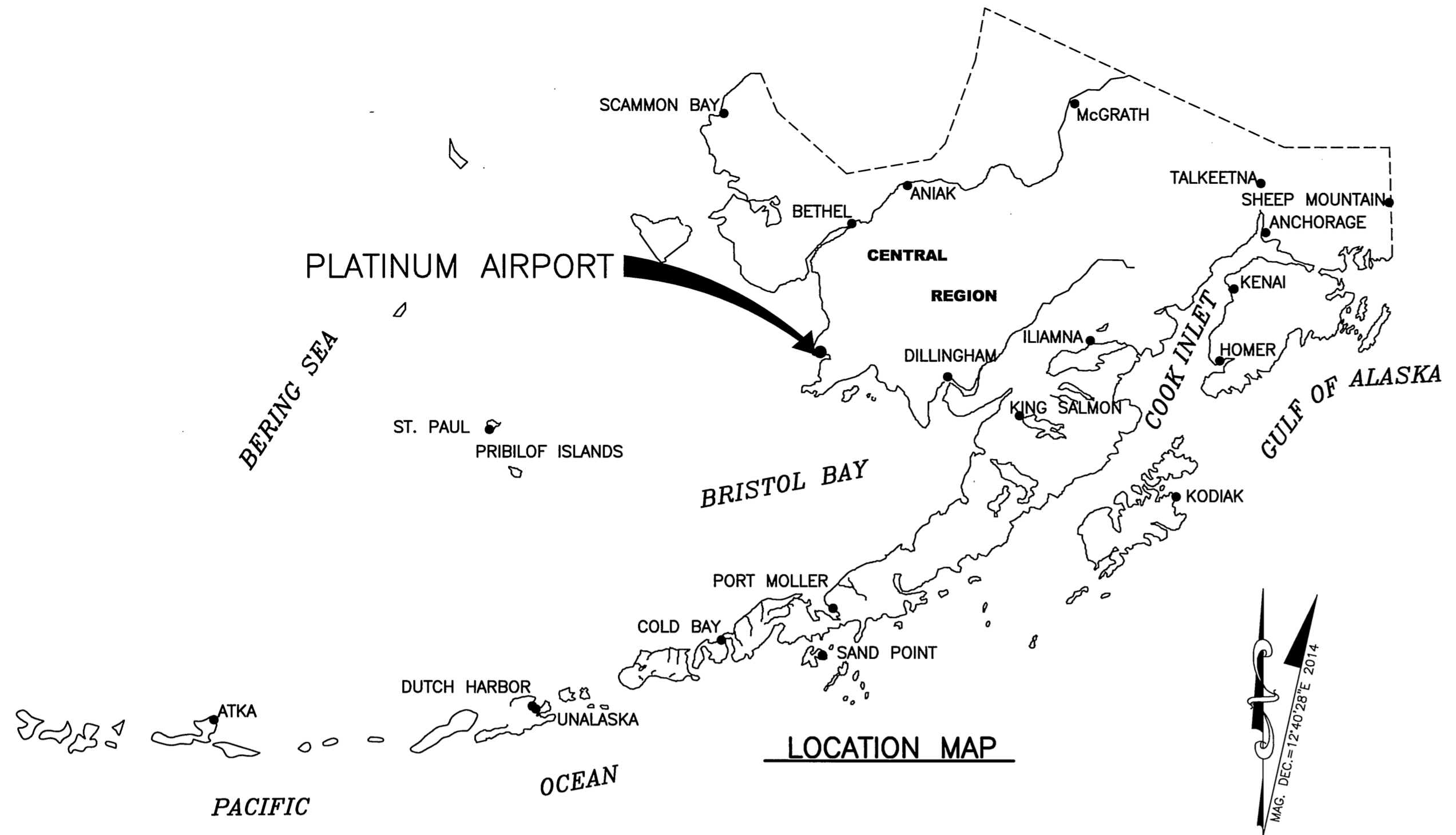

WIND DATA

WIND COVERAGE:	SPEED	R/W 14/32
	10.5 KNOTS	76.20%
	13 KNOTS	83.70%
	16 KNOTS	92.13%
	20 KNOTS	97.50%

SOURCE: DRYDEN INSTRUMENTATION ANCHORAGE, ALASKA

PERIOD: AUGUST 26, 1997 THRU SEPTEMBER 11, 1999 (17,908 OBSERVATIONS)

AIRPORT DATA TABLE

ITEM	EXISTING	ULTIMATE
ICAO IDENTIFIER		PAPM
NATIONAL AIRPORT IDENTIFIER		PTU
FAA SITE NUMBER		50598.*A
AIRPORT ELEVATION (MSL NAVD88)	18	18
AIRPORT REFERENCE POINT (ARP NAD 83)	LAT. 59°01'04.19"N LONG. 161°49'37.86"W	59°01'04.19"N 161°49'37.86"W
AIRPORT REFERENCE CODE	B II	B II
MEAN MAX. TEMPERATURE, HOTTEST MONTH	60 F JULY	60 F JULY
AIRPORT AND TERMINAL NAVIGATION AIDS	GPS	GPS
	ROTATING BEACON	ROTATING BEACON
TAXIWAY LIGHTING/MARKING	M. I. / NA	M. I. / NA
APRON LIGHTING/MARKING	NONE / NA	NONE / NA
RUNWAY OBSTRUCTION SURVEY SOURCE & TYPE	NONE	NVG
MAGNETIC DECLINATION, YEAR, RATE OF CHANGE	12°40'28"E, 2014, -0°13.3'(W)/YR	GA
NPIAS SERVICE LEVEL	GA	GA
STATE SERVICE ROLE		COMMUNITY

RUNWAY DATA TABLE

ITEM	RUNWAY 14/32	
	EXISTING	ULTIMATE
APPROACH SURFACES	20:1/20:1	20:1/20:1
VISIBILITY MINIMUM	1 SM	1 SM
INSTRUMENT RUNWAY	NPI/NPI	NPI/NPI
RUNWAY SURFACE	GRAVEL	GRAVEL
PAVEMENT STRENGTH	lbs. N/A	N/A
RUNWAY TYPE	UTILITY	UTILITY
RUNWAY DIMENSIONS	75x5000	75x5000
AIRCRAFT APPROACH CATEGORY	B / B	B / B
AIRCRAFT DESIGN GROUP	II / II	II / II
MEAN GEODETIC BEARING	N 25°09'25"W	N25°09'25"W
EFFECTIVE GRADE	0.04 %	0.04 %
TOUCHDOWN ELEVATION (MSL NAVD88)	17.5/17.5	17.5/17.5
RUNWAY END COORDINATES (N.A.D. 83)		
RUNWAY 14	LAT. 59°01'26.48"N LONG. 161°49'58.16"W	59°01'26.48"N 161°49'58.16"W
RUNWAY 32	LAT. 59°00'41.89"N LONG. 161°49'17.56"W	59°00'41.89"N 161°49'17.56"W
RUNWAY SAFETY AREA (RSA)	150x5600	150x5600
LENGTH BEYOND R/W END	300/300	300/300
RUNWAY PROTECTION ZONE (RPZ)	500x700x1000	500x700x1000
RUNWAY OBJECT FREE AREA (OFA)	500x5600	500x5600
LENGTH BEYOND R/W END	300/300	300/300
RUNWAY OBSTACLE FREE ZONE (OFZ)	250x5400	250x5400
RUNWAY LIGHTING	M.I.	M.I.
RUNWAY MARKING	N/A	N/A
RUNWAY VISUAL AND INSTRUMENT NAVAIDS	GPS	PAPI,REIL,GPS

NOTES
 1. HORIZONTAL DATUM BASED ON NAD83.
 2. THE DATUM FOR ELEVATIONS IS NAVD88, EXPRESSED IN FEET.

MODIFICATIONS TO STANDARDS TABLE

NO.	DESCRIPTION	FAA STANDARDS	RUNWAY 14/32	
			EXISTING	ULTIMATE
	NONE			

LEGEND

ITEM	EXISTING	ULTIMATE
AIRPORT REFERENCE POINT (ARP)	⊙	⊙
ANTENNA	⊙	⊙
BLUFF	—	—
BUILDINGS	▭	▭
BUILDING RESTRICTION LINE	---BRL---	---BRL---
FENCE	-X-X-X-	-X-X-X-
PAPI	□□□□	□□□□
AIRPORT PROPERTY BOUNDARY	---	---
AIRPORT PARCEL BOUNDARY	---	---
REIL	⊙	⊙
ROADWAYS	---	---
ROTATING BEACON	⊙	⊙
RUNWAY OBJECT FREE AREA	---OFA---	---OFA---
RUNWAY OBSTACLE FREE ZONE	---OFZ---	---OFZ---
RUNWAY PROTECTION ZONE	---RPZ---	---RPZ---
RUNWAY SAFETY AREA	---RSA---	---RSA---
SHORELINE	—	—
SURVEY MONUMENT	⊙	⊙
THRESHOLD MARKERS/LIGHTS	○○○○○○	○○○○○○
TOPOGRAPHIC CONTOURS	---100---	---100---
TREE (LARGE SINGLE)	⊙	⊙
TREELINE	—	—
VASI	□□	□□
WIND CONE	⊙	⊙
SEGMENTED CIRCLE	⊙	⊙
TIE DOWN	⊙	⊙

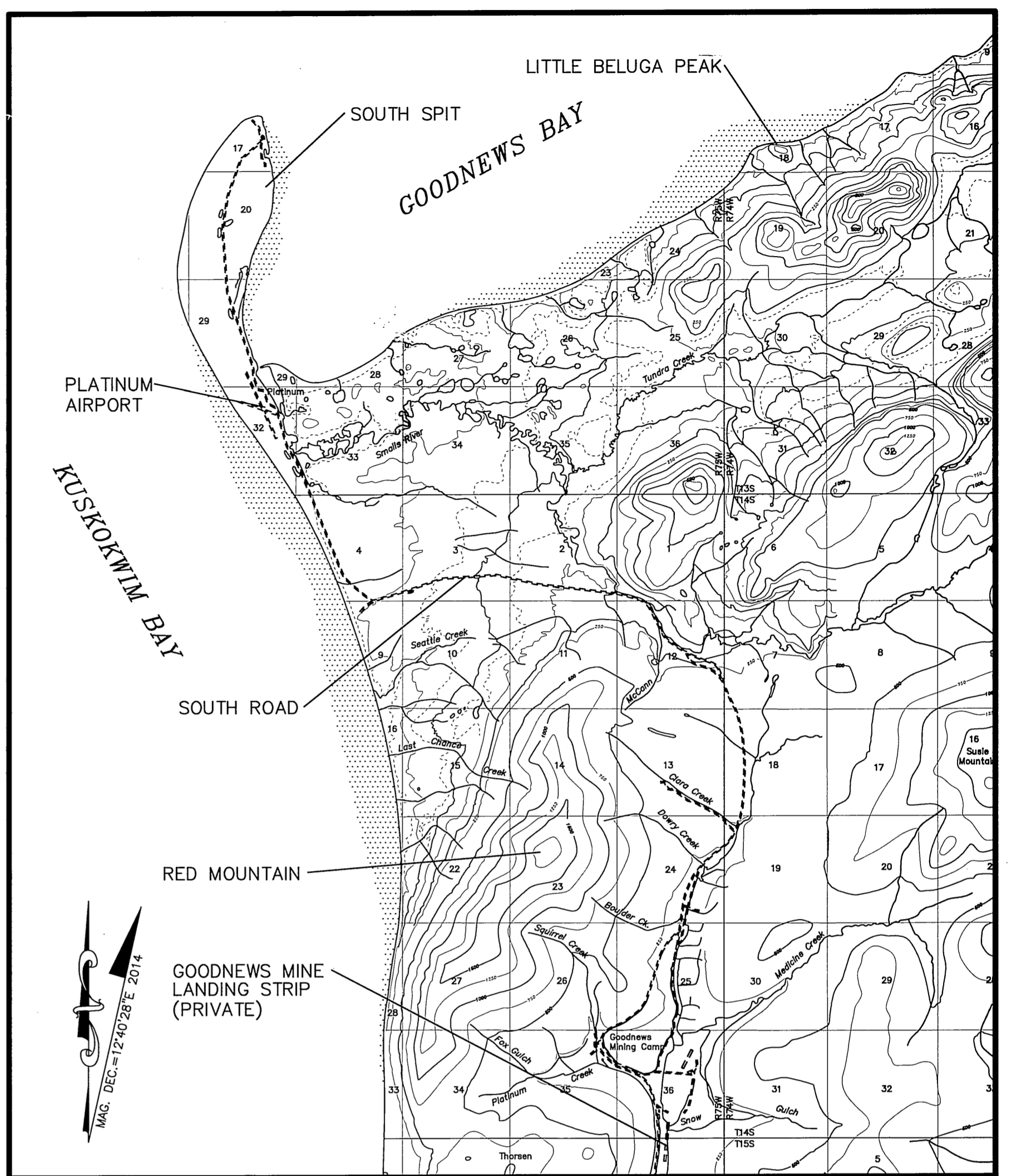

VICINITY MAP

1 MILE 0' 1 MILE 2 MILE

T 13 S. R 75 W. SEC. 29, 32
 SEWARD MERIDIAN
 U.S.G.S. GOODNEWS BAY (A-8, B-8), ALASKA

DRAWING INDEX

SHT #	TITLE
1	AIRPORT DATA
2	EXISTING PLAN
3	ULTIMATE PLAN
4	EXISTING INNER APPROACH SURFACE PLAN & PROFILE RUNWAY 32
5	EXISTING INNER APPROACH SURFACE PLAN & PROFILE RUNWAY 14
6	ULTIMATE INNER APPROACH SURFACE PLAN & PROFILE RUNWAY 32
7	ULTIMATE INNER APPROACH SURFACE PLAN & PROFILE RUNWAY 14
8	AIRPORT AIRSPACE
9	AIRPORT PROPERTY MAP

7/2015 AS-BUILT PER AKSAS 54774
 BY DATE REVISION

APPROVED: *[Signature]* DATE: 5/19/14
 KENNETH M. MORTON, P.E. PRECONSTRUCTION ENGINEER RECOMMENDED: DATE: 5-19-14
 WOLFGANG E. JUNGE, P.E. DESIGN SECTION CHIEF

AIRPORT LAYOUT PLAN CONDITIONAL APPROVAL SUBJECT TO ALP APPROVAL LETTER DATED 6/3/14
 FAA AIRSPACE REVIEW NUMBER: 2014-AAL-91-NAN
 AS-BUILT 7/2015
 DATE: 6/3/14
 FAA, AIRPORTS DIVISION ALASKAN REGION, AAL-612

**STATE OF ALASKA
 DEPARTMENT OF TRANSPORTATION
 AND PUBLIC FACILITIES
 CENTRAL REGION**

**PLATINUM AIRPORT
 PLATINUM, ALASKA
 AIRPORT LAYOUT PLAN**

DATE: 5/15/2014
 SHEET: 1 OF 9
 LOCATION MAP, VICINITY MAP, LEGEND AND INDEX

KUSKOKWIM BAY

Date Plotted: 7/10/2015, 12:59 PM
 Layout Name: W:\Projects\Platinum\Airport\layout.pln
 File Name: W:\Projects\Platinum\Airport\Drawings\EXISTING PLANS AND LAYOUTS.dwg
 Designed By: RMC
 Drawn By: RMC
 Checked By: JRB

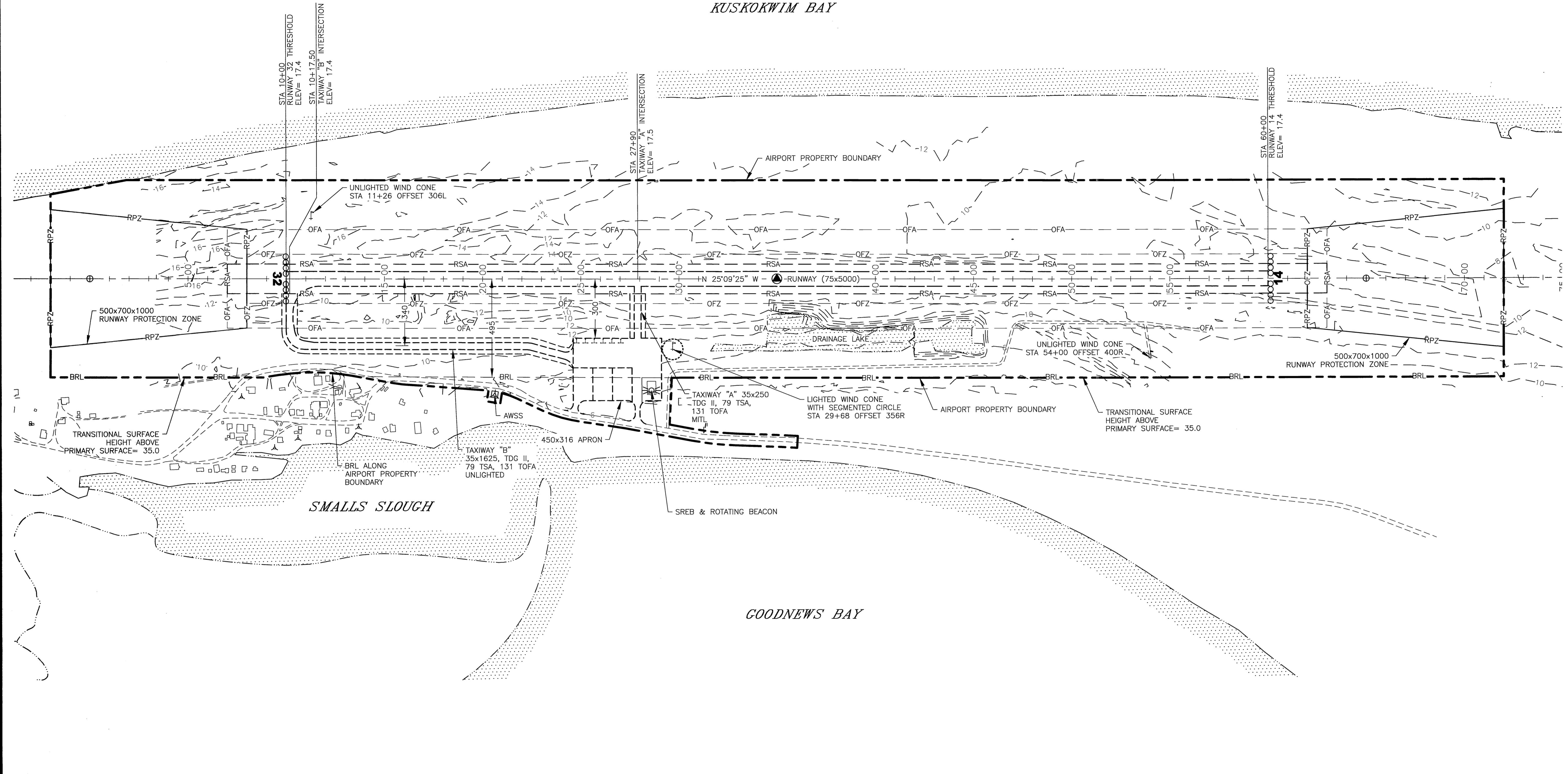

SMALLS SLOUGH

GOODNEWS BAY

BUILDING DATA TABLE				
ID	DESCRIPTION	STATION/OFFSET	TOP ELEVATION	OBSTRUCTION MARKING
1	SREB	28+60 518R	35.9	NONE
2	AWSS	20+61 581R	34.8	YES

*STATION/OFFSET MEASURED AT THE CENTER OF THE BUILDING EDGE CLOSEST TO THE RUNWAY

NOTE:
1. NO OFZ OBSTRUCTIONS.

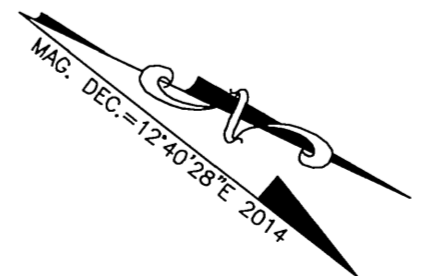

BY	DATE	REVISION

STATE OF ALASKA
DEPARTMENT OF TRANSPORTATION
AND PUBLIC FACILITIES
CENTRAL REGION

PLATINUM AIRPORT
PLATINUM, ALASKA
AIRPORT LAYOUT PLAN

EXISTING PLAN

DATE: 7/10/2015
SHEET: 2 OF 9

Date Plotted: 7/10/2015, 1:55 PM
 Layout Name: U:\Projects\Platinum\Airport_Layou\pln.dwg
 File Name: U:\Projects\Platinum\Airport_Layou\pln.dwg
 Designed By: PWC
 Drawn By: RRG
 Checked By: JNB

KUSKOKWIM BAY

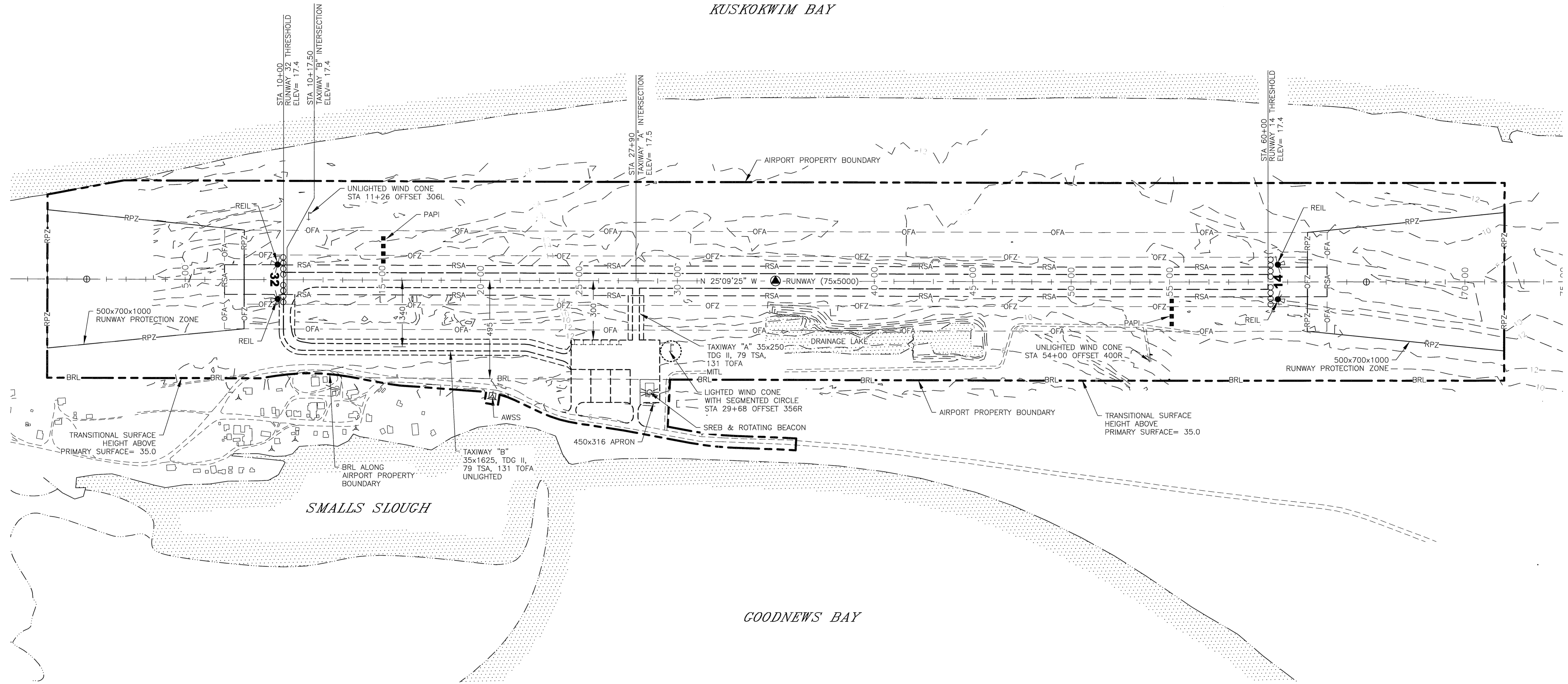

BUILDING DATA TABLE				
ID	DESCRIPTION	STATION/OFFSET	TOP ELEVATION	OBSTRUCTION MARKING
1	SREB	28+60 518R	35.9	NONE
2	AWSS	20+61 581R	34.8	YES

*STATION/OFFSET MEASURED AT THE CENTER OF THE BUILDING EDGE CLOSEST TO THE RUNWAY

NOTE:

- NO OFZ OBSTRUCTIONS.

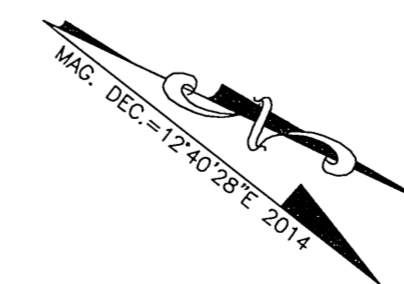

NO.	DATE	BY	REVISION

STATE OF ALASKA
DEPARTMENT OF TRANSPORTATION
AND PUBLIC FACILITIES
CENTRAL REGION

PLATINUM AIRPORT
 PLATINUM, ALASKA
 AIRPORT LAYOUT PLAN
 ULTIMATE PLAN

DATE:
 7/10/2015
 SHEET:
 3 OF
 9

7/2015 AS-BUILT PER AKSAS 54774
 BY DATE REVISION

Date Plotted: 7/10/2015, 1:56 PM
 Design: FWC
 Layout Name: EXISTING INNER APPROACH 32
 Drawn By: REG
 File Name: W:\Projects\PlatinumAirport\layout.pln\1.plt
 5-2015\Final Drawings\EXISTING PLANS AND LAYOUTS.dwg
 Checked By: JRB

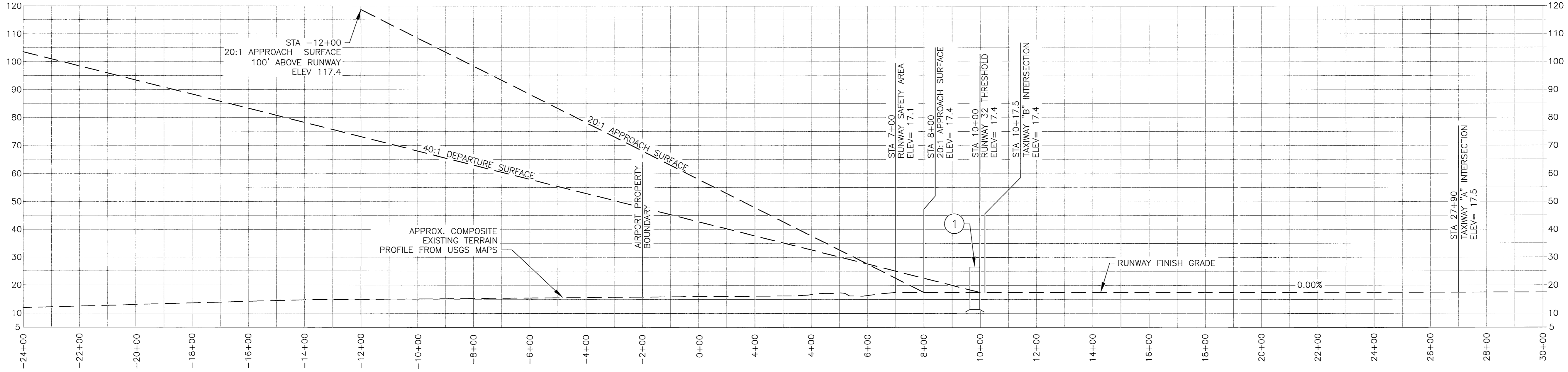
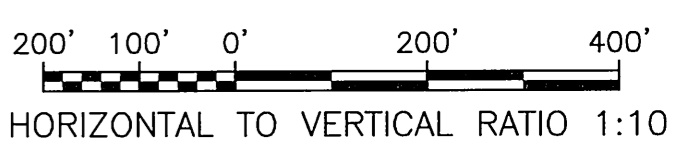
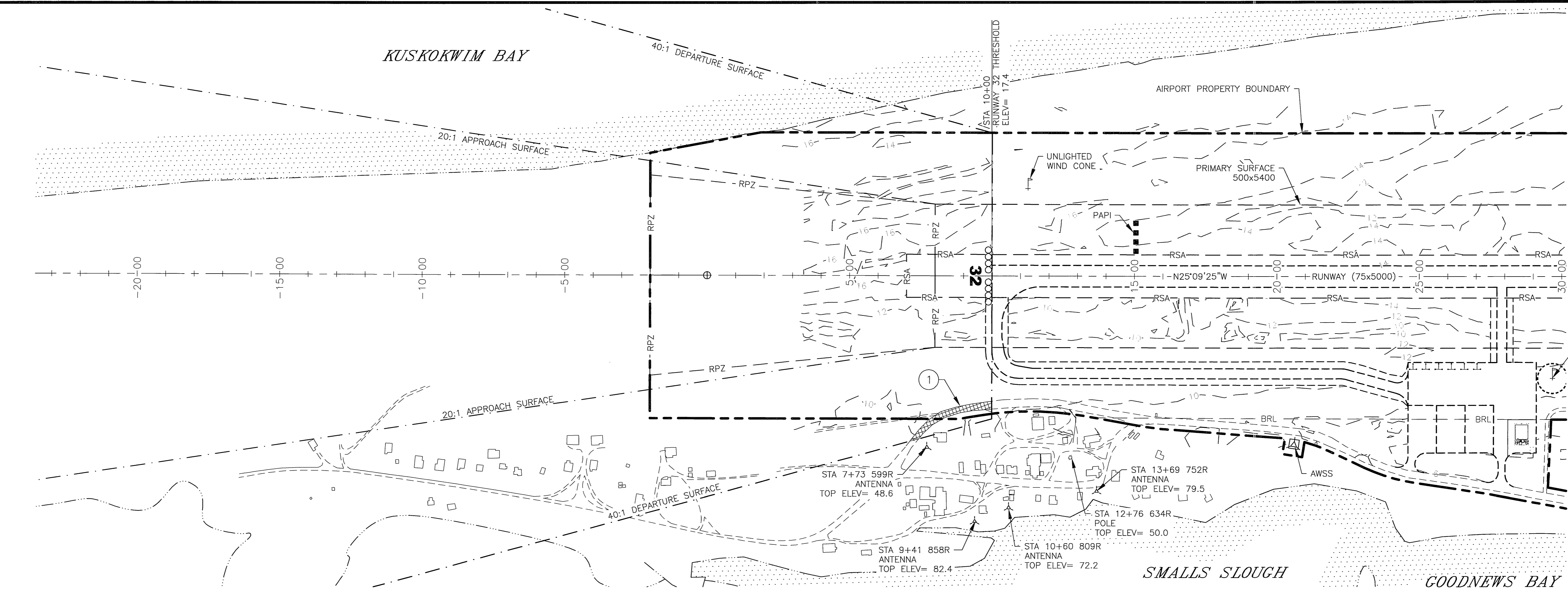

NOTES:
 1. THERE ARE NO F.A.R. PART 77 IMAGINARY SURFACE OBSTRUCTIONS FOR RUNWAY 14/32. THEREFORE THE OBSTRUCTION CLEARANCE SLOPE IS ESTABLISHED AS 20:1 PER FAA AC 150/5200-35A, CHAPTER 4, DATA ELEMENT 57.
 2. DEPARTURE SURFACE AS DEFINED BY AC 150/5300-13A, TABLE 3-2, LINE 9.
 3. NO THRESHOLD SITING SURFACE PENETRATIONS. THRESHOLD SITING CRITERIA IS BASED ON FAA AC 150/5300-13A, TABLE 3-2, LINES 6 AND 9.

40:1 DEPARTURE SURFACE PENETRATIONS (RW 14)

OBSTRUCTION ID	DESCRIPTION	OBSTRUCTION DIST/OFFSET	OBSTRUCTION ELEVATION	SURFACE PENETRATED	SURFACE ELEVATION	AMOUNT OF PENETRATION	DISPOSITION	STAGE TO BE CORRECTED
1	ROAD+15	7+28/574R TO 10+00/452R	26.5 MAX (EST)	DEPARTURE	17.4 MIN	9.1 MAX (EST)	NONE	N/A

PART 77 SURFACE OBSTRUCTION (INNER PORTION RUNWAY 32)

OBSTRUCTION ID	DESCRIPTION	OBSTRUCTION DIST/OFFSET	OBSTRUCTION ELEVATION	SURFACE PENETRATED	SURFACE ELEVATION	AMOUNT OF PENETRATION	DISPOSITION	STAGE TO BE CORRECTED
	NONE							

DATE	REVISION
7/2015	AS-BUILT PER AKSAS 54774

STATE OF ALASKA
DEPARTMENT OF TRANSPORTATION
AND PUBLIC FACILITIES
CENTRAL REGION

PLATINUM AIRPORT
 PLATINUM, ALASKA
 AIRPORT LAYOUT PLAN

EXISTING INNER APPROACH SURFACE
 PLAN & PROFILE RUNWAY 32

DATE: 7/10/2015	SHEET: 4 OF 9
--------------------	------------------

Date Plotted: 7/10/2015 1:58 PM
 Layout Name: EXISTING INNER APPROACH 14
 File Name: H:\Projects\PlatinumAirport\Layout\Plum.dwg
 Drawn By: RMC
 Checked By: JRD

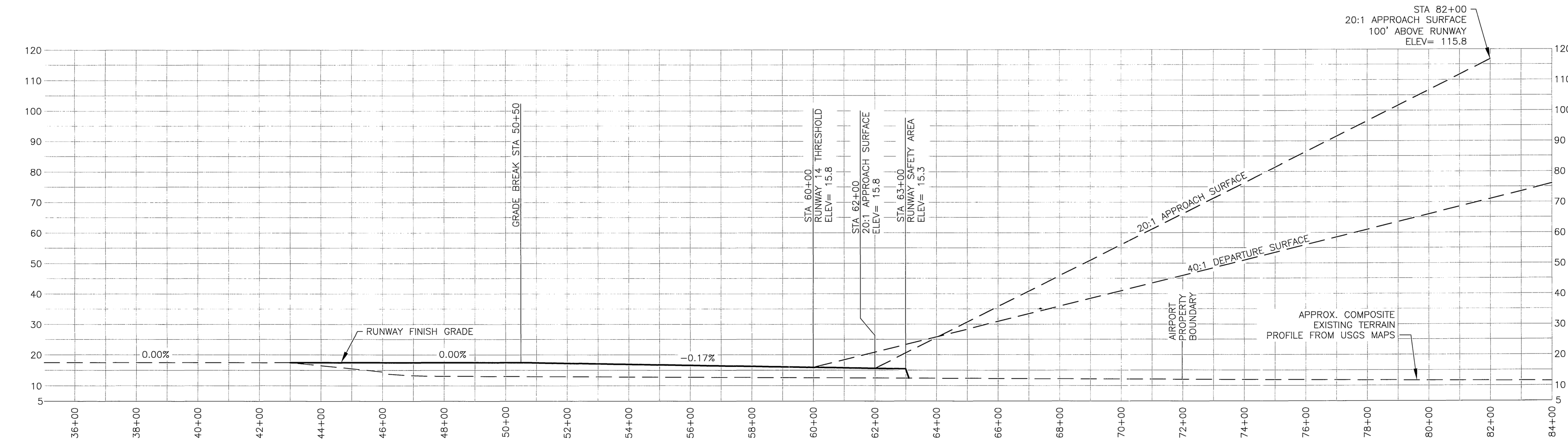
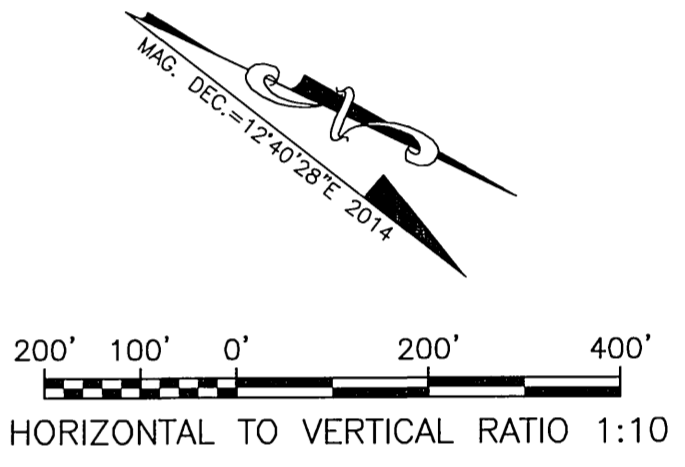
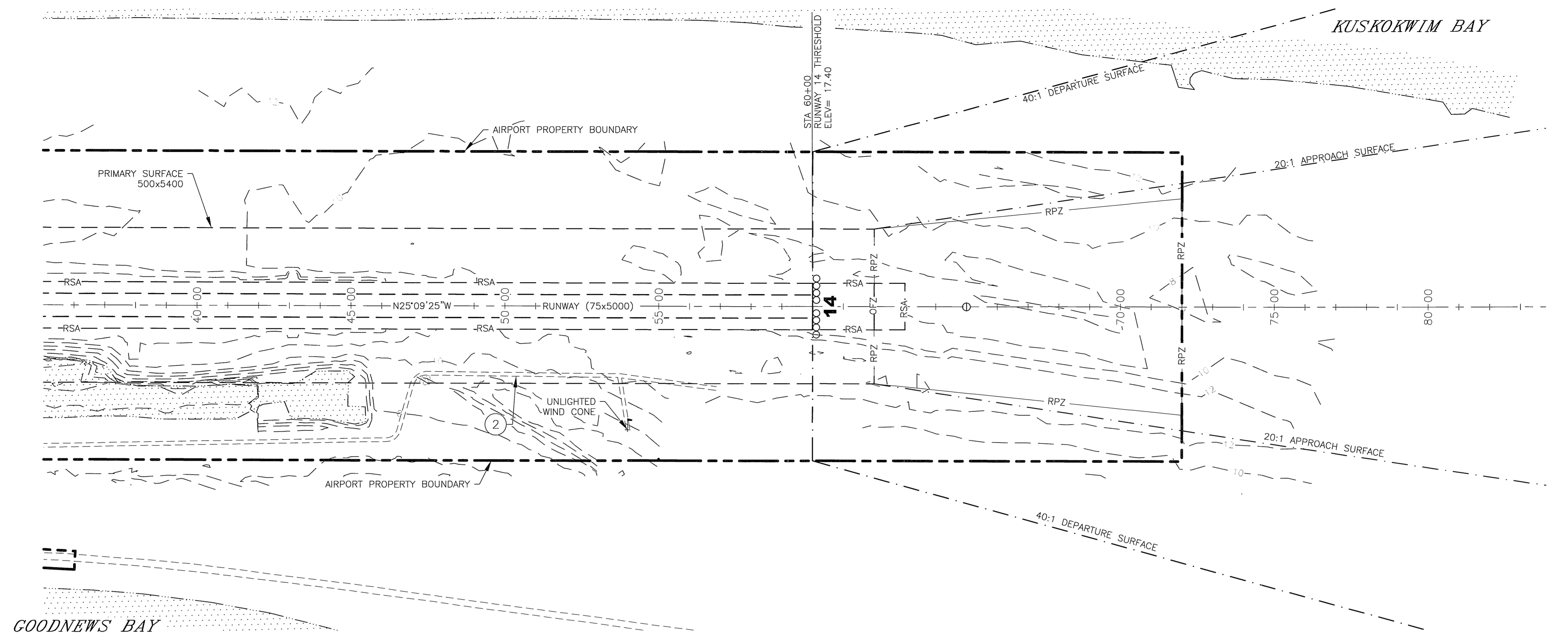

- NOTES:
- THERE ARE NO F.A.R. PART 77 IMAGINARY SURFACE OBSTRUCTIONS FOR RUNWAY 14/32. THEREFORE THE OBSTRUCTION CLEARANCE SLOPE IS ESTABLISHED AS 20:1 PER FAA AC 150/5200-35A, CHAPTER 4, DATA ELEMENT 57.
 - NO DEPARTURE SURFACE PENETRATIONS.
 - NO THRESHOLD SITING SURFACE PENETRATIONS. THRESHOLD SITING CRITERIA IS BASED ON FAA AC 150/5300-13A, TABLE 3-2, LINES 6 AND 9.

PART 77 SURFACE OBSTRUCTION TABLE (INNER PORTION OF RUNWAY 14)							
OBSTRUCTION ID	DESCRIPTION	OBSTRUCTION DIST/OFFSET	OBSTRUCTION ELEVATION	SURFACE PENETRATED	SURFACE ELEVATION	AMOUNT OF PENETRATION	STAGE TO BE CORRECTED
2	ROAD	46+93/209R	25.0 (EST)	OFZ	17.5 MIN	7.5 MAX	N/A
		TO					
		56+13/209R					

BY	DATE	REVISION

STATE OF ALASKA
DEPARTMENT OF TRANSPORTATION
AND PUBLIC FACILITIES
CENTRAL REGION

PLATINUM AIRPORT
 PLATINUM, ALASKA
 AIRPORT LAYOUT PLAN

EXISTING INNER APPROACH SURFACE
 PLAN & PROFILE RUNWAY 14

DATE: 7/10/2015
 SHEET: 5 OF 9

7/2015 AS-BUILT PER AKSAS 54774
 BY DATE REVISION

Date Plotted: 7/10/2015, 1:03 PM
 Layout Name: U:\Inner Approach.rw 32
 File Name: M:\Projects\PlatinumAirport_Layout\plan\p_5-2015\final_drawing\UltimatePlan.dwg
 Designed By: PWC
 Drawn By: PRC
 Checked By: JNB

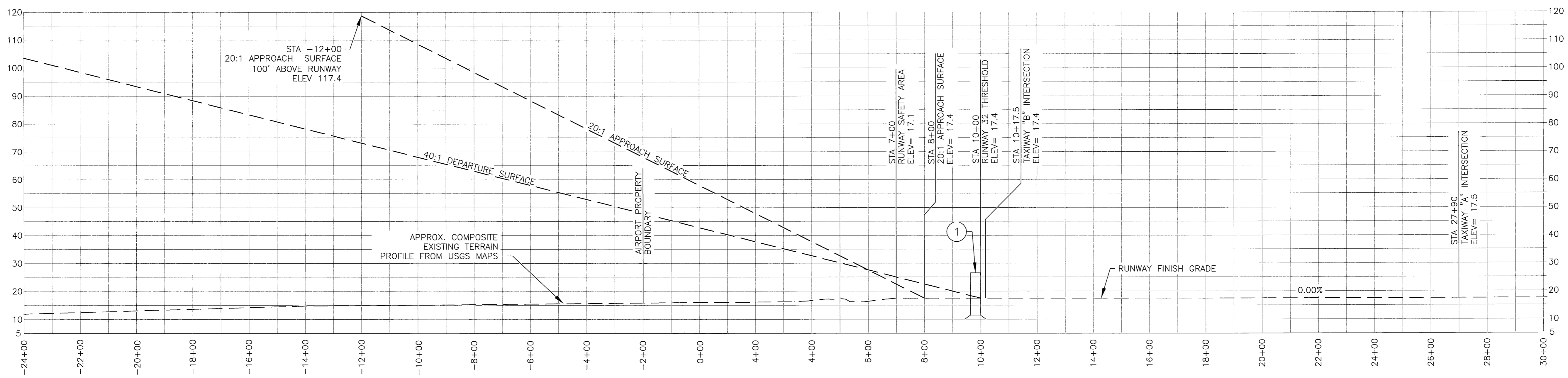
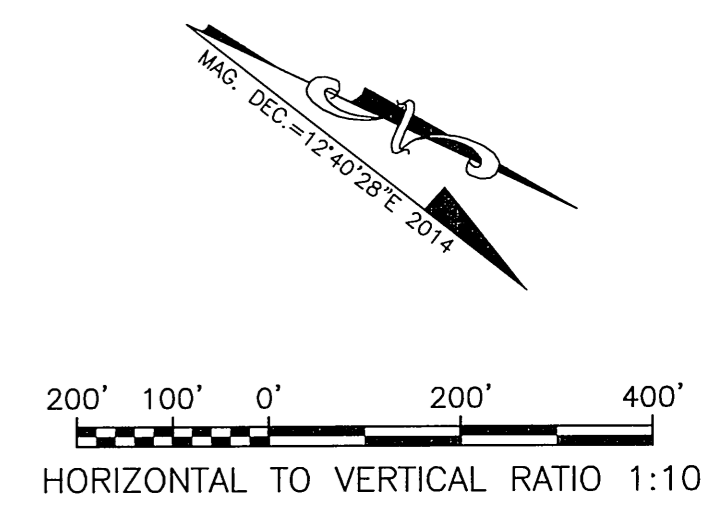
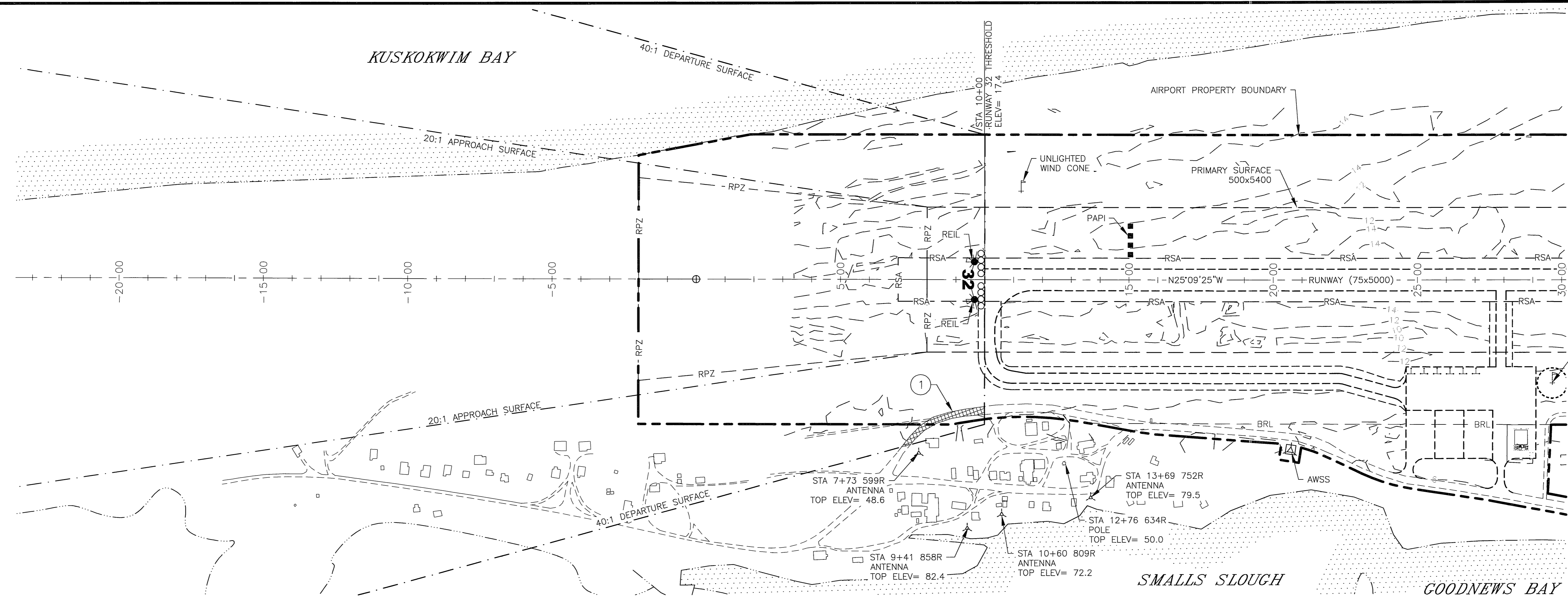

- NOTES:
1. THERE ARE NO F.A.R. PART 77 IMAGINARY SURFACE OBSTRUCTIONS FOR RUNWAY 14/32. THEREFORE THE OBSTRUCTION CLEARANCE SLOPE IS ESTABLISHED AS 20:1 PER FAA AC 150/5200-35A, CHAPTER 4, DATA ELEMENT 57.
 2. DEPARTURE SURFACE AS DEFINED BY AC 150/5300-13A, TABLE 3-2, LINE 9.
 3. NO THRESHOLD SITING SURFACE PENETRATIONS. THRESHOLD SITING CRITERIA IS BASED ON FAA AC 150/5300-13A, TABLE 3-2, LINES 6 AND 9.

OBSTRUCTION ID	DESCRIPTION	OBSTRUCTION DIST/OFFSET	OBSTRUCTION ELEVATION	SURFACE PENETRATED	SURFACE ELEVATION	AMOUNT OF PENETRATION	DISPOSITION	STAGE TO BE CORRECTED
1	ROAD+15	7+28/574R TO 10+00/452R	26.5 MAX (EST)	DEPARTURE	17.4 MIN	9.1 MAX (EST)	NONE	N/A

OBSTRUCTION ID	DESCRIPTION	OBSTRUCTION DIST/OFFSET	OBSTRUCTION ELEVATION	SURFACE PENETRATED	SURFACE ELEVATION	AMOUNT OF PENETRATION	DISPOSITION	STAGE TO BE CORRECTED
	NONE							

BY	DATE	REVISION
	7/2015	AS-BUILT PER AKSAS 54774

STATE OF ALASKA
DEPARTMENT OF TRANSPORTATION
AND PUBLIC FACILITIES
CENTRAL REGION

PLATINUM AIRPORT
 PLATINUM, ALASKA
 AIRPORT LAYOUT PLAN

ULTIMATE INNER APPROACH SURFACE
 PLAN & PROFILE RUNWAY 32

DATE: 7/10/2015
 SHEET: 6 OF 9

Date Plotted: 7/10/2015, 1:04 PM
 UCL Irmer: Approach RW 14
 Layout Name: R:\Projects\Platinum\Airport\Part1_Layout.plt
 File Name: R:\Projects\Platinum\Airport\Part1_Layout.dwg
 Designed By: PWC
 Drawn By: RRG
 Checked By: JRB

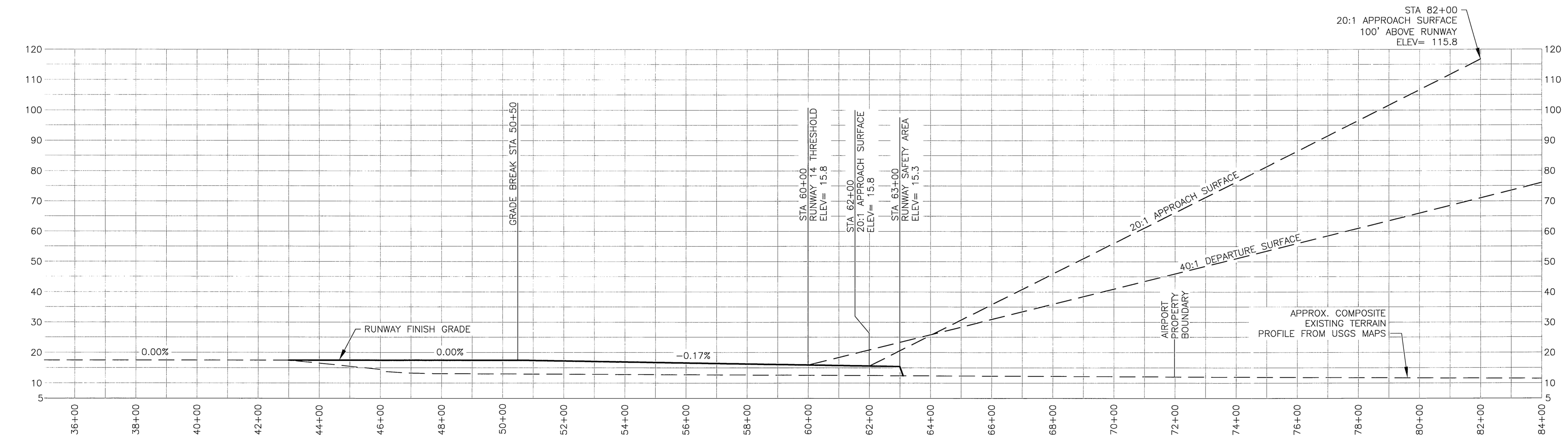
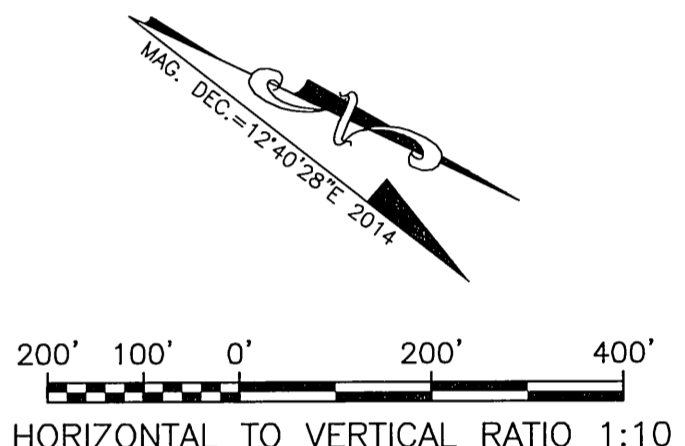
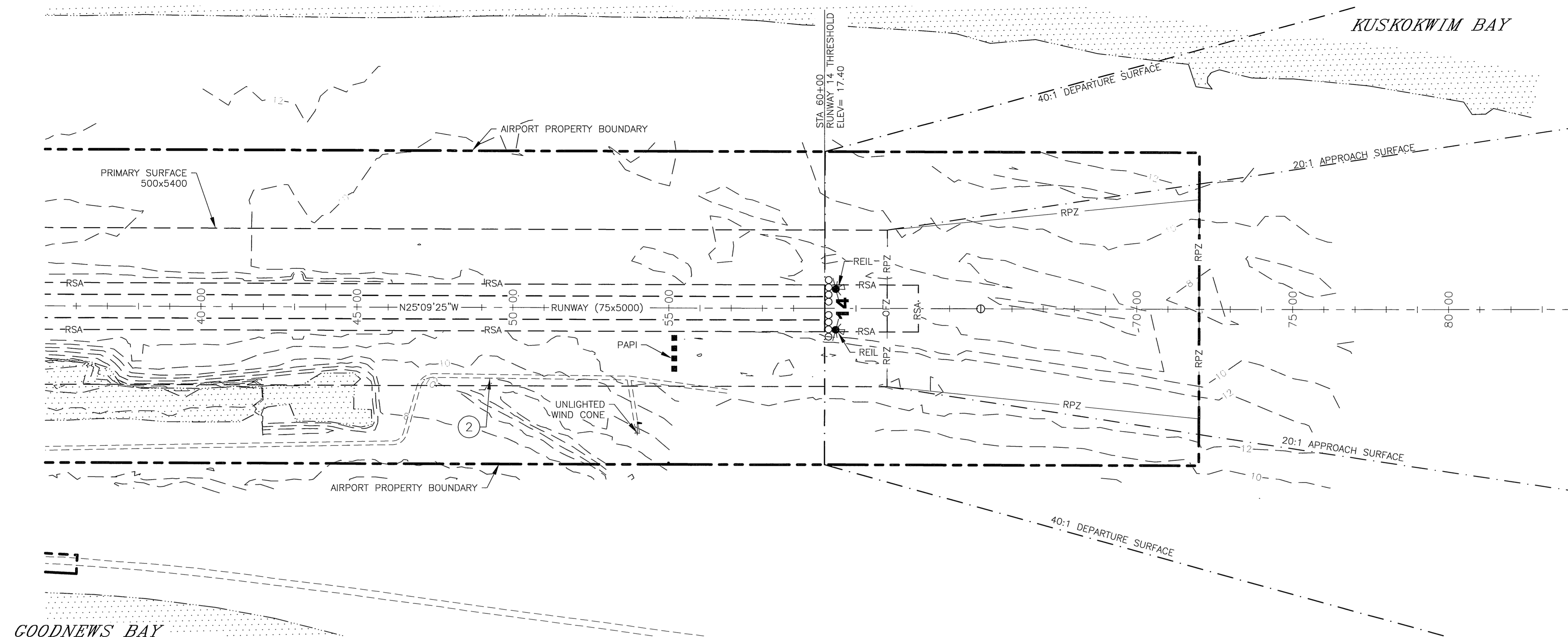

- NOTES:
- THERE ARE NO F.A.R. PART 77 IMAGINARY SURFACE OBSTRUCTIONS FOR RUNWAY 14/32. THEREFORE THE OBSTRUCTION CLEARANCE SLOPE IS ESTABLISHED AS 20:1 PER FAA AC 150/5200-35A, CHAPTER 4, DATA ELEMENT 57.
 - NO DEPARTURE SURFACE PENETRATIONS.
 - NO THRESHOLD SITING SURFACE PENETRATIONS. THRESHOLD SITING CRITERIA IS BASED ON FAA AC 150/5300-13A, TABLE 3-2, LINES 6 AND 9.

OBSTRUCTION ID	DESCRIPTION	OBSTRUCTION DIST/OFFSET	OBSTRUCTION ELEVATION	SURFACE PENETRATED	SURFACE ELEVATION	AMOUNT OF PENETRATION	DISPOSITION	STAGE TO BE CORRECTED
2	ROAD	46+93/209R TO 56+13/209R	25.0 (EST)	OFZ	17.5 MIN	7.5 MAX	TO REMAIN	N/A

NO.	DATE	REVISION

STATE OF ALASKA
DEPARTMENT OF TRANSPORTATION
AND PUBLIC FACILITIES
CENTRAL REGION

PLATINUM AIRPORT
 PLATINUM, ALASKA
 AIRPORT LAYOUT PLAN

ULTIMATE INNER APPROACH SURFACE
 PLAN & PROFILE RUNWAY 14

DATE: 7/10/2015
 SHEET: 7 OF 9

KUSKOKWIM BAY

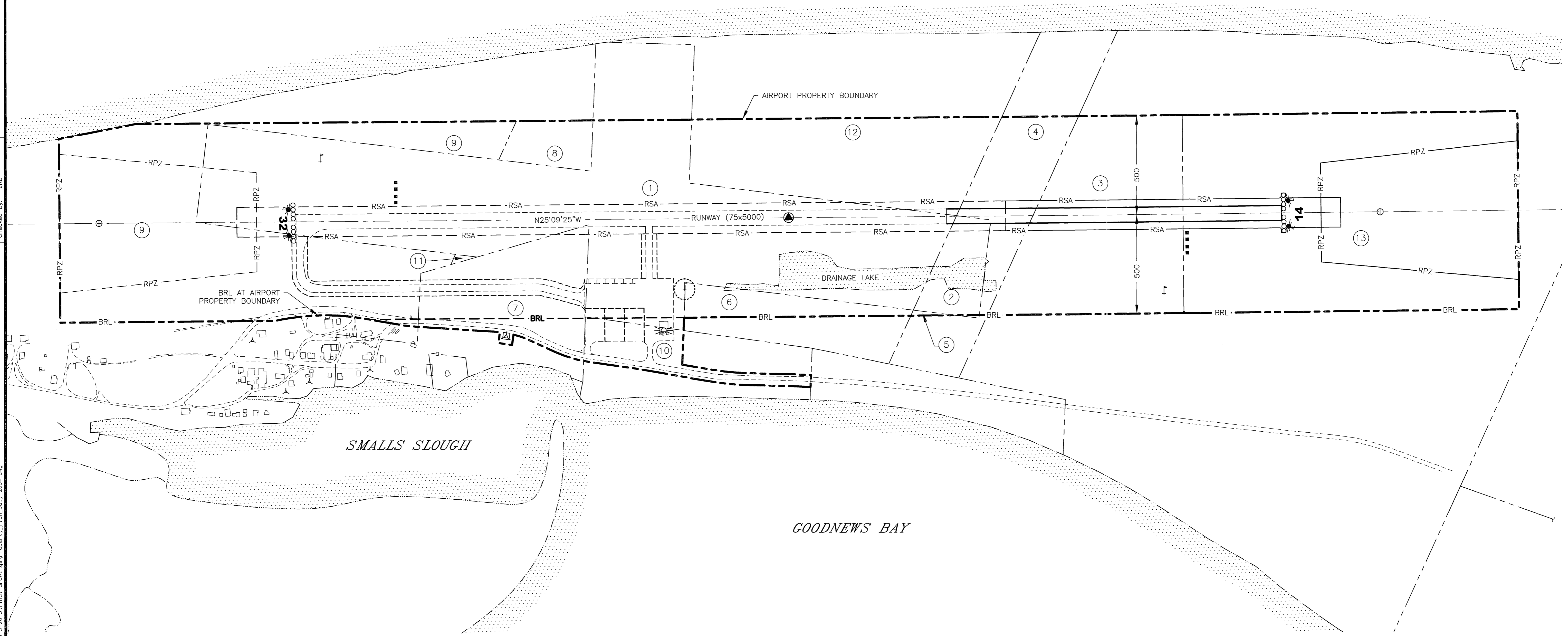

PROPERTY STATUS

Parcel Number	DOT & PF interest	Grantor	Grantee	Area	Recorded Document Number	Date Aquired	Acquired Under A.I.P. No.
1	FEE	ARVIQ Inc. (Surface) Calista Corp. (Subsurface)	STATE OF ALASKA, DOT&PF	47.562 AC	2007-000474-0 2007-000475-0	April 23, 2007	3-02-0224-002-2009
2	FEE	ARVIQ Inc. (Surface) Calista Corp. (Subsurface)	STATE OF ALASKA, DOT&PF	2.913 AC	2007-000474-0 2007-000475-0	April 23, 2007	3-02-0224-002-2009
3	FEE	Helen Kilbuck	STATE OF ALASKA, DOT&PF	17.478 AC	2008-000407-0	April 11, 2008	3-02-0224-002-2009
4	FEE			5.956 AC			
5	FEE	ARVIQ Inc. Surface Calista Corp. Subsurface	STATE OF ALASKA, DOT&PF	0.069 AC	2007-000474-0 2007-000475-0	April 23, 2007	3-02-0224-002-2009
6	FEE			2.724 AC			
7	FEE	Bethel Marina, INC	STATE OF ALASKA, DOT&PF	8.807 AC	2007-001136-0	August 29, 2007	3-02-0224-002-2009
8	FEE	ARVIQ Inc. (Surface) Calista Corp. (Subsurface)	STATE OF ALASKA, DOT&PF	2.259 AC	2007-000474-0 2007-000475-0	April 23, 2007	3-02-0224-002-2009
9	FEE	ARVIQ Inc. (Surface) Calista Corp. (Subsurface) John E. Nelson	STATE OF ALASKA, DOT&PF	31.166 AC	2007-001136-0 2013-000180-0	April 23, 2007 February 25, 2013	3-02-0224-002-2009

PROPERTY STATUS

Parcel Number	DOT & PF interest	Grantor	Grantee	Area	Recorded Document Number	Date Aquired	Acquired Under A.I.P. No.
10	FEE	Bethel Marina, INC John E. Nelson	STATE OF ALASKA, DOT&PF	3.507 AC	2007-001136-0 2013-000181-0	August 29, 2007 February 25, 2013	3-02-0224-002-2009
11	FEE	ARVIQ Inc. (Surface) Calista Corp. (Subsurface)	STATE OF ALASKA, DOT&PF	0.068 AC	2007-000474-0 2007-000475-0	April 23, 2007	3-02-0224-002-2009
12	FEE			14.000 AC			
13	FEE	Coastal Villages Region Fund	STATE OF ALASKA, DOT&PF	39.027 AC	2013-001110-0	October 4, 2013	3-02-0224-002-2009

RECORDING DISTRICT: BETHEL

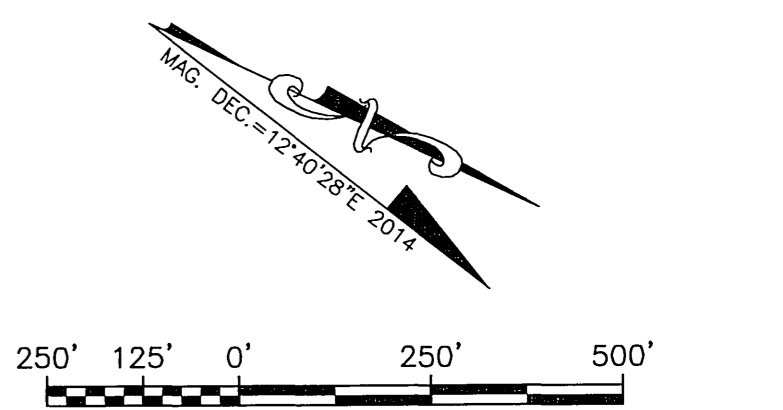

Date Plotted: 7/10/2015, 1:05 PM
 Layout Name: Layout1
 File Name: W:\Projects\PlatinumAirport_Layout\plan\p_5-2015\Final_drawings\Property_Plan_July_2014.dwg

BY	DATE	REVISION

STATE OF ALASKA
DEPARTMENT OF TRANSPORTATION
AND PUBLIC FACILITIES
CENTRAL REGION

PLATINUM AIRPORT
PLATINUM, ALASKA
AIRPORT LAYOUT PLAN
AIRPORT PROPERTY MAP

DATE:
7/10/2015
SHEET:
9
OF
9